

**PNP**

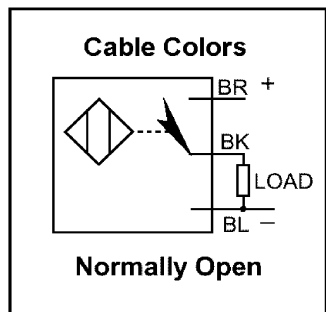

Sensor Pin Out (Typical)  
See Note 1

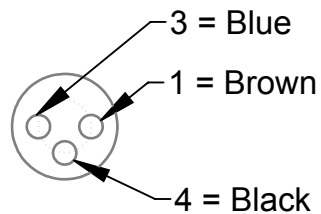

End View of Male  
8mm Sensor Connector (Typical)  
See Note 1

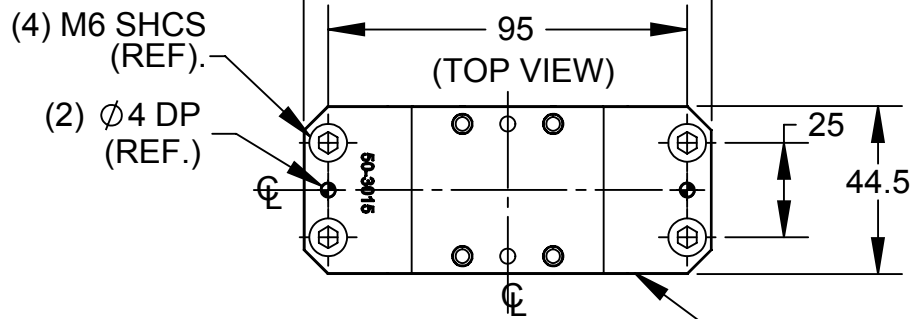
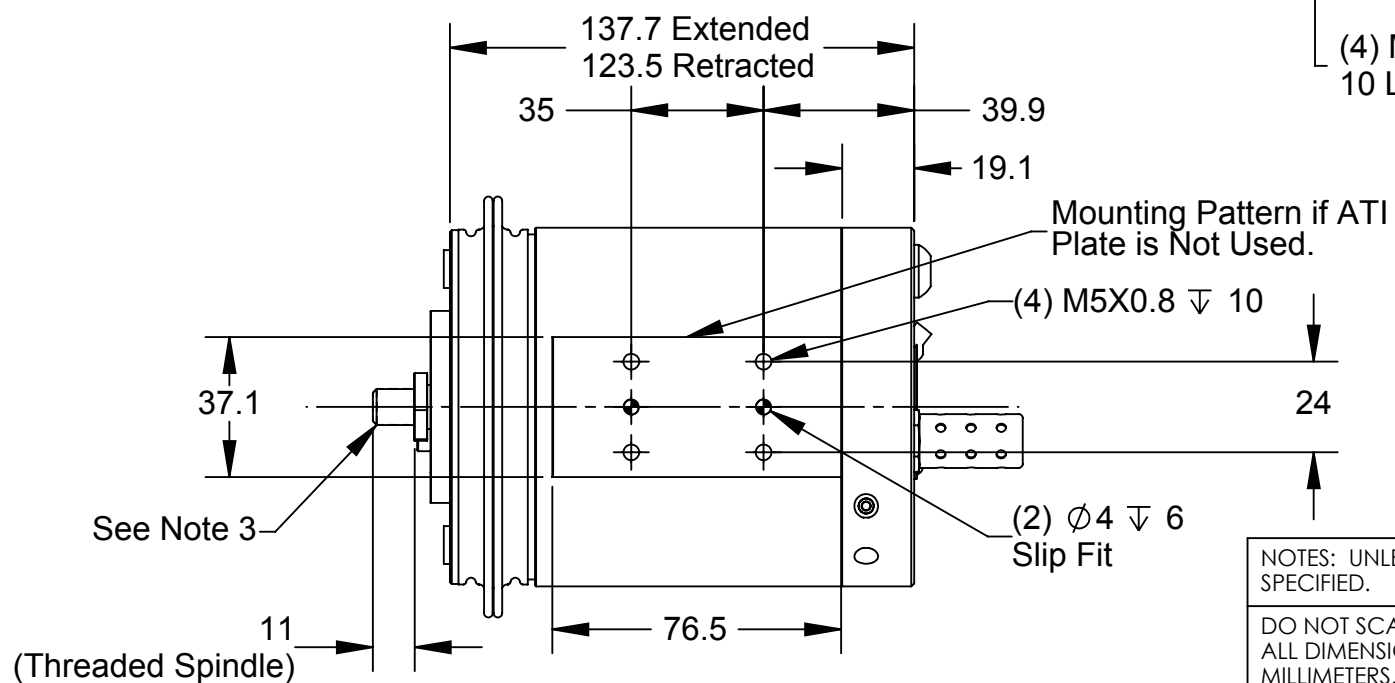
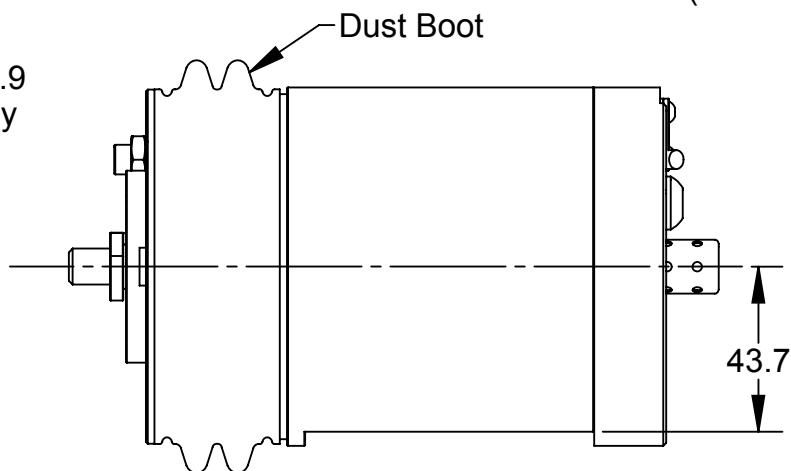
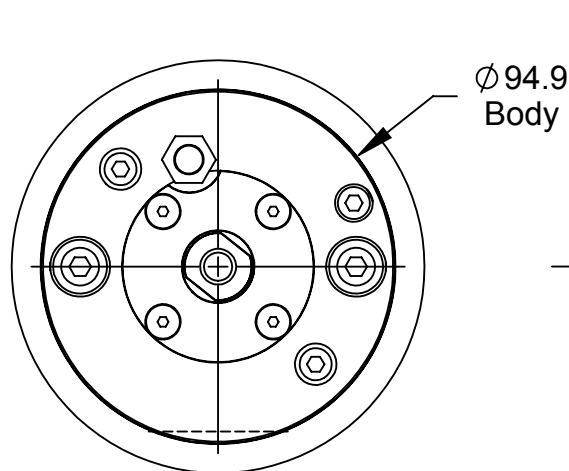

9005-50-1003  
Optional Mounting Plate  
(Supplied with Fasteners)

1/4 NPT Motor Air Supply Port  
Exhaust Port with Muffler  
(Positions Vary by Installation)

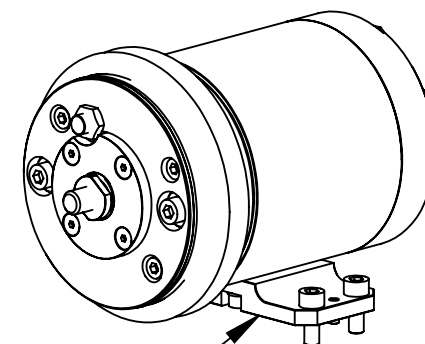
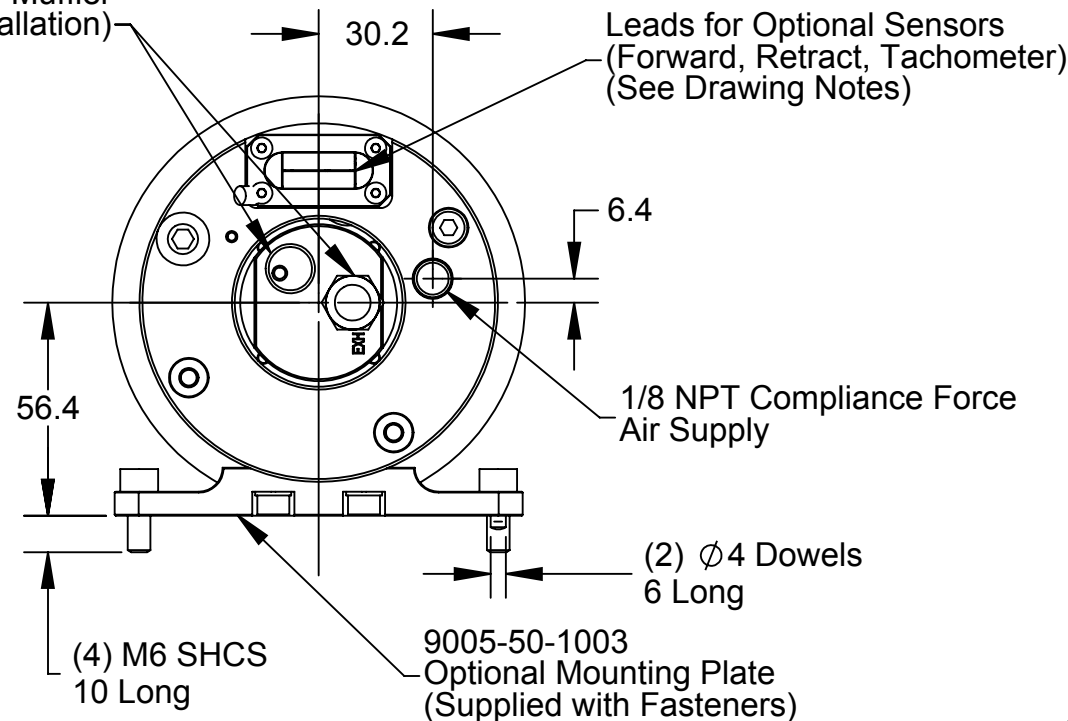

Optional Mounting Plate

Rev.	Description	Initiator	Date
02	Eco 10347; Sht 2, Option-R, 8590-9909999-138 was 8590-9909999-71	LJH	11/8/2012
03	Eco 14674; Sht 3, change 3490-0001033-01 to 3490-0001054-01	LJH	12/28/2016
04	Eco 176662; Removed Tachometer Disk and removed references to tachometer.	LJH	2/4/2019
05	ECO 19185; Updated to remove "Lube Free" from BOM.	NWB	6/25/2020

- NOTES:**
- 1) All Sensors are Optional.
  - 2) All Sensors are PNP (Sourcing), 3-Wire Proximity Switch Devices (10-30 VDC)
  - 3) The Motor Spindle is Right-Hand Threaded 3/8-24 (UNF) Suitable for Custom Media Holders.
  - 4) Chuck Keys and/or Wrenches are Supplied as Appropriate.

NOTES: UNLESS OTHERWISE SPECIFIED.

DO NOT SCALE DRAWING. ALL DIMENSIONS ARE IN MILLIMETERS.

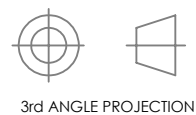

1031 Goodworth Drive, Apex, NC 27539, USA  
Tel: +1.919.772.0115 Email: info@ati-ia.com  
Fax: +1.919.772.8259 www.ati-ia.com  
ISO 9001 Registered Company

PROPERTY OF ATI INDUSTRIAL AUTOMATION, INC. NOT TO BE REPRODUCED IN ANY MANNER EXCEPT ON ORDER OR WITH PRIOR WRITTEN AUTHORIZATION OF ATI.

DRAWN BY: D.Lawson-5/24/12		TITLE	
CHECKED BY: D.Swanson-5/30/12		ACT-390 Series Customer Drawing	
PROJECT # 040907-1	SHEET 1 OF 3	SCALE 1:2	SIZE B
		DRAWING NUMBER	REVISION
		9630-50-ACT-390 Series	05

9005-50-1077

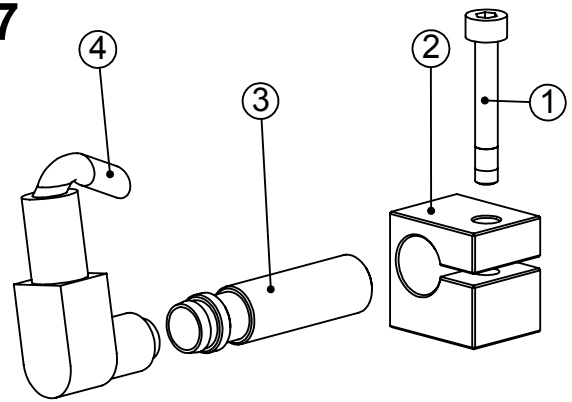

Loctite 222  
Contact + 1/4 Turn

## OPTION - F FORWARD SENSOR OPTION

Install and Set the Gap & Height  
Per the Product Manual.

ITEM NO.	QTY.	PART NUMBER	DESCRIPTION
1	1	3500-1058020-15A	M3-0.5 x 20mm SHCS, Blue, Pre-Applied
2	1	3700-50-6007	SENSOR CLAMP, ACT-390
3	1	8590-9909999-08	PNP Proximity Sensor
4	1	8590-9909999-13	90 Deg. CABLE
5	1	9600-50-0002	FORWARD SENSOR LABEL, ACT-390

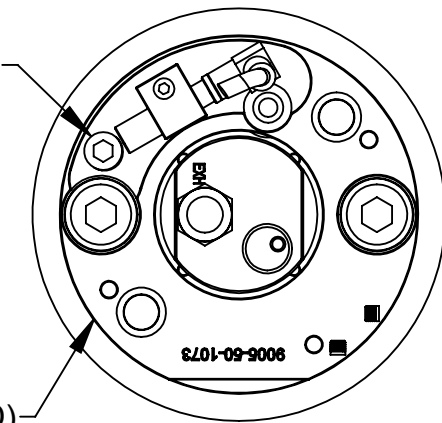

ACT-390 ASSEMBLY (REAR HOUSING REMOVED)

The forward sensor is "ON" when the spindle is fully forward and not contacting the workpiece.

9005-50-1078

Fit to the Slot Inside  
the Rear Housing

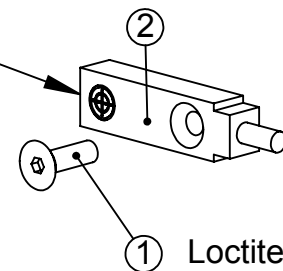

Loctite 222 / 60 oz - in

## OPTION - R, RETRACT SENSOR OPTION

Sensor Wires  
Pass Through Here

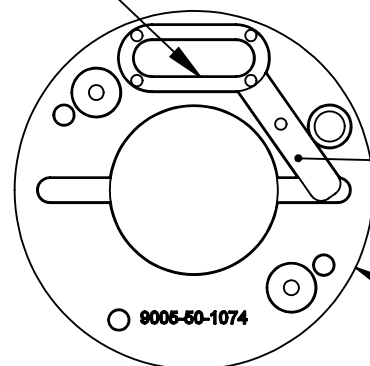

Fit the Sensor Here

Rear Housing Assembly

ITEM NO.	QTY.	PART NUMBER	DESCRIPTION
1	1	3500-1258010-15	M3 x 10mm SFHCS Blue Dyed Magni-565
2	1	8590-9909999-138	LED PNP Flat Pack Sensor .3M Lg (90 Pico), Weld field immune
3	1	9600-50-0003	RETRACT SENSOR LABEL, ACT-390

NOTES: UNLESS OTHERWISE SPECIFIED.

DO NOT SCALE DRAWING.  
ALL DIMENSIONS ARE IN MILLIMETERS.



3rd ANGLE PROJECTION



1031 Goodworth Drive, Apex, NC 27539, USA  
Tel: +1.919.772.0115 Email: info@ati-ia.com  
Fax: +1.919.772.8259 www.ati-ia.com  
ISO 9001 Registered Company

PROPERTY OF ATI INDUSTRIAL AUTOMATION, INC. NOT TO BE REPRODUCED IN ANY MANNER EXCEPT ON ORDER OR WITH PRIOR WRITTEN AUTHORIZATION OF ATI.

DRAWN BY: D.Lawson-5/24/12

CHECKED BY: D.Swanson-5/30/12

TITLE

ACT-390 Series Customer Drawing

PROJECT # 040907-1 SHEET 2 OF 3

SCALE  
1:1

SIZE  
B

DRAWING NUMBER  
9630-50-ACT-390 Series

REVISION  
05

The retract sensor is "ON" when the spindle is fully backward (pushed backwards to the limit of travel).

**Thread locker Note:**

Fasteners on this drawing include both torque and thread locker specifications. Thread locker (Loctite) is not required when using new "blue" fasteners purchased from ATI. Thread locker is required anytime fasteners are being re-used.

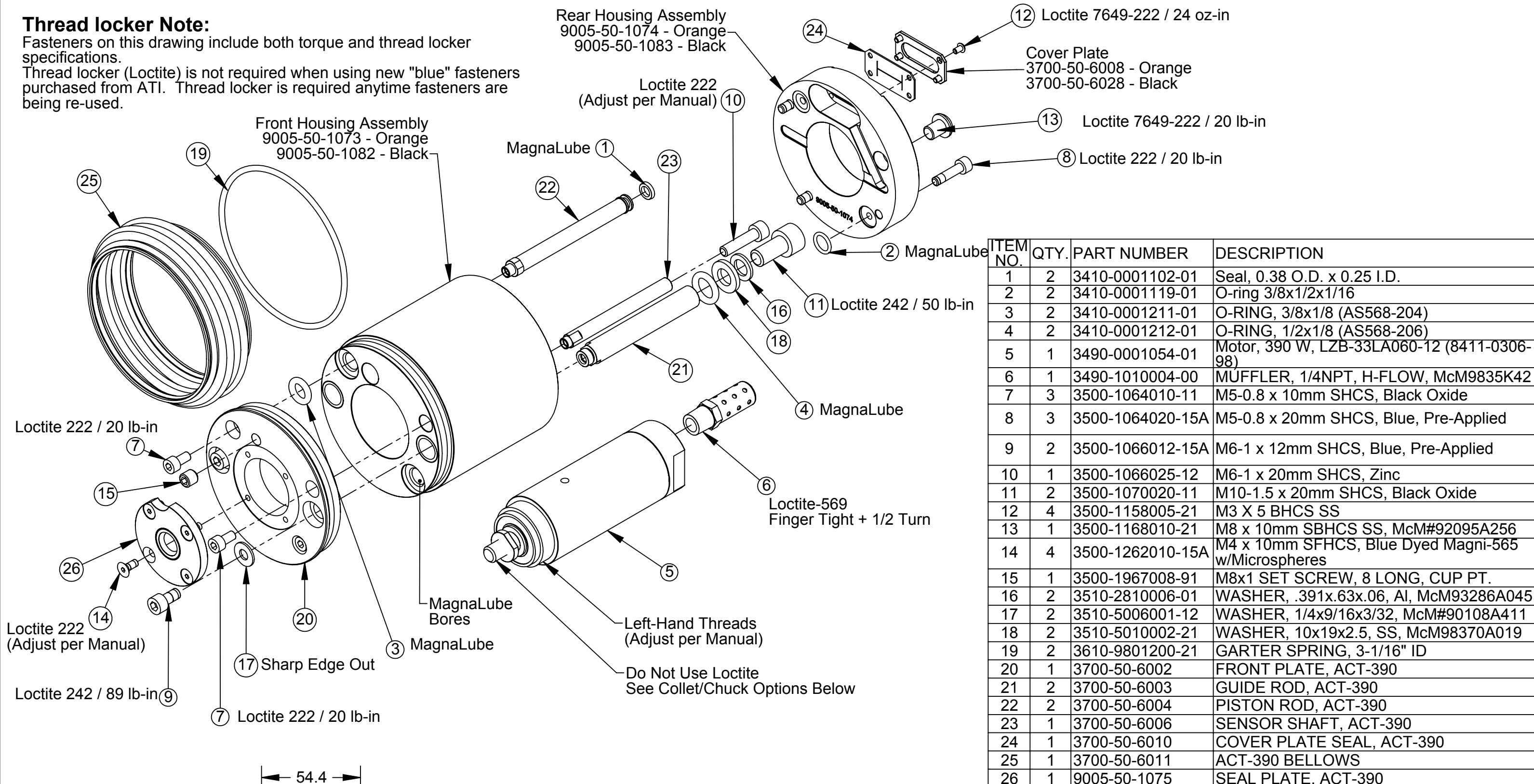

ITEM NO.	QTY.	PART NUMBER	DESCRIPTION
1	2	3410-0001102-01	Seal, 0.38 O.D. x 0.25 I.D.
2	2	3410-0001119-01	O-ring 3/8x1/2x1/16
3	2	3410-0001211-01	O-RING, 3/8x1/8 (AS568-204)
4	2	3410-0001212-01	O-RING, 1/2x1/8 (AS568-206)
5	1	3490-0001054-01	Motor, 390 W, LZB-33LA060-12 (8411-0306-98)
6	1	3490-1010004-00	MUFFLER, 1/4NPT, H-FLOW, McM9835K42
7	3	3500-1064010-11	M5-0.8 x 10mm SHCS, Black Oxide
8	3	3500-1064020-15A	M5-0.8 x 20mm SHCS, Blue, Pre-Applied
9	2	3500-1066012-15A	M6-1 x 12mm SHCS, Blue, Pre-Applied
10	1	3500-1066025-12	M6-1 x 20mm SHCS, Zinc
11	2	3500-1070020-11	M10-1.5 x 20mm SHCS, Black Oxide
12	4	3500-1158005-21	M3 X 5 BHCS SS
13	1	3500-1168010-21	M8 x 10mm SBHCS SS, McM#92095A256
14	4	3500-1262010-15A	M4 x 10mm SFHCS, Blue Dyed Magni-565 w/Microspheres
15	1	3500-1967008-91	M8x1 SET SCREW, 8 LONG, CUP PT.
16	2	3510-2810006-01	WASHER, .391x.63x.06, Al, McM93286A045
17	2	3510-5006001-12	WASHER, 1/4x9/16x3/32, McM#90108A411
18	2	3510-5010002-21	WASHER, 10x19x2.5, SS, McM98370A019
19	2	3610-9801200-21	GARTER SPRING, 3-1/16" ID
20	1	3700-50-6002	FRONT PLATE, ACT-390
21	2	3700-50-6003	GUIDE ROD, ACT-390
22	2	3700-50-6004	PISTON ROD, ACT-390
23	1	3700-50-6006	SENSOR SHAFT, ACT-390
24	1	3700-50-6010	COVER PLATE SEAL, ACT-390
25	1	3700-50-6011	ACT-390 BELLOWS
26	1	9005-50-1075	SEAL PLATE, ACT-390

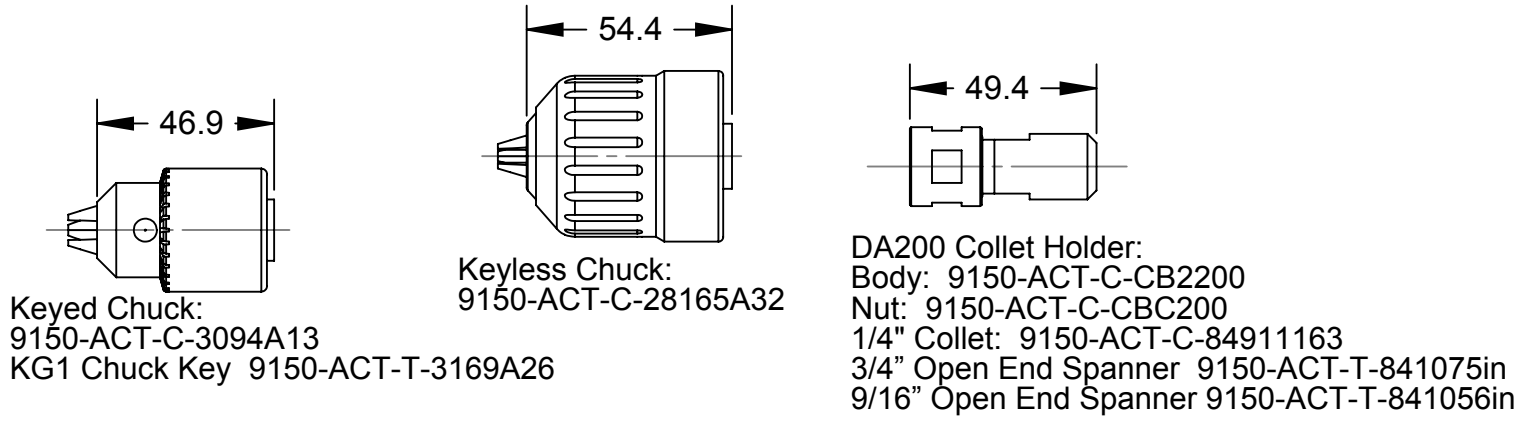

NOTES: UNLESS OTHERWISE SPECIFIED.  
DO NOT SCALE DRAWING. ALL DIMENSIONS ARE IN MILLIMETERS.



1031 Goodworth Drive, Apex, NC 27539, USA  
Tel: +1.919.772.0115 Email: info@ati-ia.com  
Fax: +1.919.772.8259 www.ati-ia.com  
ISO 9001 Registered Company

PROPERTY OF ATI INDUSTRIAL AUTOMATION, INC. NOT TO BE REPRODUCED IN ANY MANNER EXCEPT ON ORDER OR WITH PRIOR WRITTEN AUTHORIZATION OF ATI.

DRAWN BY: D.Lawson-5/24/12		TITLE	
CHECKED BY: D.Swanson-5/30/12		ACT-390 Series Customer Drawing	
PROJECT # 040907-1	SHEET 3 OF 3	SCALE 1:2	SIZE B
		DRAWING NUMBER	REVISION
		9630-50-ACT-390 Series	05