

REV.	DESCRIPTION	INITIATOR	DATE
04	ECO 17668; Sht 2, Added Fittings, removed table, updated notes.	LJH	2/26/19

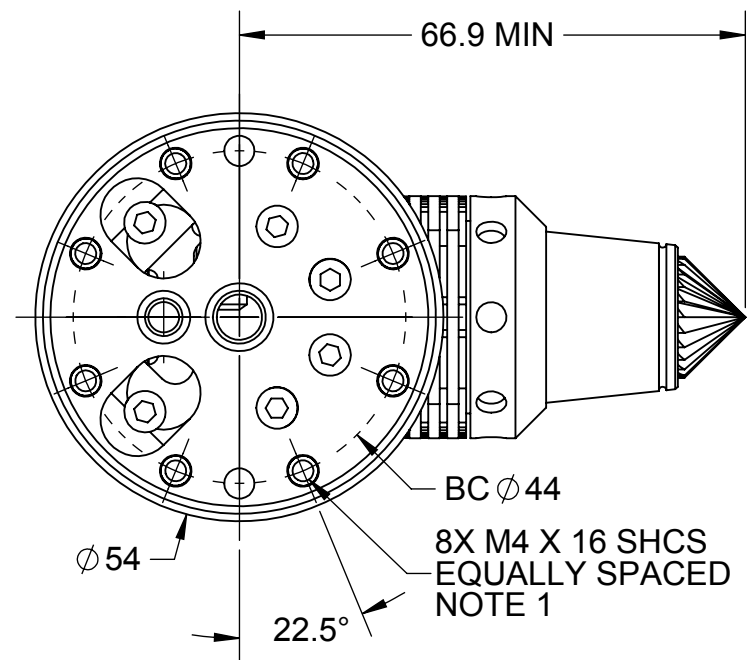
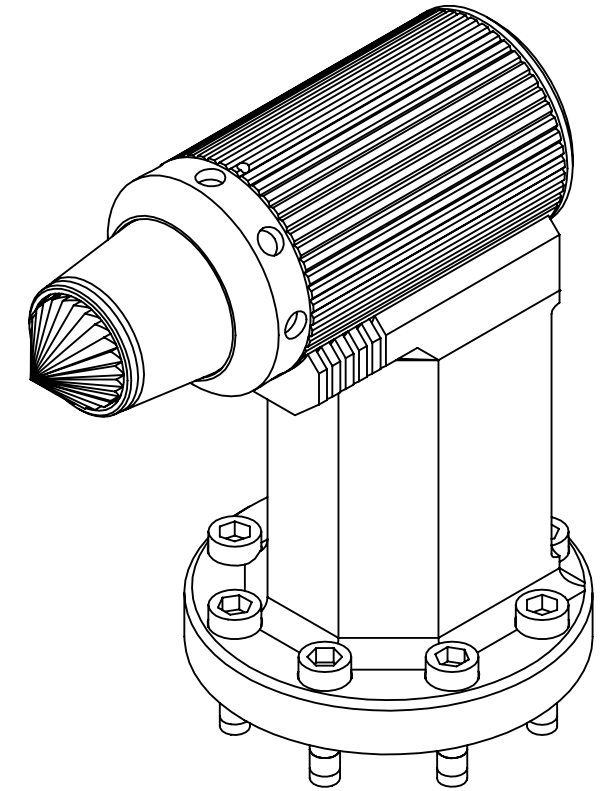
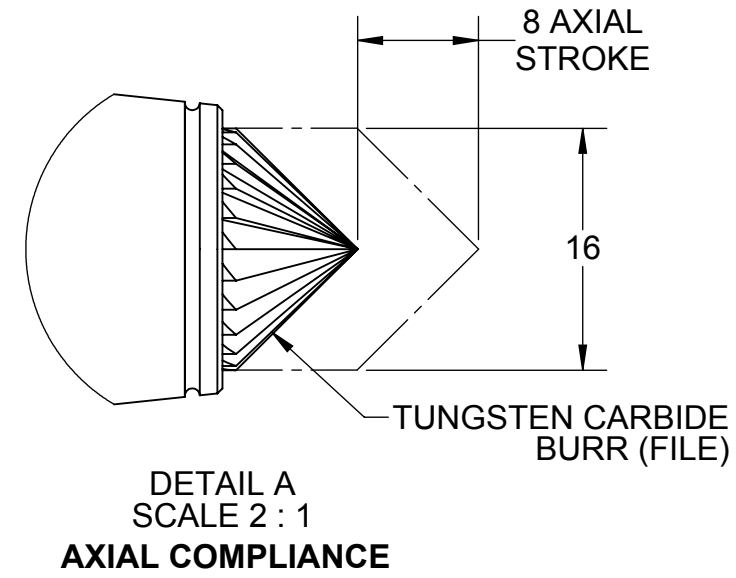
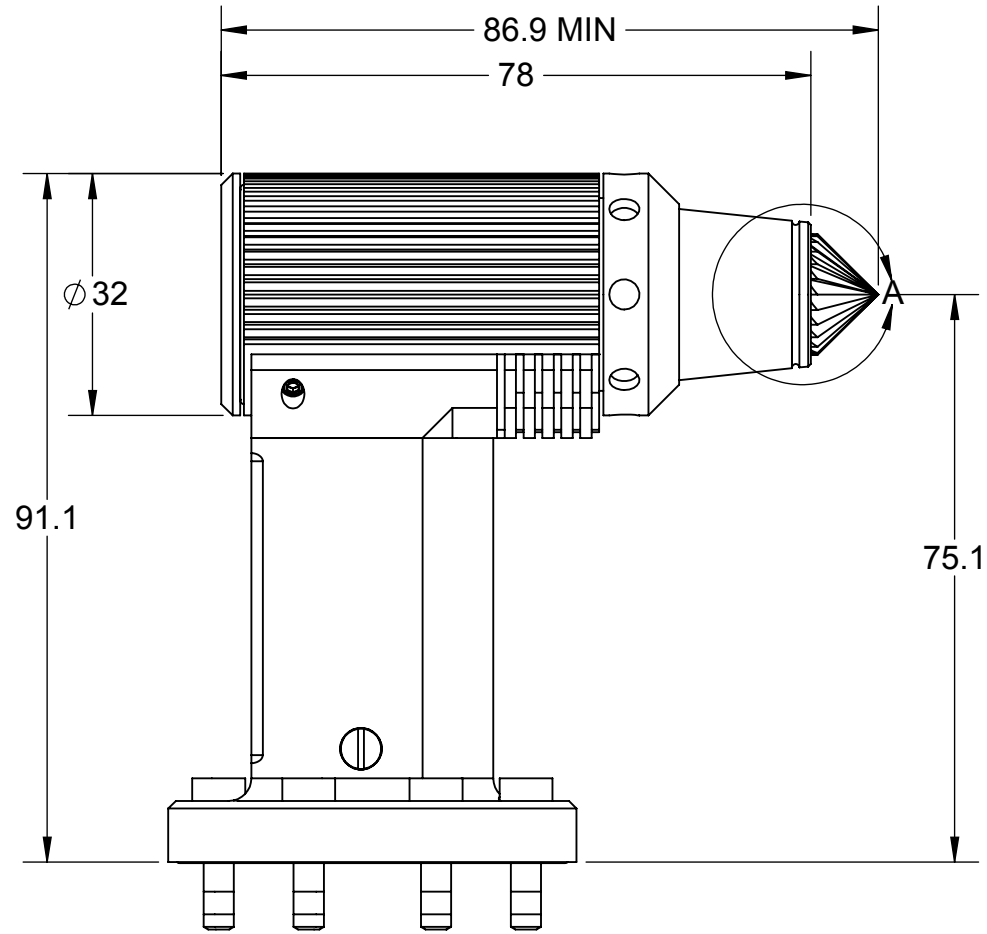

Notes:
1. INTERFACE WITH OPTIONAL ADAPTER PLATE, SEE SHEET 2.
RECOMMENDED TORQUE = 25 IN-LBS

NOTES: UNLESS OTHERWISE SPECIFIED.

DO NOT SCALE DRAWING.
ALL DIMENSIONS ARE IN MILLIMETERS.

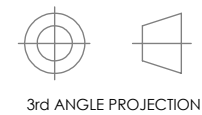

1031 Goodworth Drive, Apex, NC 27539, USA
Tel: +1.919.772.0115 Email: info@ati-ia.com
Fax: +1.919.772.8259 www.ati-ia.com
ISO 9001 Registered Company

PROPERTY OF ATI INDUSTRIAL AUTOMATION, INC. NOT TO BE REPRODUCED IN ANY MANNER EXCEPT ON ORDER OR WITH PRIOR WRITTEN AUTHORIZATION OF ATI.

DRAWN BY: B. ROSE - 6/26/2018		TITLE	
CHECKED BY: T. BURNS - 7/2/2018		AC-90 SPEEDEBURR CUSTOMER DRAWING	
PROJECT # -	SHEET 1 OF 3	SCALE	SIZE
		1:1	B
DRAWING NUMBER		REVISION	
9630-50-AC-90		04	

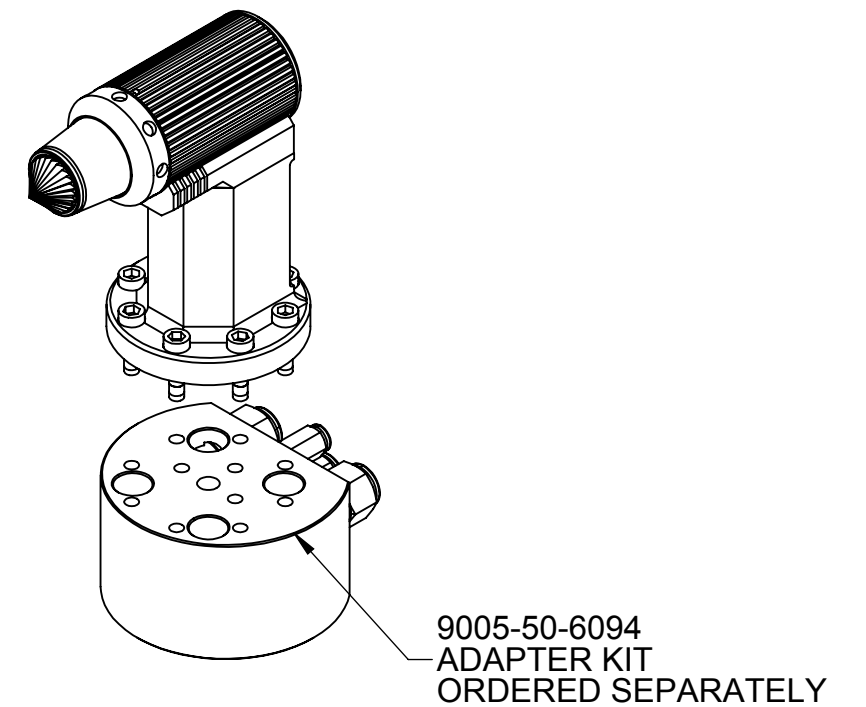
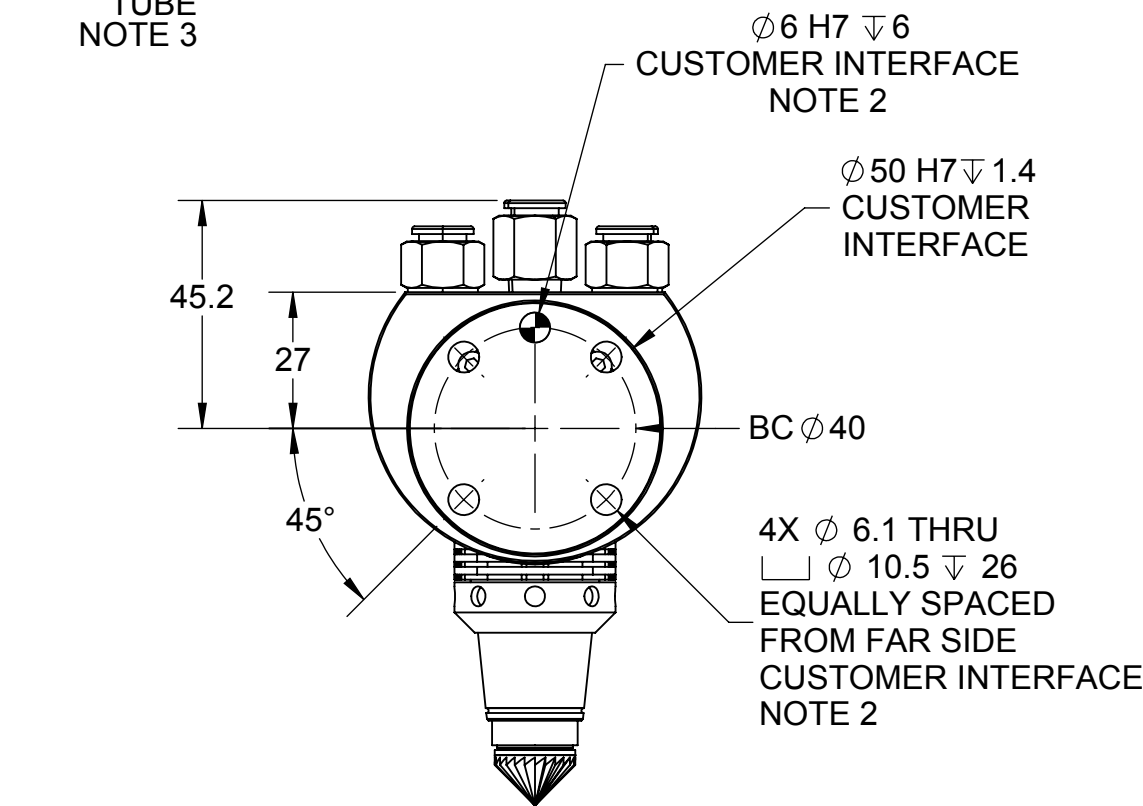
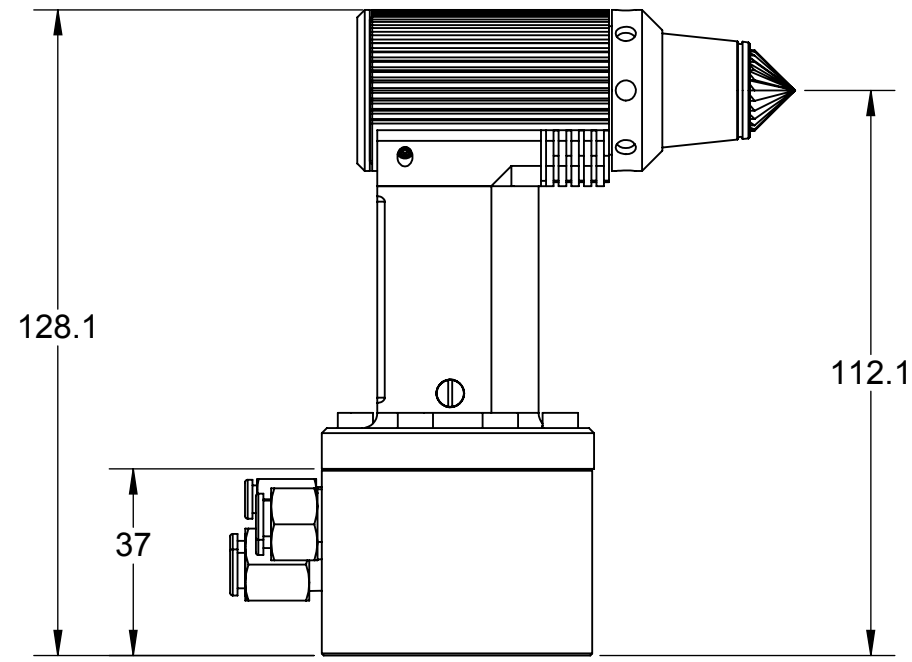
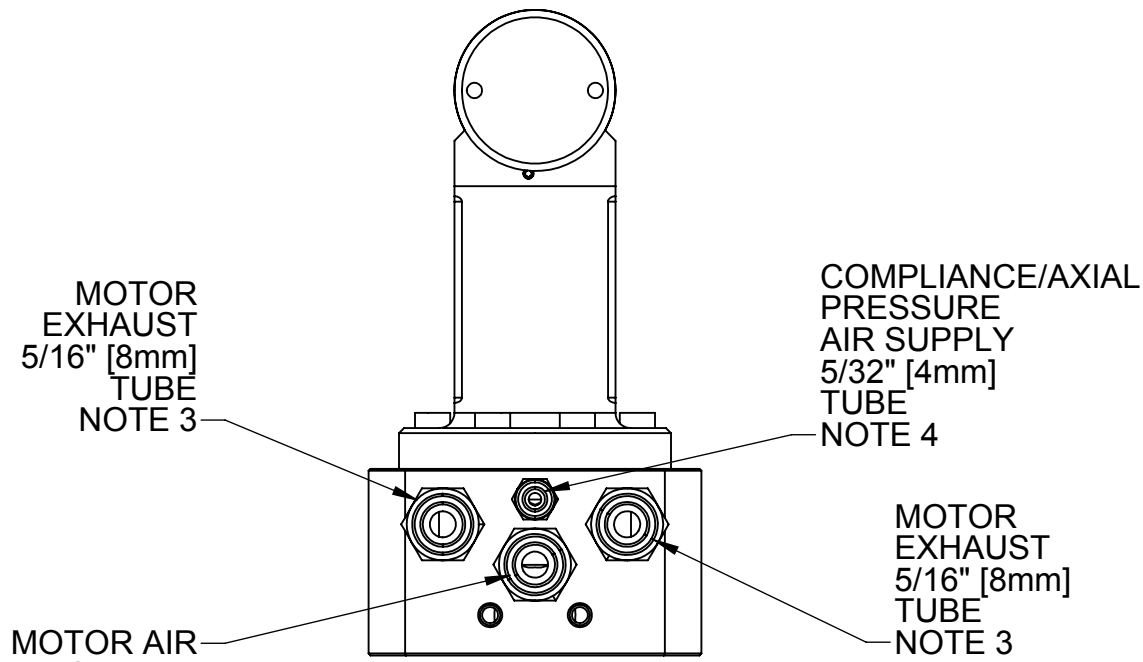

- Notes:
- CUSTOMER TO SUPPLY M6 FASTENERS AND DOWEL FOR ADAPTER PLATE MOUNTING.
 - FITTINGS SUPPLIED WITH PRE-APPLIED THREAD SEALANT, HAND TIGHTEN +1/2 TURN.
 - APPLY 569 THREAD SEALANT TO FITTING, HAND TIGHTEN +1/2 TURN.

NOTES: UNLESS OTHERWISE SPECIFIED.

DO NOT SCALE DRAWING. ALL DIMENSIONS ARE IN MILLIMETERS.

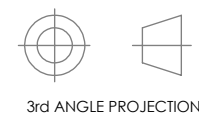

1031 Goodworth Drive, Apex, NC 27539, USA
Tel: +1.919.772.0115 Email: info@ati-ia.com
Fax: +1.919.772.8259 www.ati-ia.com
ISO 9001 Registered Company

PROPERTY OF ATI INDUSTRIAL AUTOMATION, INC. NOT TO BE REPRODUCED IN ANY MANNER EXCEPT ON ORDER OR WITH PRIOR WRITTEN AUTHORIZATION OF ATI.

DRAWN BY: B. ROSE - 6/26/2018		TITLE		
CHECKED BY: T. BURNS - 7/2/2018		AC-90 SPEEDEBURR CUSTOMER DRAWING		
PROJECT # -	SHEET 2 OF 3	SCALE	SIZE	DRAWING NUMBER
		2:3	B	9630-50-AC-90
				REVISION
				04

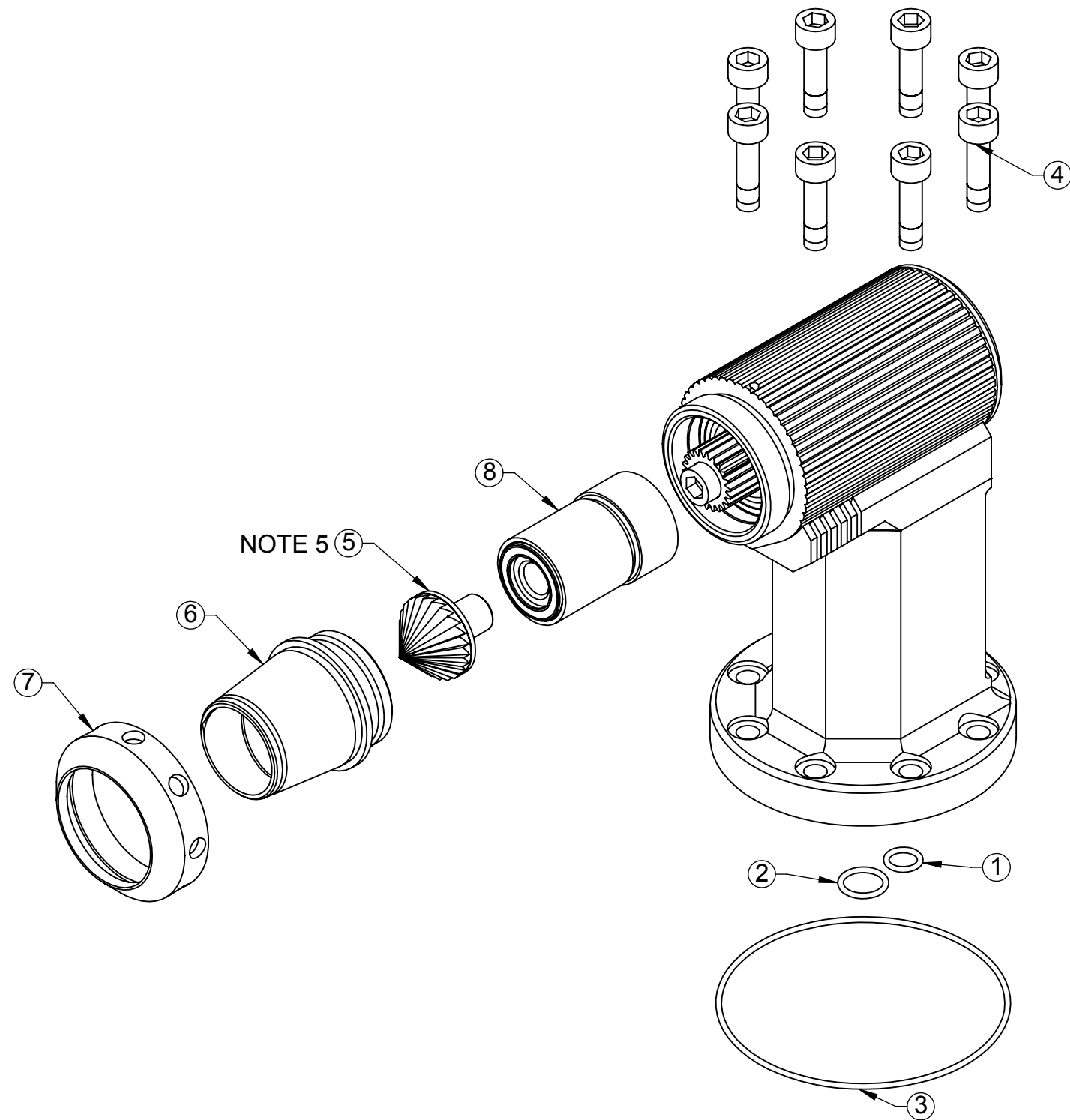

9150-AC-90 SERVICEABLE PARTS

Notes:
5. OTHER BUR OPTIONS AVAILABLE.

ITEM NO.	QTY	PART NUMBER	DESCRIPTION
1	1	3410-0001075-01	O-Ring 5mm x1mm Buna-N D70
2	1	3410-0001076-01	O-Ring 7mm x 1mm, Buna-N 70
3	1	3410-0001465-01	O-ring, 50mm ID x 1mm W, Buna-N, 70A Duro
4	8	3500-1062016-15A	M4-0.7 x 16mm SHCS, Blue, Pre-Applied
5	1	3700-50-1003	HIAC Straight Burr, C2 Material
6	1	3700-51-1009	Cylinder, AC
7	1	3700-51-1012	Lock Nut, AC
8	1	9005-51-1000	Free Flying Piston Assembly, AC

NOTES: UNLESS OTHERWISE SPECIFIED.

DO NOT SCALE DRAWING. ALL DIMENSIONS ARE IN MILLIMETERS.

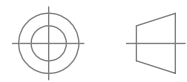

3rd ANGLE PROJECTION



1031 Goodworth Drive, Apex, NC 27539, USA
Tel: +1.919.772.0115 Email: info@ati-ia.com
Fax: +1.919.772.8259 www.ati-ia.com
ISO 9001 Registered Company

PROPERTY OF ATI INDUSTRIAL AUTOMATION, INC. NOT TO BE REPRODUCED IN ANY MANNER EXCEPT ON ORDER OR WITH PRIOR WRITTEN AUTHORIZATION OF ATI.

DRAWN BY: B. ROSE - 6/26/2018

CHECKED BY: T. BURNS - 7/2/2018

TITLE
AC-90 SPEEDEBURR CUSTOMER DRAWING

PROJECT # - SHEET 3 OF 3

SCALE
1:1

SIZE
B

DRAWING NUMBER
9630-50-AC-90

REVISION
04