

Rev.	Description	Initiator	Date
02	ECO 12472: Changed torque from 48 ft-lbs to 250 in-lbs on M12 SHCS callout.	MSD	4/3/2015

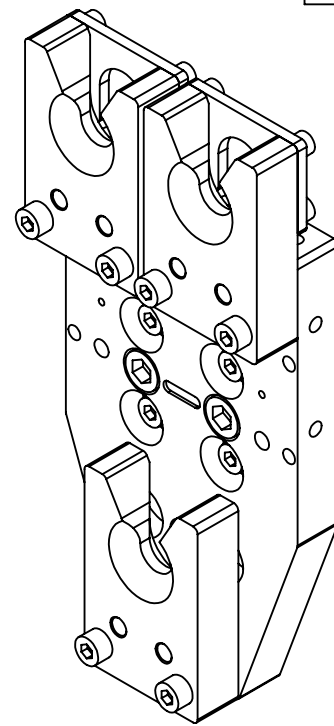

4X M8 SHCS
242 / 140 in-lbs
Note 1

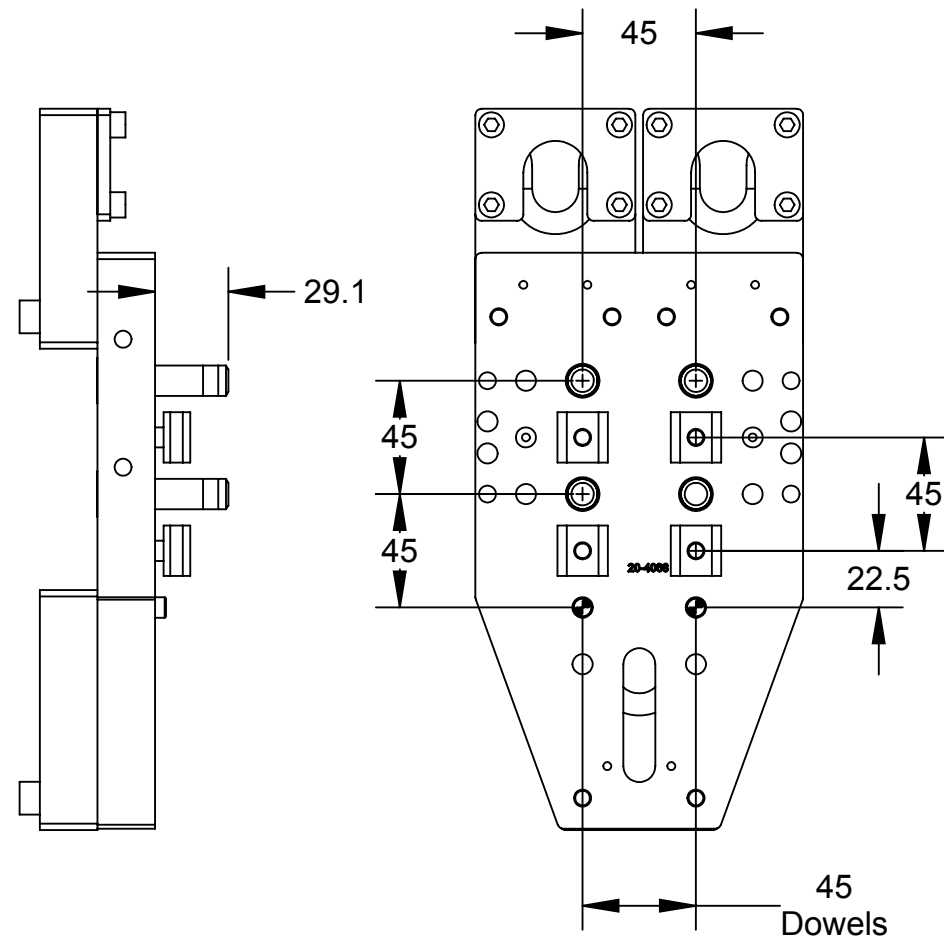
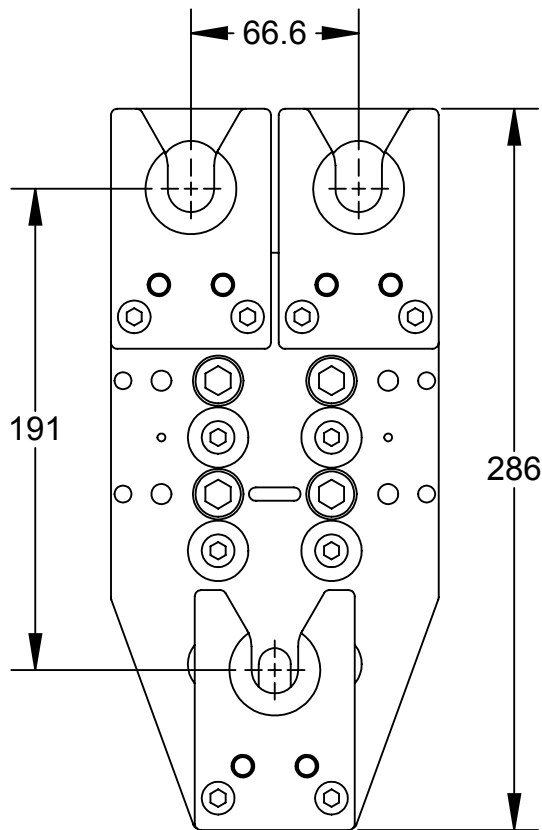
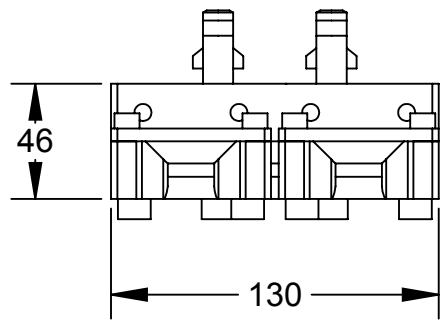
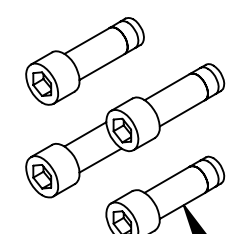

4X M12 SHCS
Pre / 250 in-lbs
Note 2

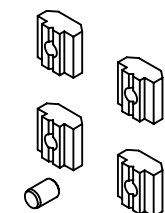

2X Ø M8 Dowel
Note 3

ITEM NO.	QTY.	PART NUMBER	DESCRIPTION
1	1	9120-TSM-MMV-4070	TSM Mounting Module, V-Block, Vertical, Large

Notes:

1. If assembling to 9120-TSM-ASY-XXXX, customer to use Loctite or similar threadlocker and torque fasteners to listed torque.
2. If assembling to 9120-TSM-HE-XXXX, customer to torque pre-applied fasteners to listed torque.
3. Customer to press dowels into mounting plate if needed.

NOTES: UNLESS OTHERWISE SPECIFIED.

DO NOT SCALE DRAWING. ALL DIMENSIONS ARE IN MILLIMETERS.



3rd ANGLE PROJECTION



1031 Goodworth Drive, Apex, NC 27539, USA
Tel: +1.919.772.0115 Email: info@ati-ia.com
Fax: +1.919.772.8259 www.ati-ia.com
ISO 9001 Registered Company

PROPERTY OF ATI INDUSTRIAL AUTOMATION, INC. NOT TO BE REPRODUCED IN ANY MANNER EXCEPT ON ORDER OR WITH PRIOR WRITTEN AUTHORIZATION OF ATI.

DRAWN BY: J. Winterroth, 12/03/13		TITLE	
CHECKED BY: D. Norton, 12/04/13		TSM Mounting Module, V-Block, Vertical, Large	
PROJECT # -	SHEET 1 OF 1	SCALE	SIZE
		1:3	B
		DRAWING NUMBER	REVISION
		9630-20-TSM-MMV-4070	02