

"DANGER! - For electrical modules using > 60VDC or 42 VAC, NO contact should be attempted before removing power. This especially includes separation or insertion of the mating connectors or any contact with the tool changer or its components."

Rev.	Description	Initiator	Date
03	ECO 5942: Added "Danger! remove power" note.	CDM	12/13/2007
04	Eco 8492: Added spacer to tool side module	LJH	4/7/2011

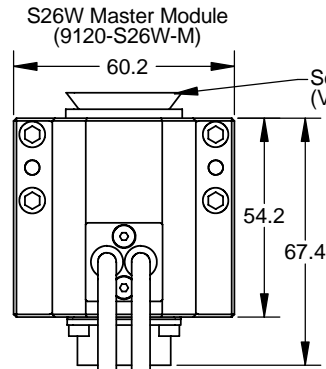
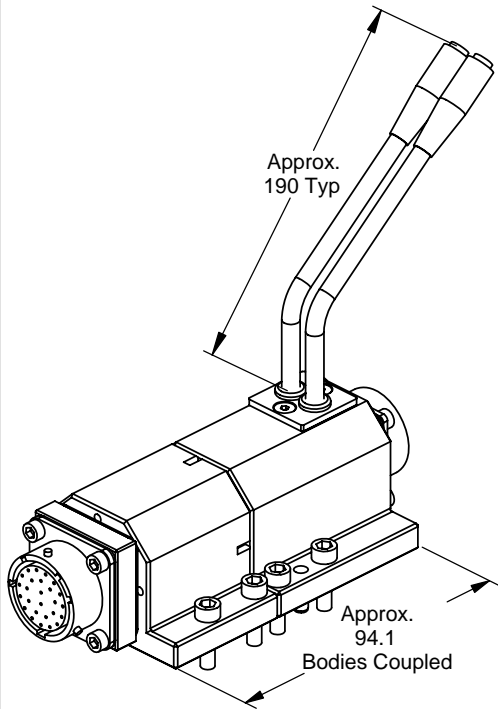

Lock/Unlock Cables
Unlock signal -----
+10-30 VDC-----

0 VDC-----
Lock signal -----

Lock Cable Marked with Green Tape (3-Pole Quick Disconnect)
Unlock Cable Marked with Red Tape (3-Pole Quick Disconnect)

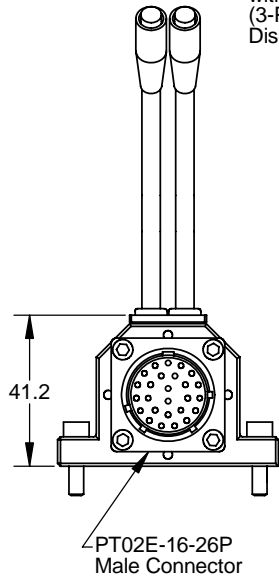

PT02E-16-26P Male Connector

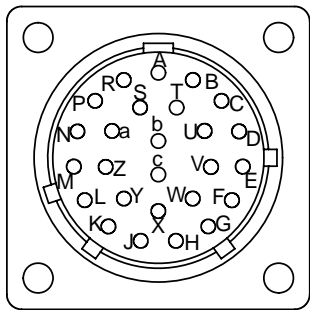

Bendix Connector
PT02E-16-26P
Face Side
(Master)

Pin Out

S26W Master PT02E-16-26P	S26 Tool PT02E-16-26S
A	A
B	B
C	C No Connect
D	D No Connect
E	E
F	F
G	G
H	H No Connect
J	J No Connect
K	K
L	L
M	M
N	N
P	P
R	R
S	S
T	T
U	U
V	V
W	W
X	X
Y	Y
Z	Z
a	a
b	b
c	c
	Ground

S26 Tool Module (9120-S26-T)

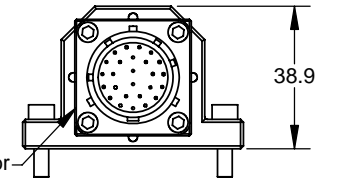
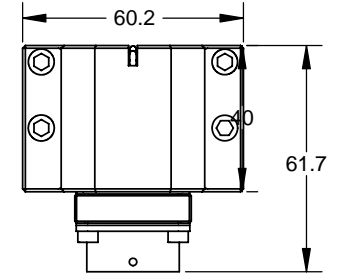

PT02E-16-26S Female Connector

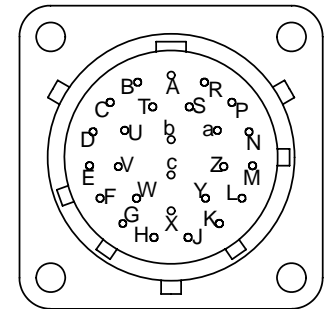

Bendix Connector
PT02E-16-26S
Face Side
(Tool)

NOTES: UNLESS OTHERWISE SPECIFIED.

DO NOT SCALE DRAWING. ALL DIMENSIONS ARE IN MILLIMETERS.

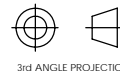

3rd ANGLE PROJECTION



1031 Goodworth Drive, Apex, NC 27539, USA
Tel: +1.919.772.0115 Email: info@ati-ia.com
Fax: +1.919.772.8259 www.ati-ia.com
ISO 9001 Registered Company

PROPERTY OF ATI INDUSTRIAL AUTOMATION, INC. NOT TO BE REPRODUCED IN ANY MANNER EXCEPT ON ORDER OR WITH PRIOR WRITTEN AUTHORIZATION OF ATI.

DRAWN BY: J.Snape 8/24/04	TITLE	S26W-M with S26-T Module Drawing		REVISION
CHECKED BY: D.Swanson 9/20/10	SCALE	SIZE	DRAWING NUMBER	04
PROJECT # 040706-1 SHEET 1 OF 1	3:4	B	9630-20-S26W-M, S26-T	