

**"DANGER!" - Electrical Shock Hazard**

This module has a Voltage of 50V or greater, NO contact should be attempted before removing power. This especially includes separation or insertion of the mating connectors or any contact with the tool changer or its components.

REV.	DESCRIPTION	INITIATOR	DATE
05	Eco 16961; Added Sheets 2 and 3. Added Pin Block Information and Electrical Shock Note. Updated Electrical Schematic to Current Standard.	CF	7/5/2018

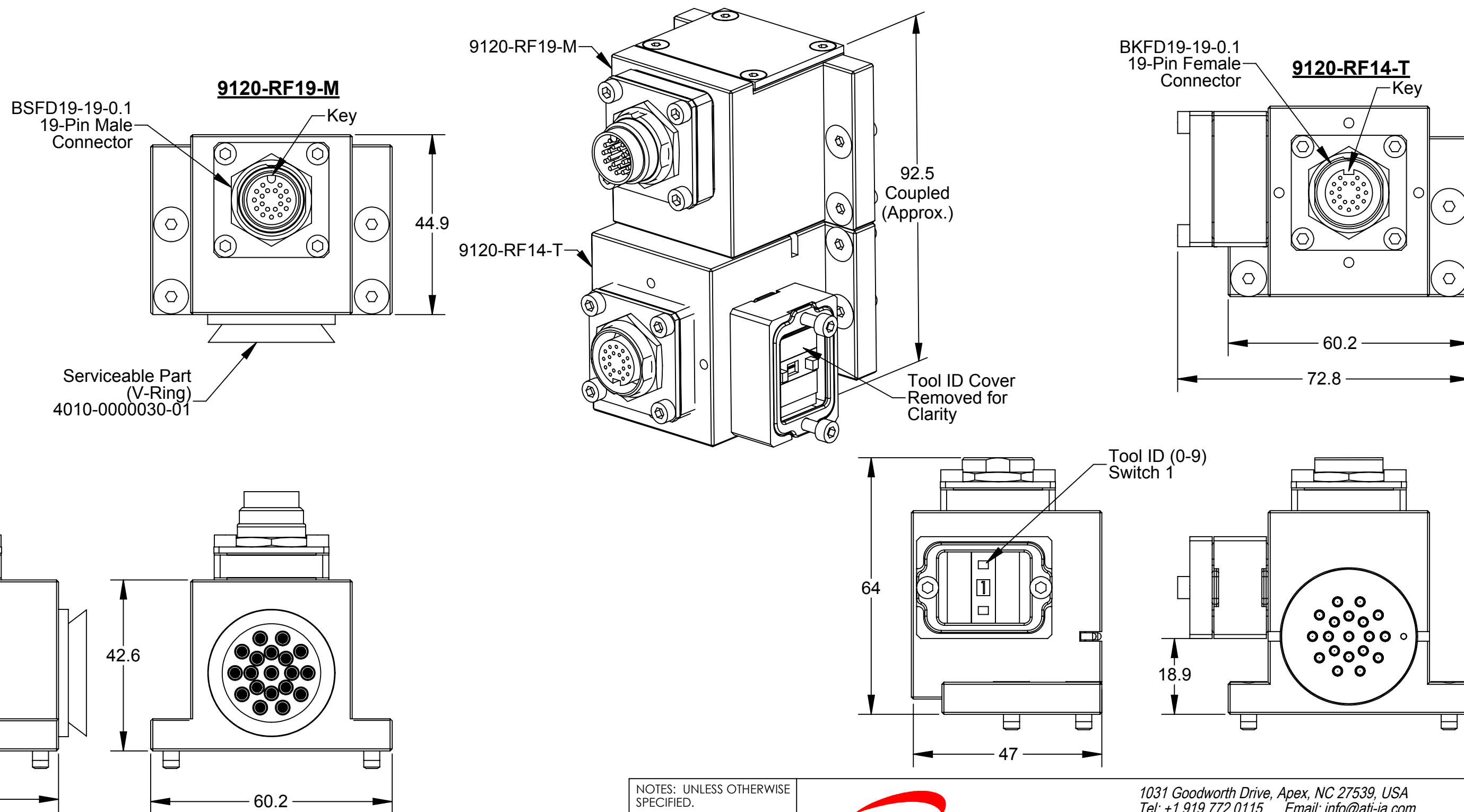

NOTES: UNLESS OTHERWISE SPECIFIED.

DO NOT SCALE DRAWING. ALL DIMENSIONS ARE IN MILLIMETERS.



3rd ANGLE PROJECTION



1031 Goodworth Drive, Apex, NC 27539, USA  
 Tel: +1.919.772.0115 Email: info@ati-ia.com  
 Fax: +1.919.772.8259 www.ati-ia.com  
 ISO 9001 Registered Company

PROPERTY OF ATI INDUSTRIAL AUTOMATION, INC. NOT TO BE REPRODUCED IN ANY MANNER EXCEPT ON ORDER OR WITH PRIOR WRITTEN AUTHORIZATION OF ATI.

DRAWN BY: J. Williams, 11/21/07		TITLE	
CHECKED BY: D. Lawson, 11/26/07		RF19 Master with RF14 Tool Module Drawing	
PROJECT # 071101-1	SHEET 1 OF 3	SCALE 1:1	SIZE B
DRAWING NUMBER 9630-20-RF19M RF14T		REVISION 05	

**9120-RF19-M**

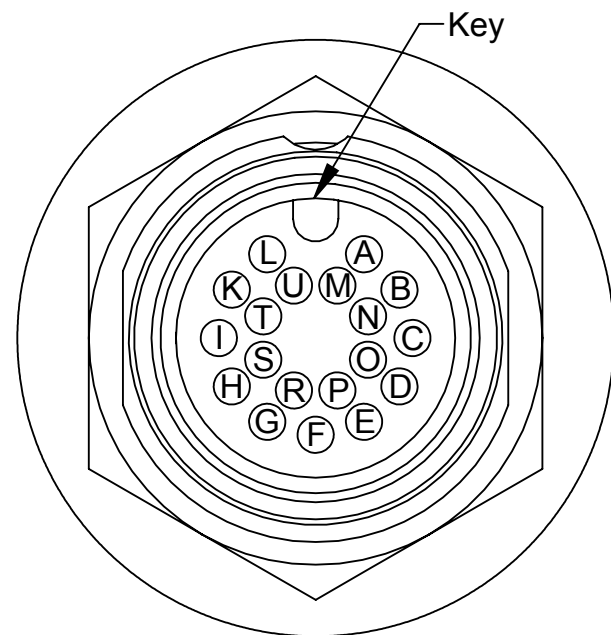
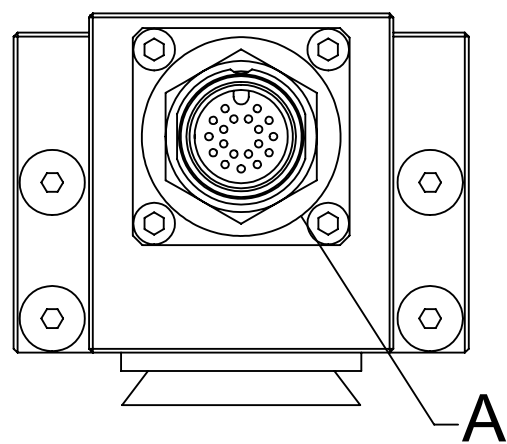

DETAIL A  
SCALE 3 : 1

Key

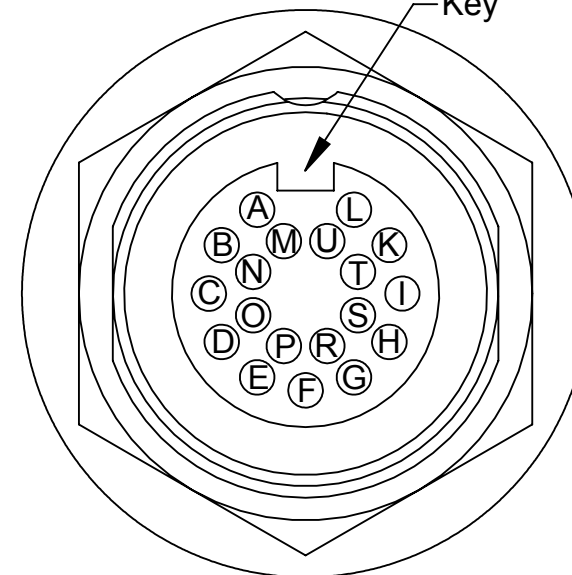

DETAIL C  
SCALE 3 : 1

**9120-RF14-T**

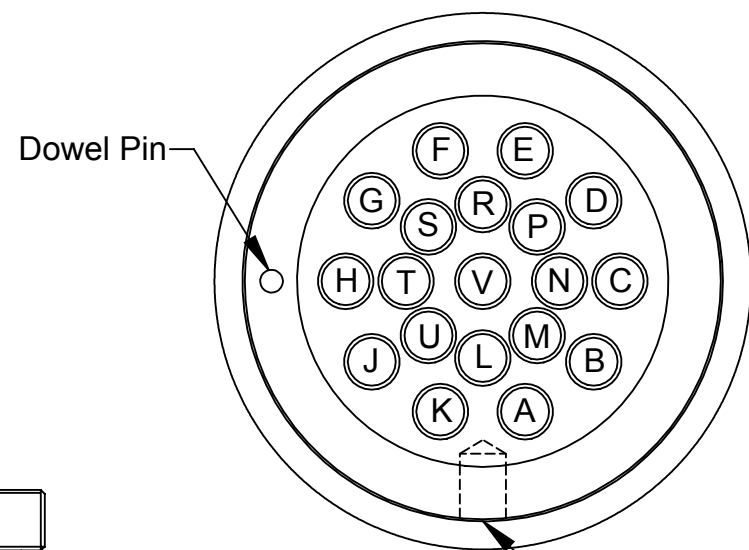
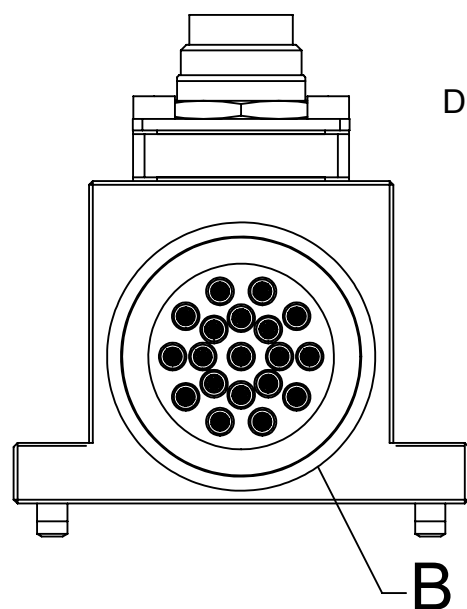
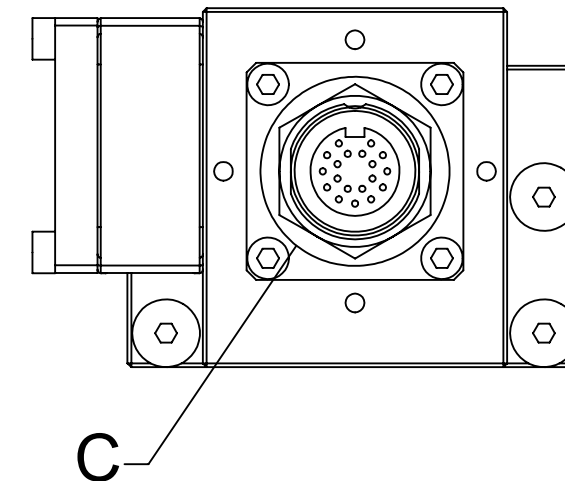

DETAIL B  
SCALE 2 : 1

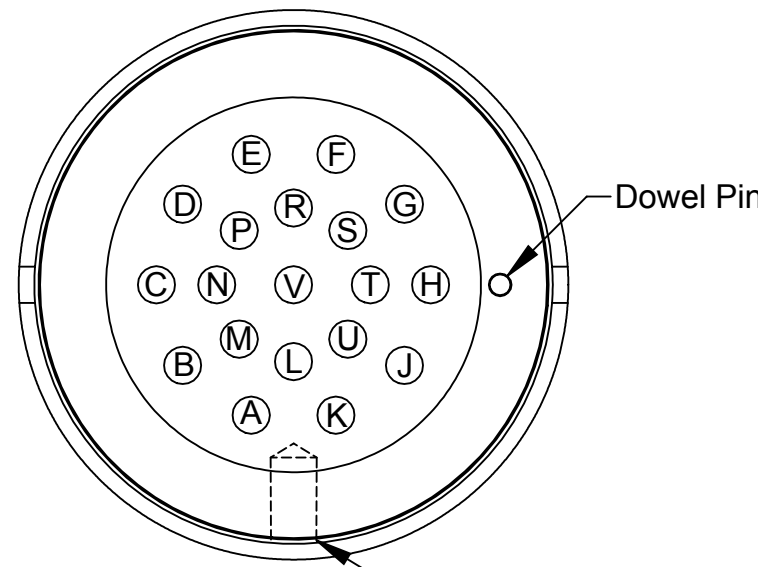

DETAIL D  
SCALE 2 : 1

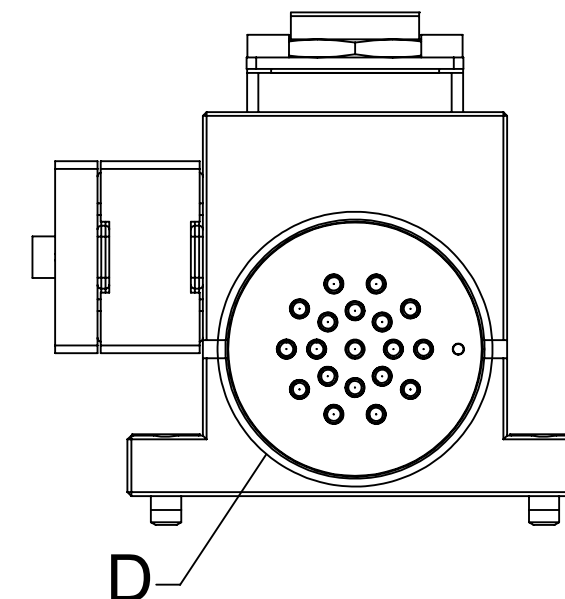

NOTES: UNLESS OTHERWISE SPECIFIED.

DO NOT SCALE DRAWING. ALL DIMENSIONS ARE IN MILLIMETERS.



1031 Goodworth Drive, Apex, NC 27539, USA  
Tel: +1.919.772.0115 Email: info@ati-ia.com  
Fax: +1.919.772.8259 www.ati-ia.com  
ISO 9001 Registered Company

PROPERTY OF ATI INDUSTRIAL AUTOMATION, INC. NOT TO BE REPRODUCED IN ANY MANNER EXCEPT ON ORDER OR WITH PRIOR WRITTEN AUTHORIZATION OF ATI.



3rd ANGLE PROJECTION

DRAWN BY: J. Williams, 11/21/07

CHECKED BY: D.Lawson, 11/26/07

PROJECT # 071101-1 SHEET 2 OF 3

TITLE  
RF19 Master with RF14 Tool Module Drawing

SCALE	SIZE	DRAWING NUMBER	REVISION
1:1	B	9630-20-RF19M RF14T	05

# 9120-RF19-M

# 9120-RF14-T

ATI 19-Pin Block

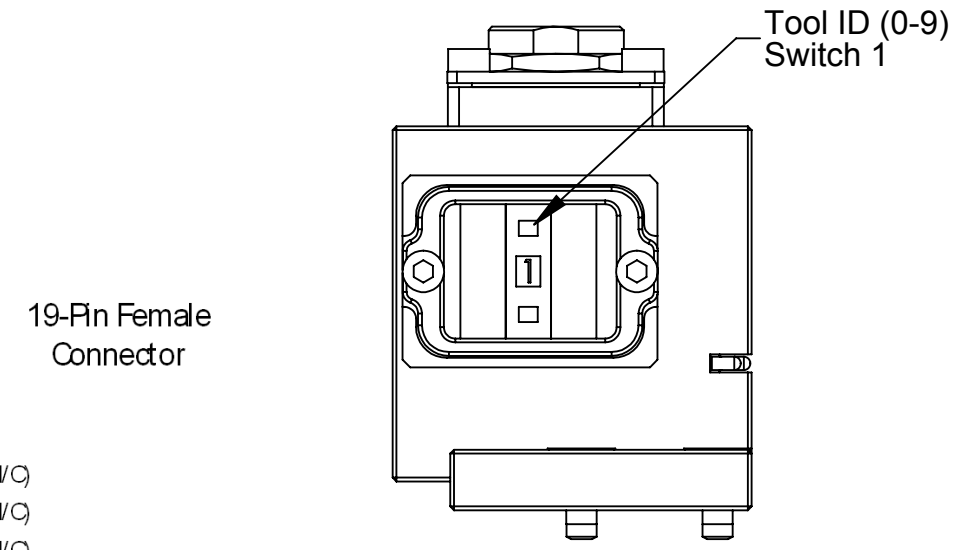
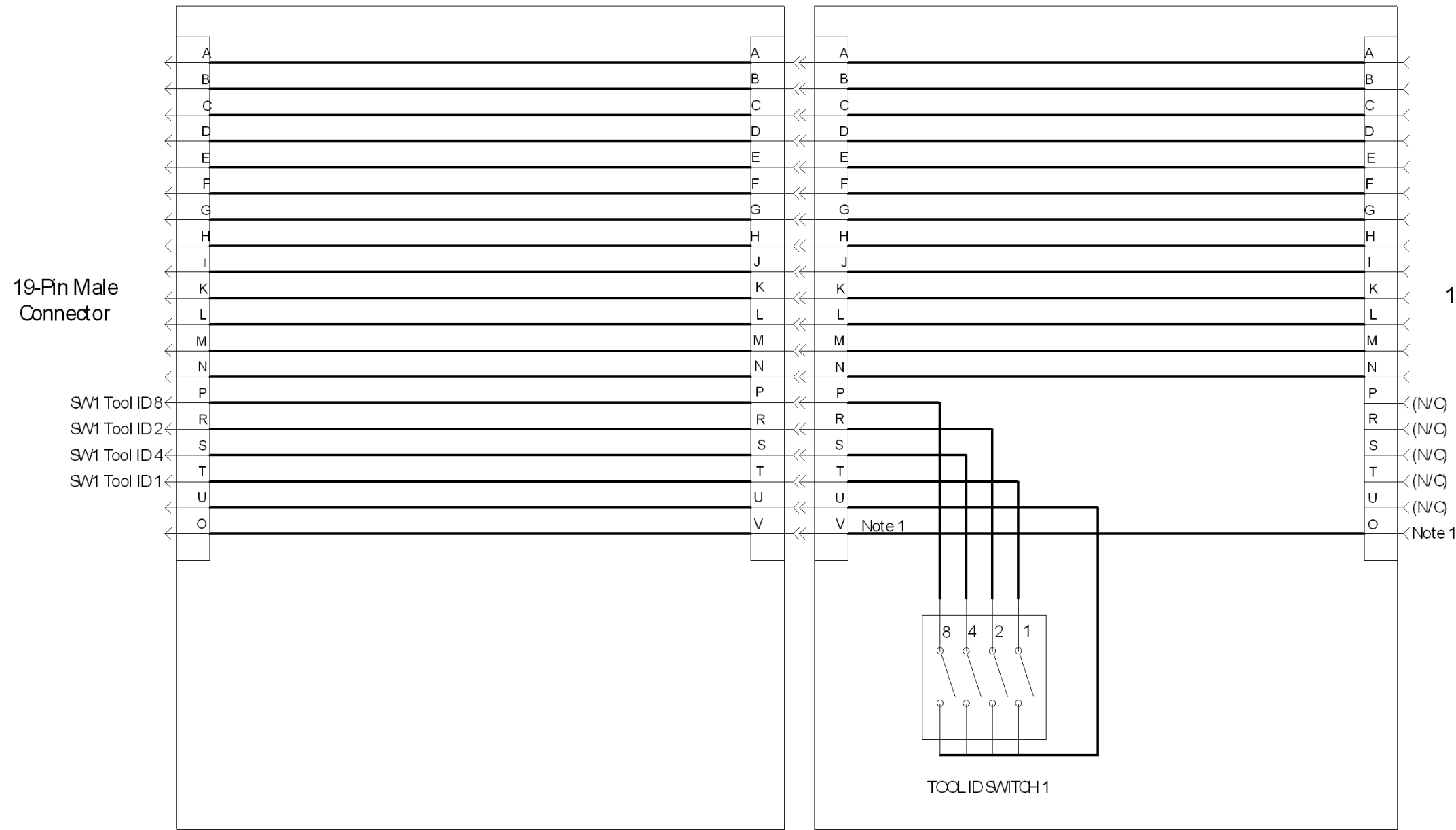
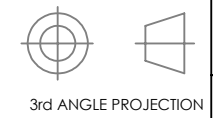

**TABLE 1: TOOL ID BINARY OUTPUT**

Switch Selection	Pin P	Pin S	Pin R	Pin T	Switch 1
0	0	0	0	0	
1	0	0	0	1	
2	0	0	1	0	
3	0	0	1	1	
4	0	1	0	0	
5	0	1	0	1	
6	0	1	1	0	
7	0	1	1	1	
8	1	0	0	0	
9	1	0	0	1	

- Notes:**
- Pin "O" is first to mate last to break at the tool changer interface. This pin is recommended for use as a ground.
  - Pin "U" is common for tool ID (5-50 VDC 100mA Max).

NOTES: UNLESS OTHERWISE SPECIFIED.  
DO NOT SCALE DRAWING. ALL DIMENSIONS ARE IN MILLIMETERS.



1031 Goodworth Drive, Apex, NC 27539, USA  
Tel: +1.919.772.0115 Email: info@ati-ia.com  
Fax: +1.919.772.8259 www.ati-ia.com  
ISO 9001 Registered Company

PROPERTY OF ATI INDUSTRIAL AUTOMATION, INC. NOT TO BE REPRODUCED IN ANY MANNER EXCEPT ON ORDER OR WITH PRIOR WRITTEN AUTHORIZATION OF ATI.

DRAWN BY: J. Williams, 11/21/07		TITLE	
CHECKED BY: D.Lawson, 11/26/07		RF19 Master with RF14 Tool Module Drawing	
PROJECT #	071101-1	SHEET	3 OF 3
SCALE	1:1	SIZE	B
DRAWING NUMBER		REVISION	
9630-20-RF19M RF14T		05	