

Rev.	Description	Initiator	Date
03	Eco; 18469; Updated model to show mounting hole slot on tool housing. Sht 2, added note 3.	LJH	10/10/19

"DANGER! - For electrical modules using > 60VDC or 42 VAC, NO contact should be attempted before removing power. This especially includes separation or insertion of the mating connectors or any contact with the tool changer or its components."

R26R Master Module
(9120-R26R-M)

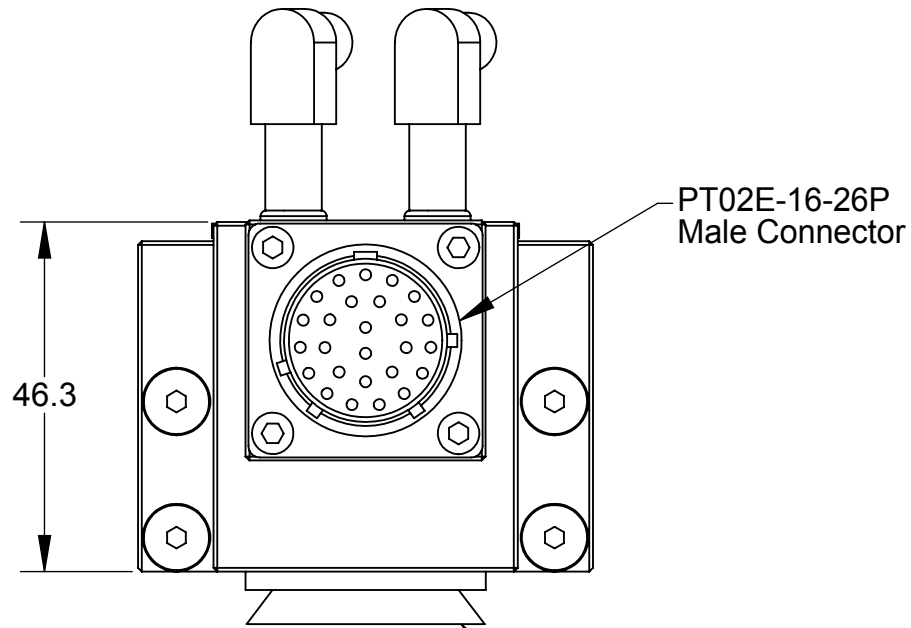
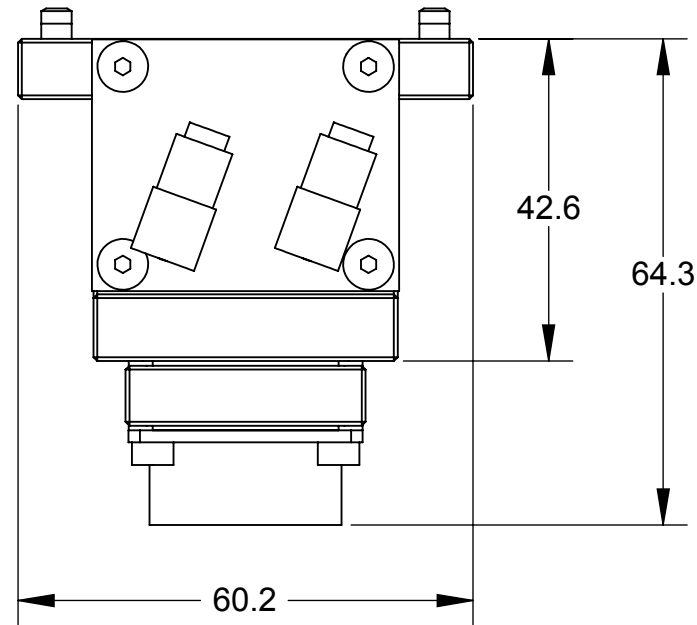

Serviceable Part:
(V-Ring)
4010-0000030-01

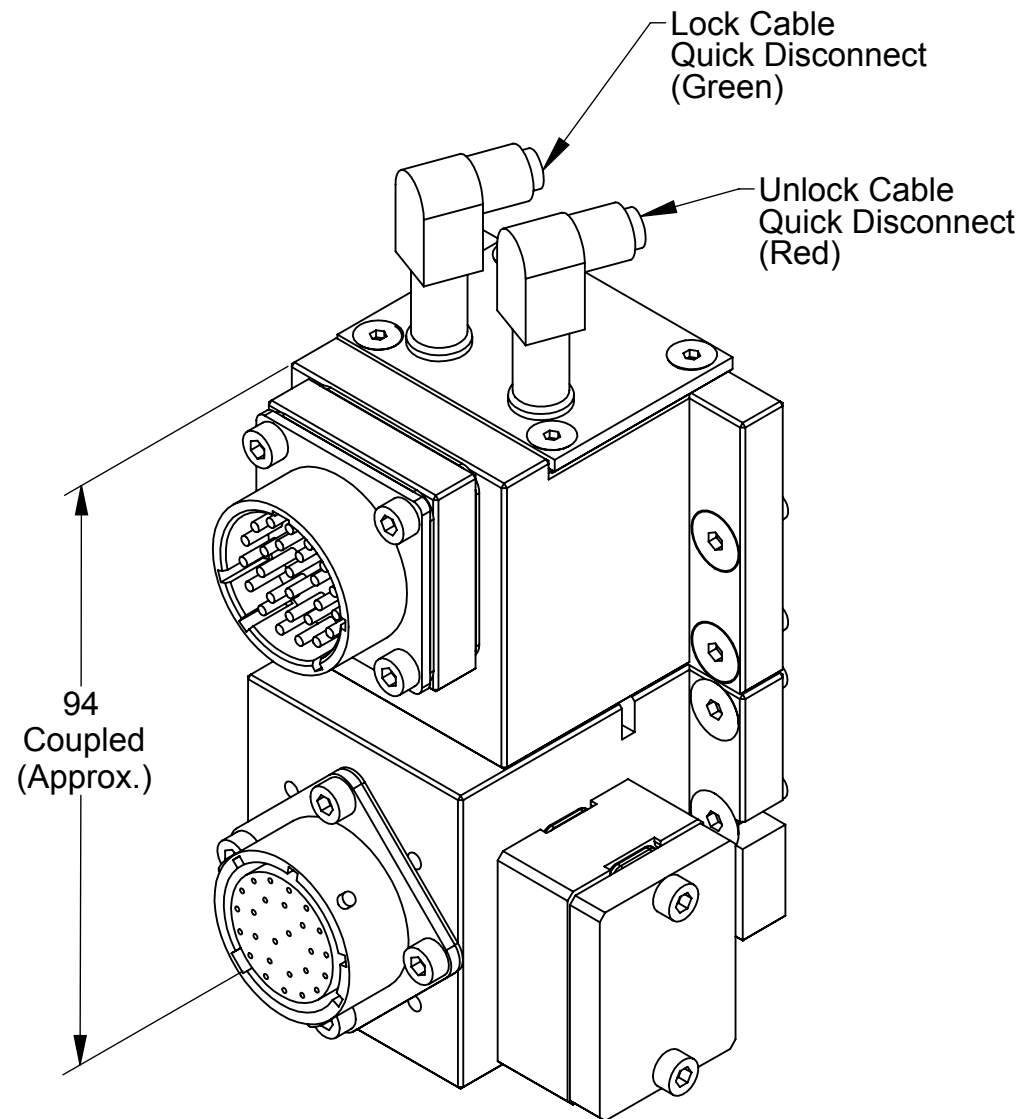

R21 Tool Module
(9120-R21-T)

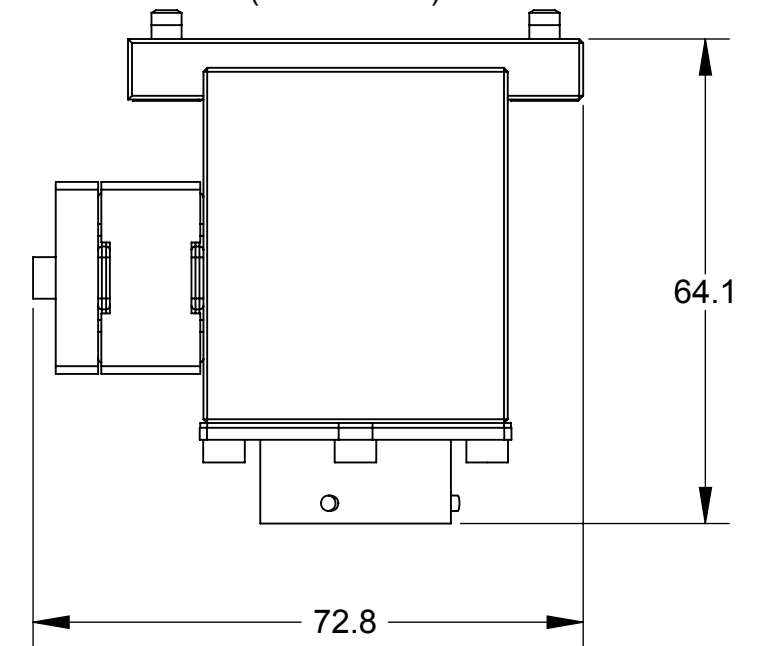

PT02E-16-26S
Female Connector

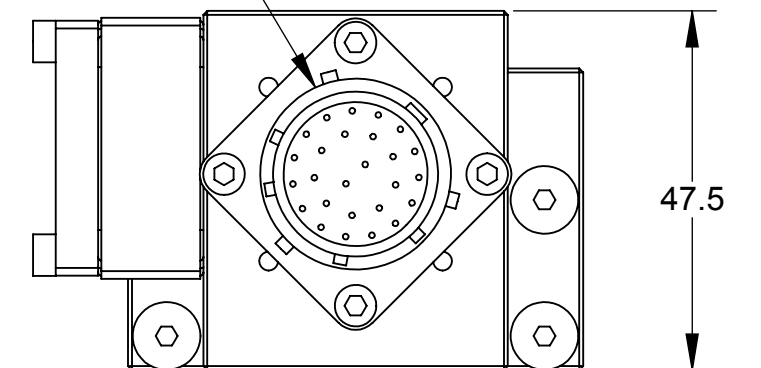

NOTES: UNLESS OTHERWISE SPECIFIED.

DO NOT SCALE DRAWING.
ALL DIMENSIONS ARE IN MILLIMETERS.



3rd ANGLE PROJECTION



1031 Goodworth Drive, Apex, NC 27539, USA
Tel: +1.919.772.0115 Email: info@ati-ia.com
Fax: +1.919.772.8259 www.ati-ia.com
ISO 9001 Registered Company

PROPERTY OF ATI INDUSTRIAL AUTOMATION, INC. NOT TO BE REPRODUCED IN ANY MANNER EXCEPT ON ORDER OR WITH PRIOR WRITTEN AUTHORIZATION OF ATI.

DRAWN BY: P.Sparrow, 3/7/08		TITLE		
CHECKED BY: B.Digeso, 3/7/08		R26R-M with R21-T Module Drawing		
PROJECT #	SHEET 1 OF 2	SCALE	SIZE	DRAWING NUMBER
		1:1	B	9630-20-R26RM R21T
				REVISION
				03

R26R-M
Master Side
(PT02E-16-26P)

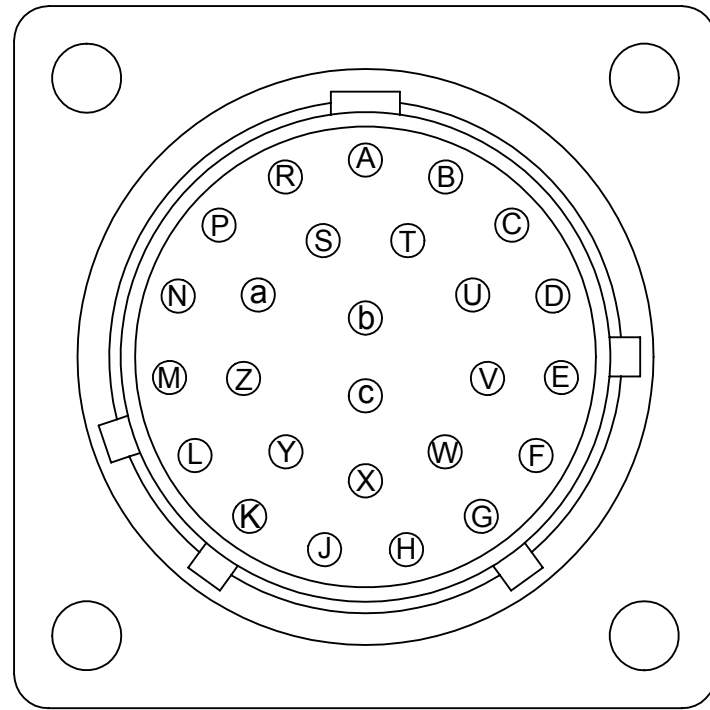

Pin Out

Lock / Unlock Cables	R26R Master PT02E16-26P Male Connector	R21 Tool PT02E16-26S Female Connector
	A ----- >> -----	A
	B ----- >> -----	B
Unlock Signal -----	C -----	C(n/c)
10-30 VDC -----	D -----	D(n/c)
	E ----- >> -----	E
	F ----- >> -----	F
	G ----- >> -----	G
0 VDC -----	H -----	H(n/c)
	J ----- >> -----	J
Lock Signal -----	K -----	K(n/c)
	L ----- >> -----	L
	M ----- >> -----	M
	N ----- >> -----	N
	P ----- >> -----	Switch 1
	R ----- >> -----	
	S ----- >> -----	
	T ----- >> -----	
	U ----- >> -----	
	V ----- >> -----	V
	W ----- >> -----	W
	X ----- >> -----	X
	Y ----- >> -----	Y
	Z ----- >> -----	Z
	a ----- >> -----	a
	b ----- >> -----	b
	c ----- >> -----	c (See Note 2)

R21-T
Tool Side
(PT02E-16-26S)

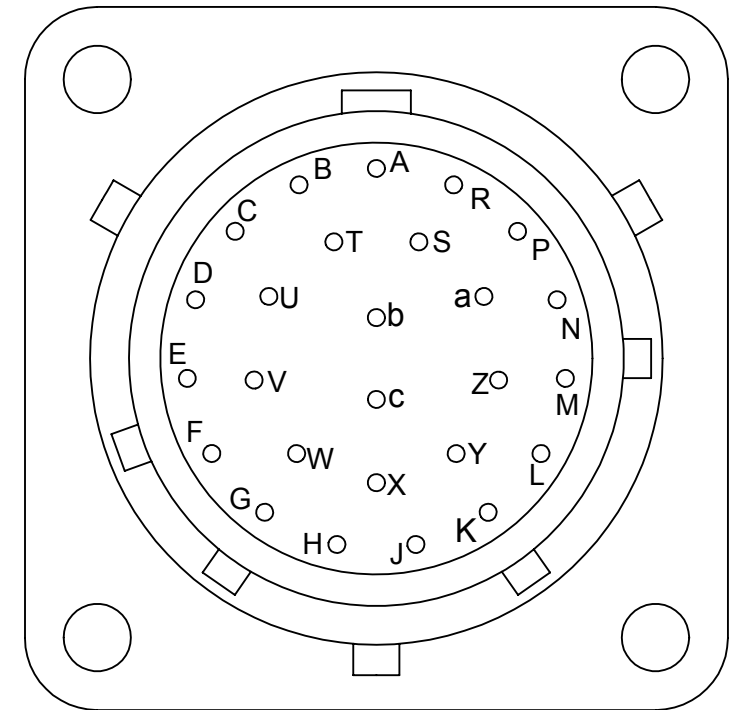

R21-T

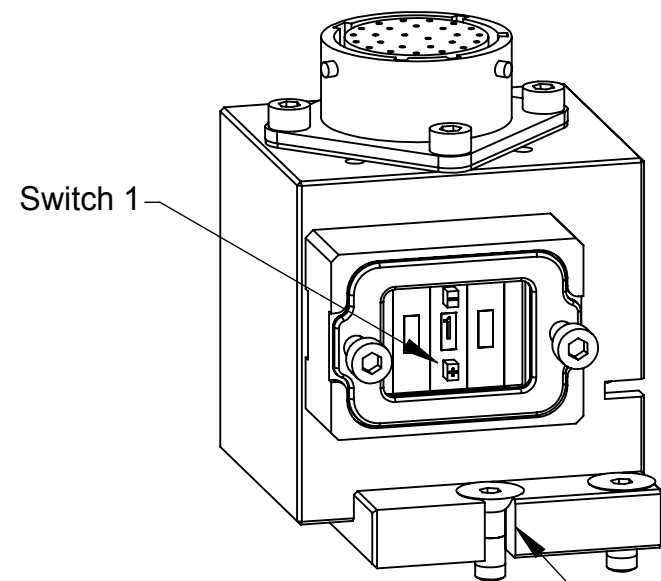

Switch 1

Note 3

Notes:

- Views of connectors are 3:1 scale.
- Pin "c" on the connector is First-to-Mate Last-to-Break at Tool Changer interface. This pin is recommended for use as ground.
- Latest models have a slot added to allow screw to be inserted without removing tool ID housing. A stubby or short arm hex key (non ball end) is required to install the fastener in the slotted location.

Signal Legend

Pin c: 0 VDC (recommended)
Pin U: 5-50 VDC 100mA Max (Tool ID)

Binary Output of Tool ID

Switch Selection	Pin	Pin	Pin	Pin
	P	S	R	T
0	0	0	0	0
1	0	0	0	1
2	0	0	1	0
3	0	0	1	1
4	0	1	0	0
5	0	1	0	1
6	0	1	1	0
7	0	1	1	1
8	1	0	0	0
9	1	0	0	1

NOTES: UNLESS OTHERWISE SPECIFIED.

DO NOT SCALE DRAWING. ALL DIMENSIONS ARE IN MILLIMETERS.



3rd ANGLE PROJECTION



1031 Goodworth Drive, Apex, NC 27539, USA
Tel: +1.919.772.0115 Email: info@ati-ia.com
Fax: +1.919.772.8259 www.ati-ia.com
ISO 9001 Registered Company

PROPERTY OF ATI INDUSTRIAL AUTOMATION, INC. NOT TO BE REPRODUCED IN ANY MANNER EXCEPT ON ORDER OR WITH PRIOR WRITTEN AUTHORIZATION OF ATI.

DRAWN BY: P.Sparrow, 3/7/08

CHECKED BY: B.Digeso, 3/7/08

TITLE

R26R-M with R21-T Module Drawing

PROJECT #

SHEET 2 OF 2

SCALE

1:1

SIZE

B

DRAWING NUMBER

9630-20-R26RM R21T

REVISION

03