

Rev.	Description	Initiator	Date
06	ECO 18032: Sheet 1: Updated "DANGER!" note to newest "Shock Hazard" note. Sheet 2: Added "Tool-ID Switch is rated for 0.1A / 30VDC" note. Updated Notes numbering after changes. Sheet 2: Removed Pin U rating.	TBC	6/27/2019

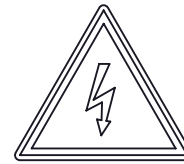

" DANGER!" - Electrical Shock Hazard

This module has a Voltage of 50V or greater, NO contact should be attempted before removing power. This especially includes separation or insertion of the mating connectors or any contact with the tool changer or its components."

R19 Master Module
(9120-R19-M)

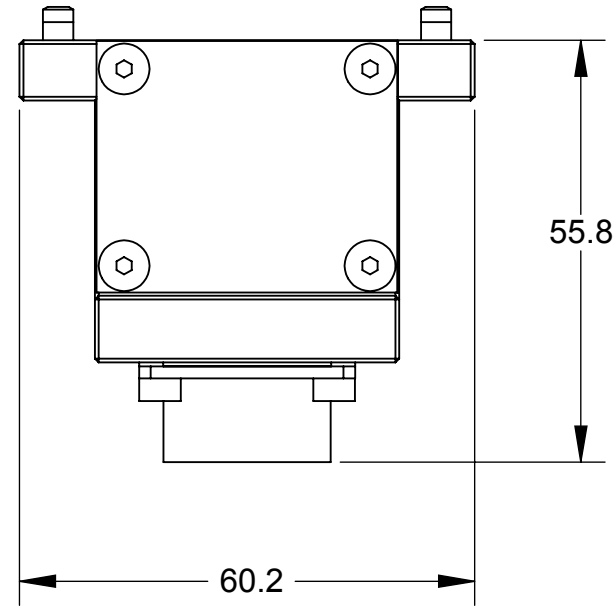

R14 Tool Module
(9120-R14-T)

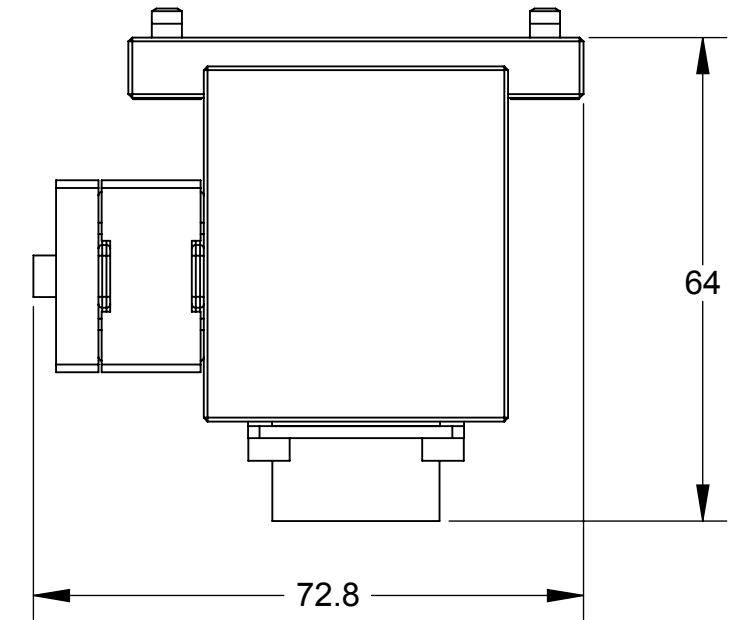

PT02E-14-19P
Male Connector

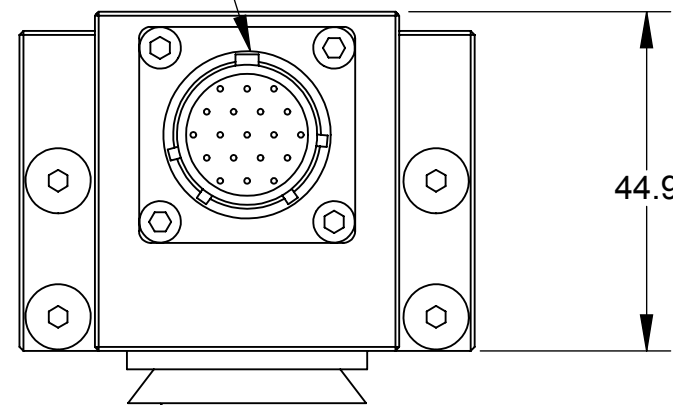

Serviceable Part:
(V-Ring)
4010-0000030-01

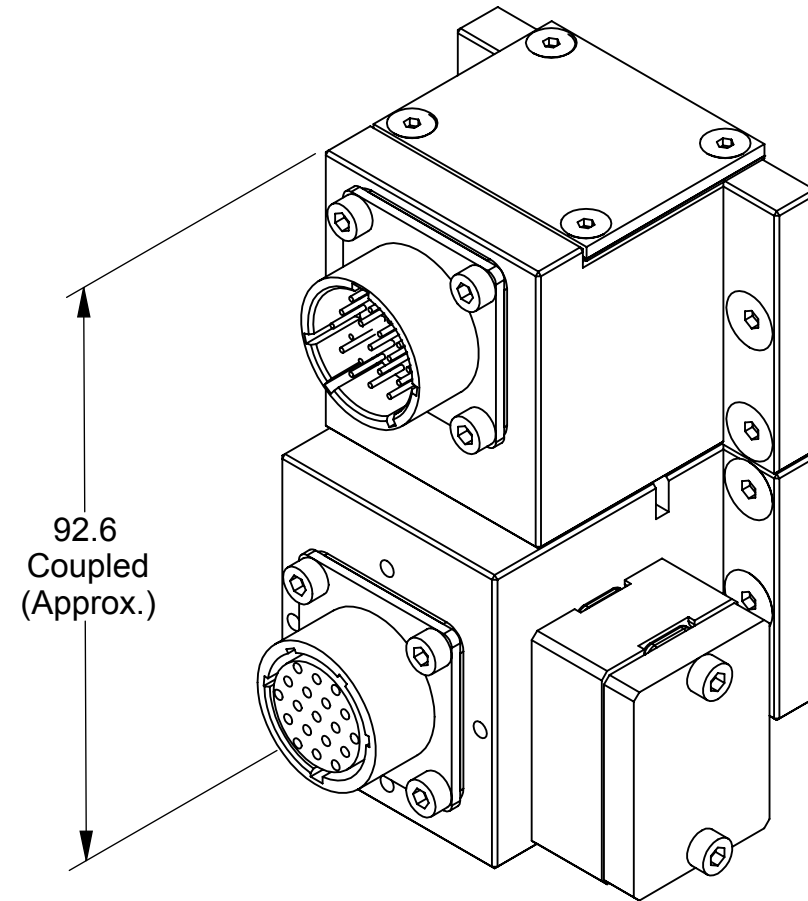

PT02E-14-19S
Female Connector

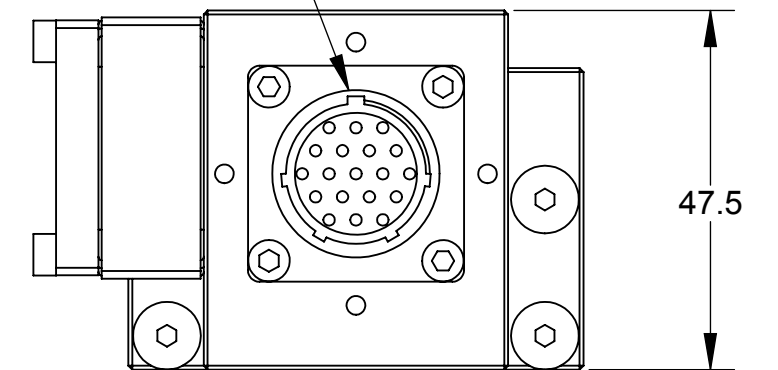

NOTES: UNLESS OTHERWISE SPECIFIED.

DO NOT SCALE DRAWING. ALL DIMENSIONS ARE IN MILLIMETERS.

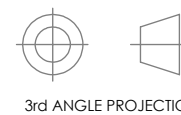

3rd ANGLE PROJECTION



1031 Goodworth Drive, Apex, NC 27539, USA
Tel: +1.919.772.0115 www.ati-ia.com
Fax: +1.919.772.8259 ISO 9001 Registered Company

PROPERTY OF ATI INDUSTRIAL AUTOMATION, INC. NOT TO BE REPRODUCED IN ANY MANNER EXCEPT ON ORDER OR WITH PRIOR WRITTEN AUTHORIZATION OF ATI.

DRAWN BY: P.Sparrow, 9/16/04

CHECKED BY: B.Digeso, 10/29/04

TITLE

R19-M with R14-T Module Drawing

PROJECT # 030725-3

SHEET 1 OF 2

SCALE
1:1

SIZE
B

DRAWING NUMBER
9630-20-R19M R14T

REVISION
06

R19-M
Master Side
(PT02E-14-19P)

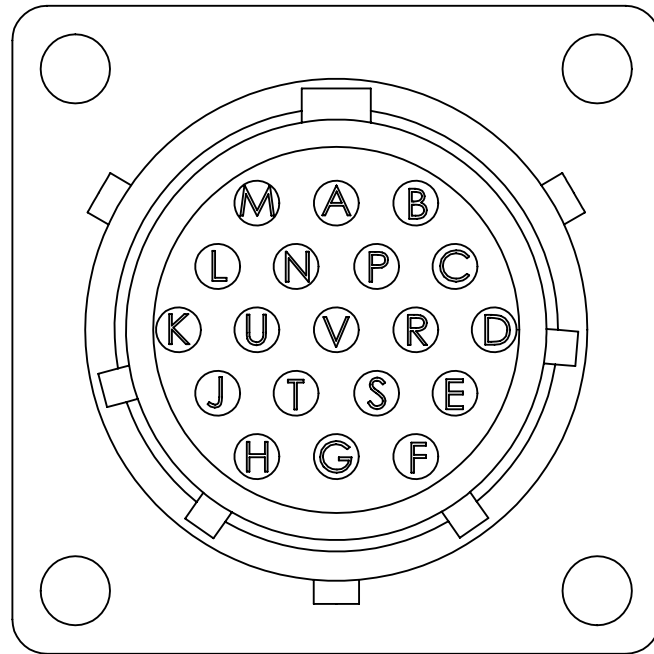

R19 to R14 Pin Out

R19 Master
PT02E-14-19P
Male Connector

R14 Tool
PT02E-14-19S
Female Connector

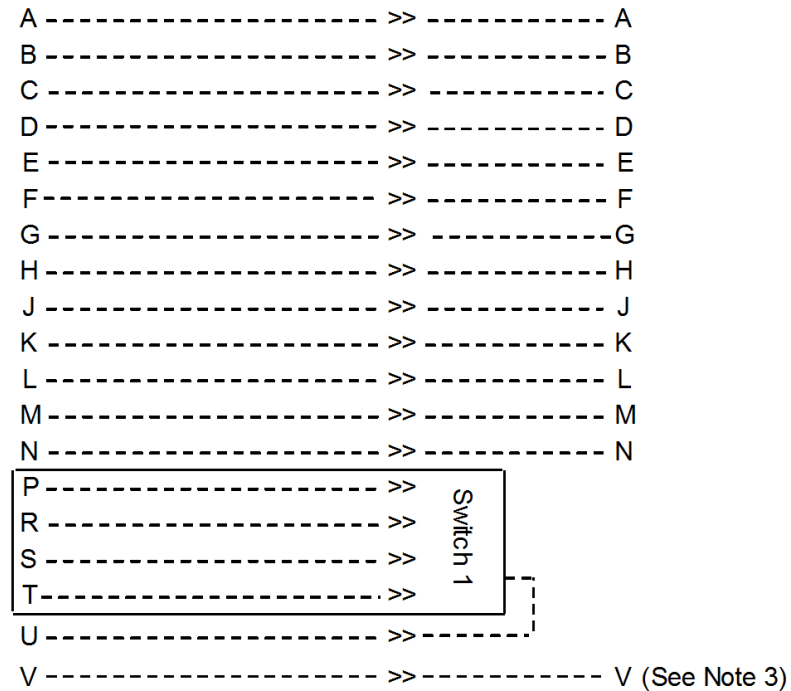

R14-T
Tool Side
(PT02E-14-19S)

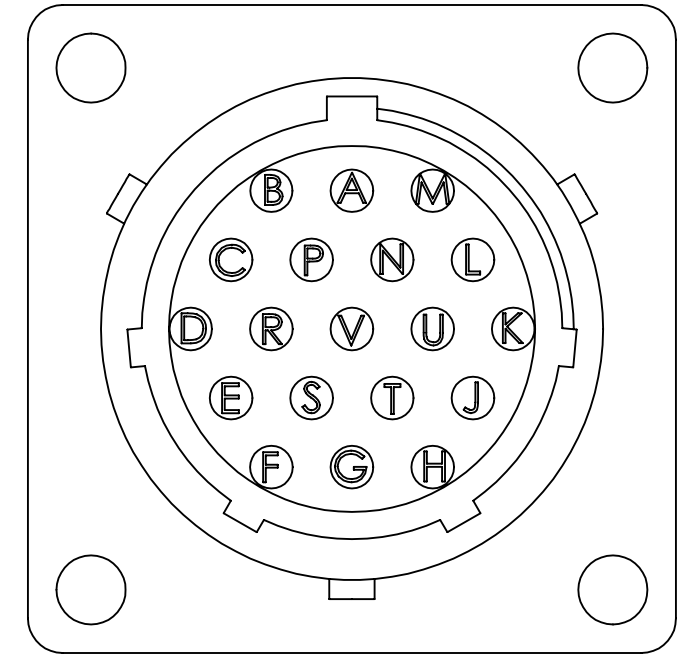

R14-T

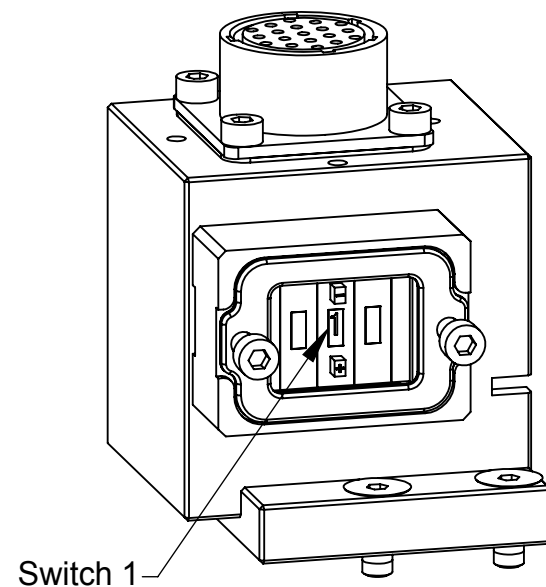

Signal Legend

Pin V: 0 VDC (recommended)
Pin U: Tool ID

Binary Output of Tool ID

Switch Selection	Pin	Pin	Pin	Pin
	P	S	R	T
0	0	0	0	0
1	0	0	0	1
2	0	0	1	0
3	0	0	1	1
4	0	1	0	0
5	0	1	0	1
6	0	1	1	0
7	0	1	1	1
8	1	0	0	0
9	1	0	0	1

Notes:

- Views of connectors are 3:1 scale.
- Tool-ID Switch is rated for 0.1A / 30VDC
- Pin "V" on the amphenol connector is First-to-Mate Last-to-Break at Tool Changer interface. This pin is recommended for use as ground.

NOTES: UNLESS OTHERWISE SPECIFIED.

DO NOT SCALE DRAWING. ALL DIMENSIONS ARE IN MILLIMETERS.

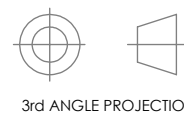

1031 Goodworth Drive, Apex, NC 27539, USA
Tel: +1.919.772.0115 www.ati-ia.com
Fax: +1.919.772.8259 ISO 9001 Registered Company

PROPERTY OF ATI INDUSTRIAL AUTOMATION, INC. NOT TO BE REPRODUCED IN ANY MANNER EXCEPT ON ORDER OR WITH PRIOR WRITTEN AUTHORIZATION OF ATI.

DRAWN BY: P.Sparrow, 9/16/04

CHECKED BY: B.Digeso, 10/29/04

TITLE
R19-M with R14-T Module Drawing

PROJECT # 030725-3 SHEET 2 OF 2

SCALE	SIZE	DRAWING NUMBER	REVISION
1:1	B	9630-20-R19M R14T	06