

" DANGER!" - Electrical Shock Hazard

This module has a Voltage of 50V or greater, NO contact should be attempted before removing power. This especially includes separation or insertion of the mating connectors or any contact with the tool changer or its components."

9128-PY41-M  
Master Module

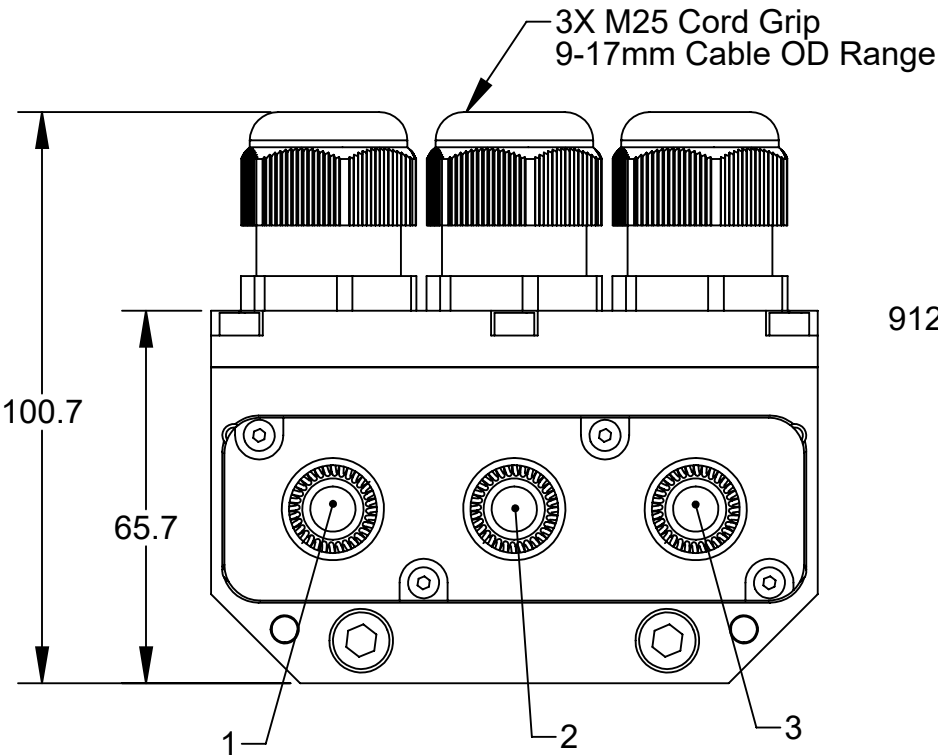
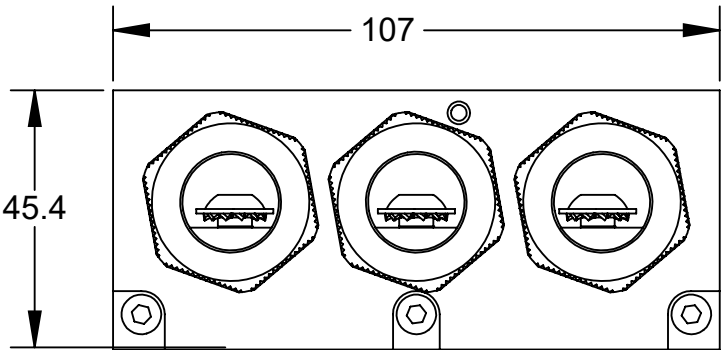

9128-PY41-M

9128-PY41-T

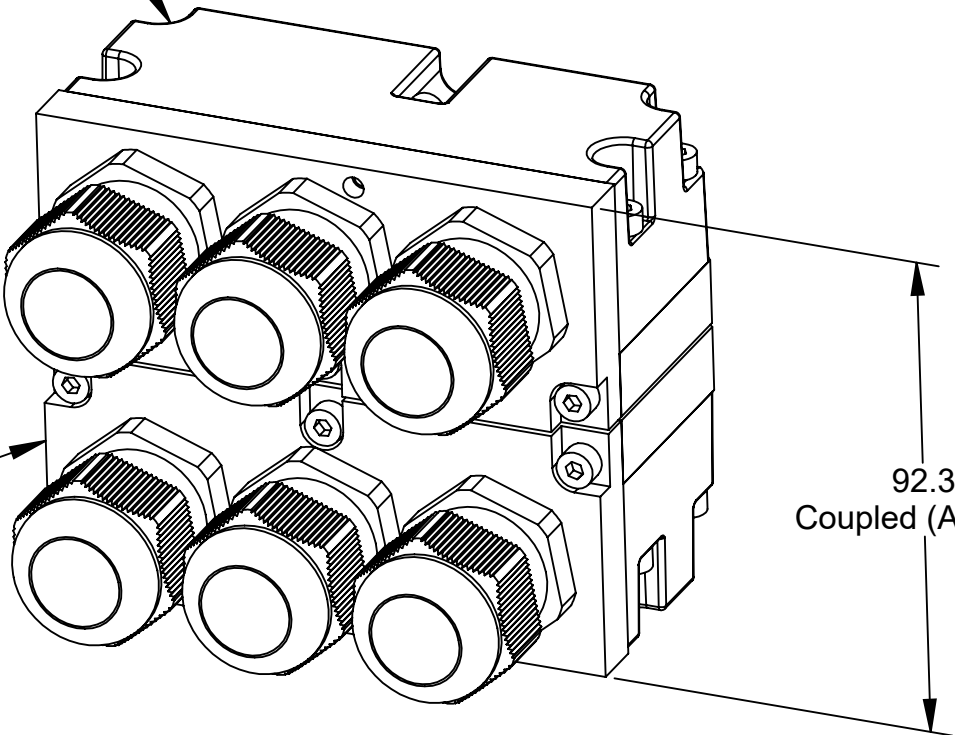

9128-PY41-T  
Tool Module

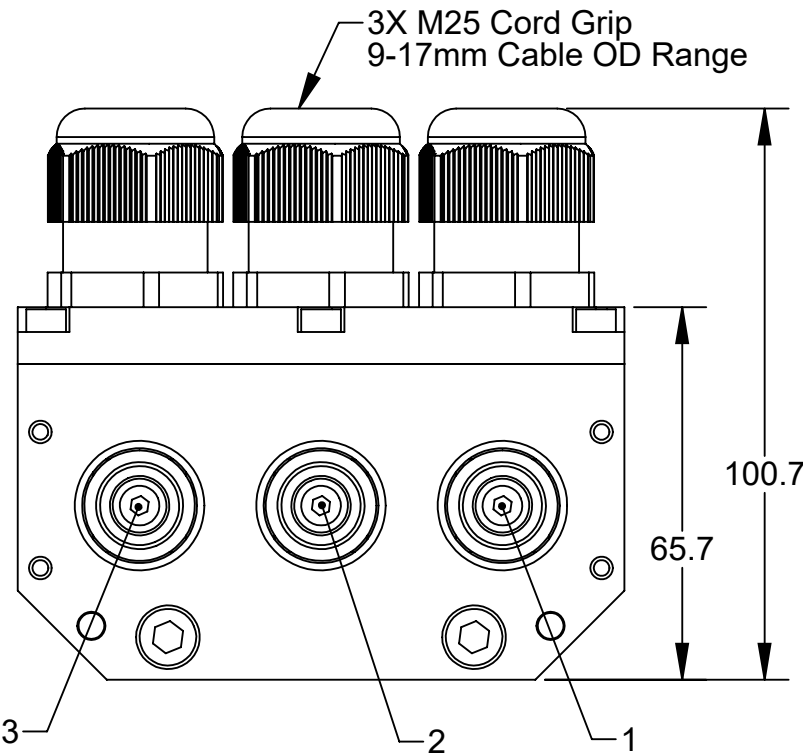
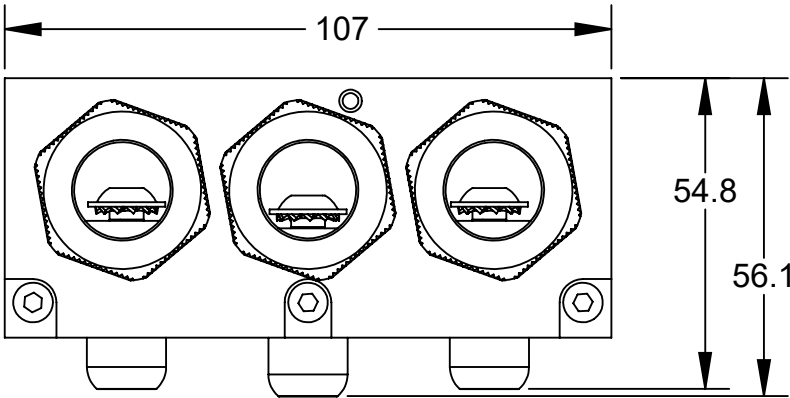

Notes:

1. Pin 2 is first-to-mate, last-to-break at the tool changer interface and is recommended as PE.
2. Module is rated to a maximum continuous ambient temperature of 70°F.
3. The above ratings are valid for frequencies up to 1 kHz and with all contacts energized. Contact ATI for ratings at additional temperatures.
4. Module is rated for 1000VAC, pollution degree III.
5. See Sheet 2 for Installation and Maintenance information.
6. The electrical modules are not a switch and MUST NOT be used as a switch.
7. Do not couple or uncouple the modules unless power has been disconnected and discharged both upstream and downstream. Failure to do so can result in severe module damage or personal injury.
8. The installation of over-current protection is recommended.

REV.	DESCRIPTION	INITIATOR	DATE
05	ECO 21456; Sht 2, Changed mounting screw from "Pre" to 222 and from -15A to -15	LJH	7/14/23

NOTES: UNLESS OTHERWISE SPECIFIED.

DO NOT SCALE DRAWING. ALL DIMENSIONS ARE IN MILLIMETERS.

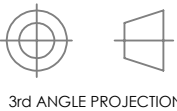

3rd ANGLE PROJECTION



1031 Goodworth Drive, Apex, NC 27539, USA  
Tel: +1.919.772.0115 www.ati-ia.com  
Fax: +1.919.772.8259 ISO 9001 Registered Company

PROPERTY OF ATI INDUSTRIAL AUTOMATION, INC. NOT TO BE REPRODUCED IN ANY MANNER EXCEPT ON ORDER OR WITH PRIOR WRITTEN AUTHORIZATION OF ATI.

DRAWN BY: D. Simons, 7/8/20		TITLE  PY41 Master and Tool Customer Drawing			
CHECKED BY: W. Berrocal, 8/27/20					
PROJECT # 180906-2		SCALE 3:4	SIZE B	DRAWING NUMBER 9630-20-PY41	REVISION 05
SHEET 1 OF 2					

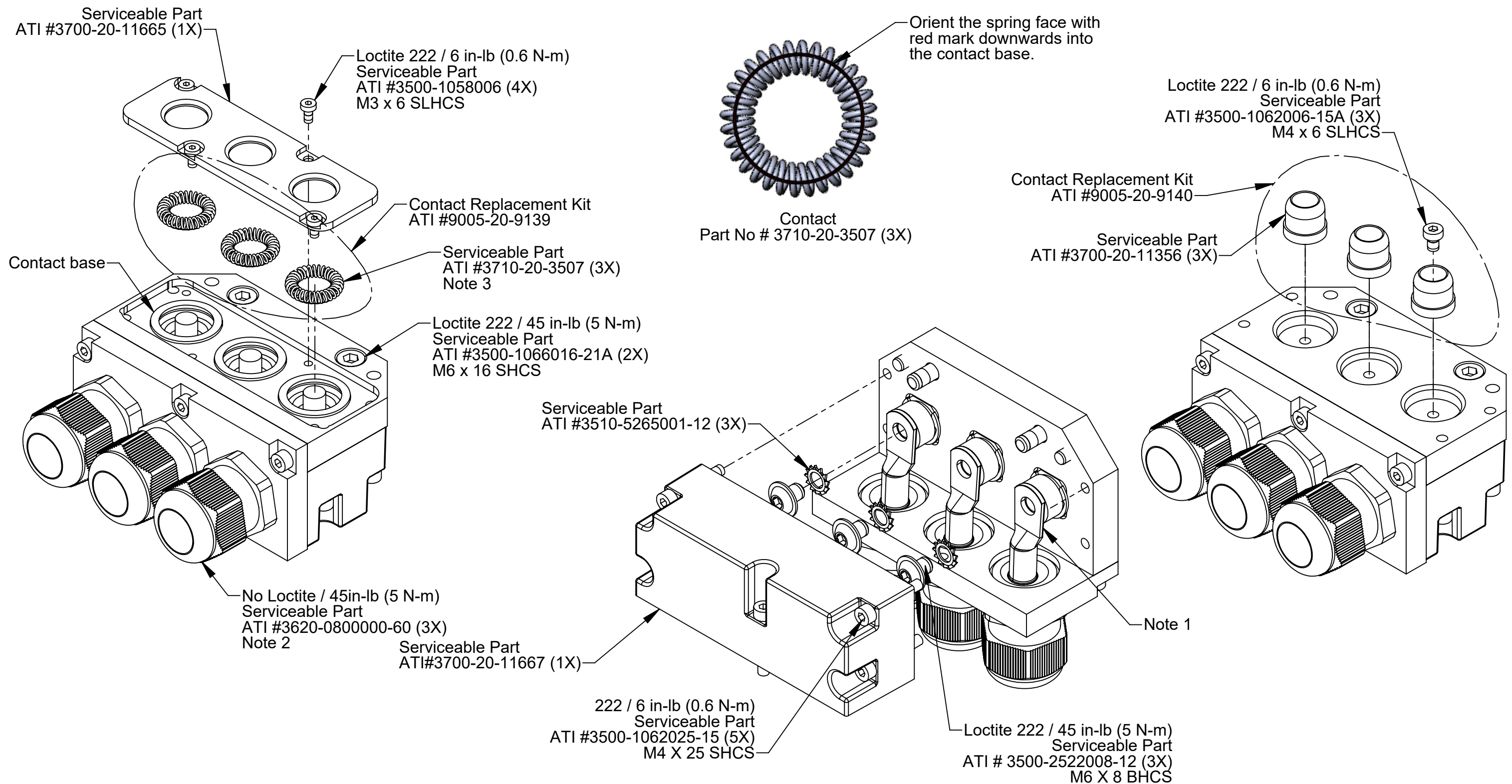

#### Notes:

- Master and Tool modules are supplied with ring terminals for 4 AWG/25mm<sup>2</sup> and 2 AWG/35mm<sup>2</sup> wire. Contact ATI for compatible ring terminals in other wire sizes.
- Cord grips are supplied with an inner reducer bushing installed for smaller cable diameters. For larger cable diameters, remove the inner reducer bushing.
- Use of ATI #0290-70-0000-70-016 dielectric grease is recommended during spring replacement.

NOTES: UNLESS OTHERWISE SPECIFIED.

DO NOT SCALE DRAWING.  
ALL DIMENSIONS ARE IN  
MILLIMETERS.

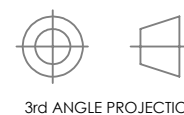

1031 Goodworth Drive, Apex, NC 27539, USA  
Tel: +1.919.772.0115 www.ati-ia.com  
Fax: +1.919.772.8259 ISO 9001 Registered Company

PROPERTY OF ATI INDUSTRIAL AUTOMATION, INC. NOT TO BE REPRODUCED IN ANY MANNER EXCEPT ON ORDER OR WITH PRIOR WRITTEN AUTHORIZATION OF ATI.

DRAWN BY: D. Simons, 7/8/20

CHECKED BY: W. Berrocal, 8/27/20

TITLE

PY41 Master and Tool Customer Drawing

PROJECT # 180906-2

SHEET 2 OF 2

SCALE  
3:4

SIZE  
B

DRAWING NUMBER  
9630-20-PY41

REVISION  
05