

PROPERTY OF ATI INDUSTRIAL AUTOMATION, INC.  
 NOT TO BE REPRODUCED IN ANY MANNER EXCEPT ON  
 ORDER OR WITH PRIOR WRITTEN AUTHORIZATION OF ATI.

Rev.	Description	Initiator	Date
02	Initial Issue	DSS	10/5/2004

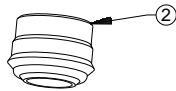
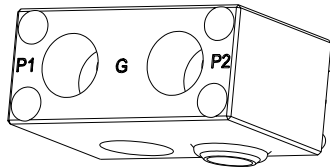
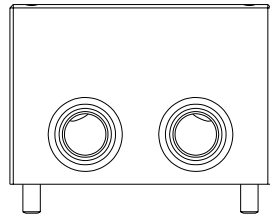
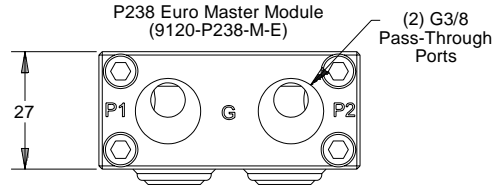

P238-M-E Serviceable Parts

ITEM NO.	QTY.	PART NUMBER	DESCRIPTION
1	2	3700-20-2000	Collar for 3/8" Bushing
2	2	4010-0000010-01	3/8" Rubber Bushing, Nitrile

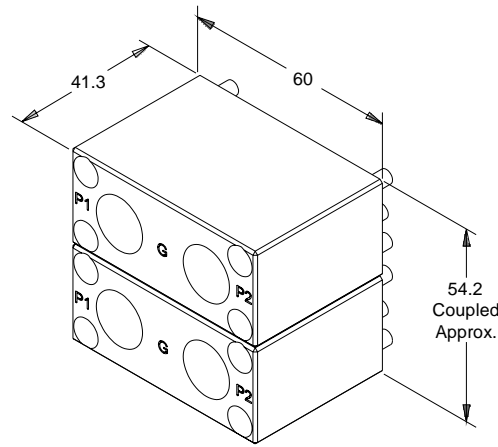

Notes:  
 Material of Construction:  
 1. Housing: Aluminum  
 2. Other: Nitrile & Brass

Operation:  
 1. Pneumatic Operation only.  
 2. For optimum performance inspect mating surfaces regularly to ensure they are free of debris.

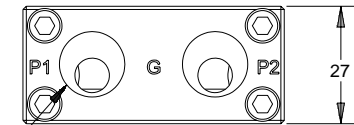
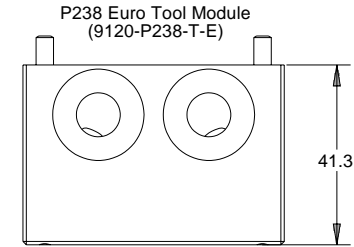

(2) G3/8  
 Pass-Through  
 Ports

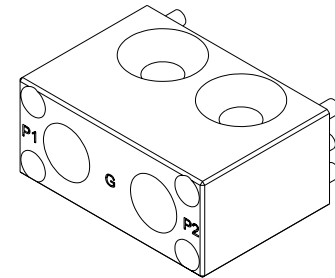

P238-T-E No Serviceable Parts

NOTES: UNLESS OTHERWISE SPECIFIED  
 DO NOT SCALE DRAWING. DRAWN IN SOLIDWORKS.  
 ALL DIMENSIONS ARE IN MILLIMETERS.

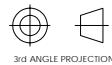

3rd ANGLE PROJECTION



1031 Goodworth Drive, Apex, NC 27539, USA  
 Tel: +1.919.772.0115 Email: info@ati-ia.com  
 Fax: +1.919.772.8259 www.ati-ia.com  
 ISO 9001 Registered Company

DRAWN BY: D. Swanson 10/5/04	TITLE: P238 Euro Module Drawing		
CHECKED BY: P. Sparrow 10/5/04	SCALE: 1:1	SIZE: B	DRAWING NUMBER: 9630-20-P238-E-02
WEIGHT LBS: 0.63	PRODUCT RELEASE # 030725-3 DATE: SHEET 1 OF 1		
ASSEMBLY REF:			