

Rev.	Description	Initiator	Date
01	Initial Issue	DSS	10/28/2009

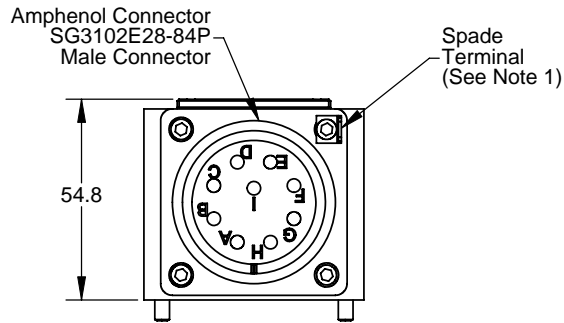

MTS9 Pin Out	
MTS9 Master SG3102E28-84P Male Connector	MTS9 Tool SG3102E28-84S Female Connector
A	A
B	B
C	C
D	D
E	E
F	F
G	G
H	H
I	I

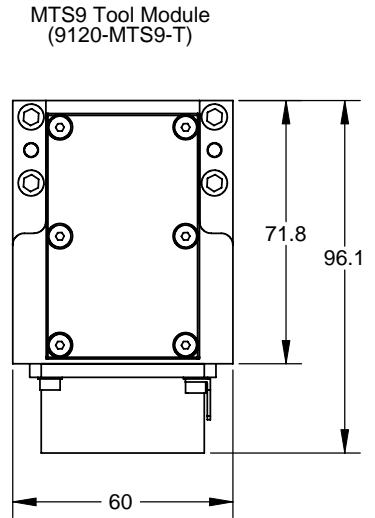
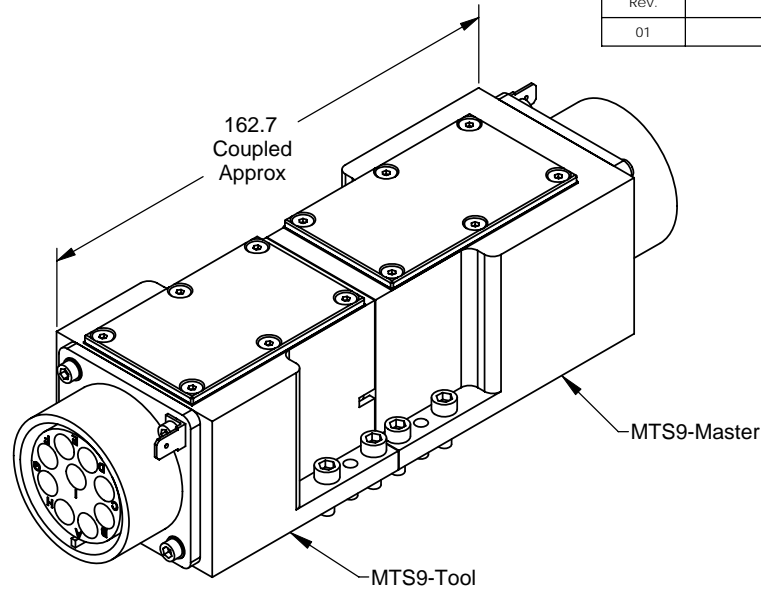
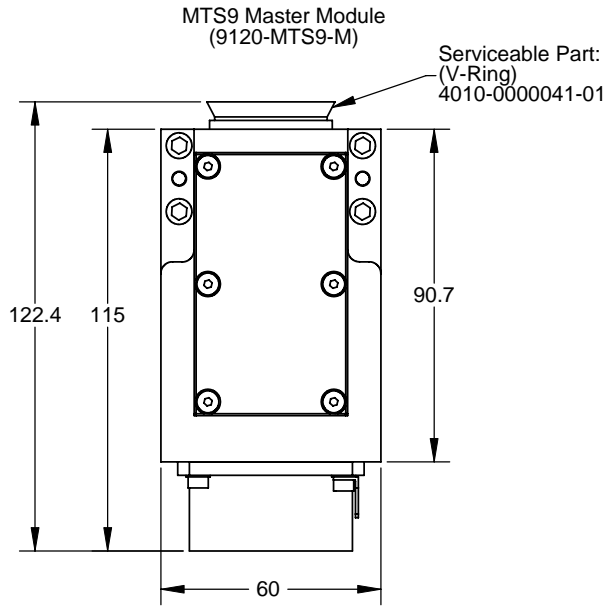
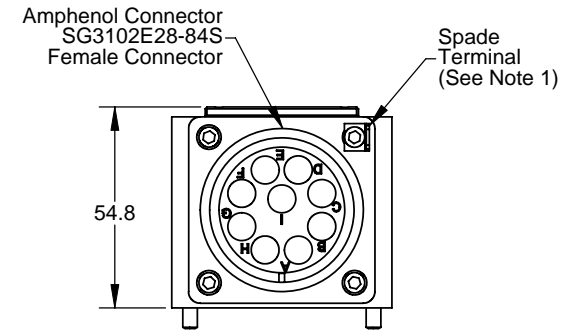

- Notes:**
- Spade terminal connection is First-to-mate Last-to-break at the Tool Changer interface. Spade terminals provided for passing PE from master module to tool module.
 - Modules should be mounted to a tool changer, QC-100 or larger, to handle maximum rated current and 100% duty cycle without overheating. Allowable maximum ambient temperature under these conditions is 100 F.
 - DANGER!** - For electrical modules using > 60 VDC or 42 VAC, NO contact should be attempted before removing power. This especially includes separation or insertion of the mating connectors or any contact with the tool changer or its' components.

NOTES: UNLESS OTHERWISE SPECIFIED
DO NOT SCALE DRAWING. DRAWN IN SOLIDWORKS.
ALL DIMENSIONS ARE IN MILLIMETERS.

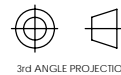

1031 Goodworth Drive, Apex, NC 27539, USA
Tel: +1.919.772.0115 Email: info@ati-ia.com
Fax: +1.919.772.8259 www.ati-ia.com
ISO 9001 Registered Company

PROPERTY OF ATI INDUSTRIAL AUTOMATION, INC. NOT TO BE REPRODUCED IN ANY MANNER EXCEPT ON ORDER OR WITH PRIOR WRITTEN AUTHORIZATION OF ATI.

DRAWN BY: D. Swanson 10/28/09		TITLE: MTS9 Module Drawing	
CHECKED BY: DKL/DTM 10/29/09		SCALE: 3:4	SIZE: B
WEIGHT LBS:		DRAWING NUMBER: 9630-20-MTS9	
ASSEMBLY REF:		PRODUCT RELEASE #	REVISION: 01
		DATE:	SHEET 1 OF 1