

Rev.	Description	Initiator	Date
03	ECO 18784: Sheet 1: Added 3490-0010005-01 to BOM Table. Lower left views: (50) was 14 & (59) was 28.9.	TBC	3/7/2020

Valve Adapters with Double Solenoid and 1/4" NPT Air Port

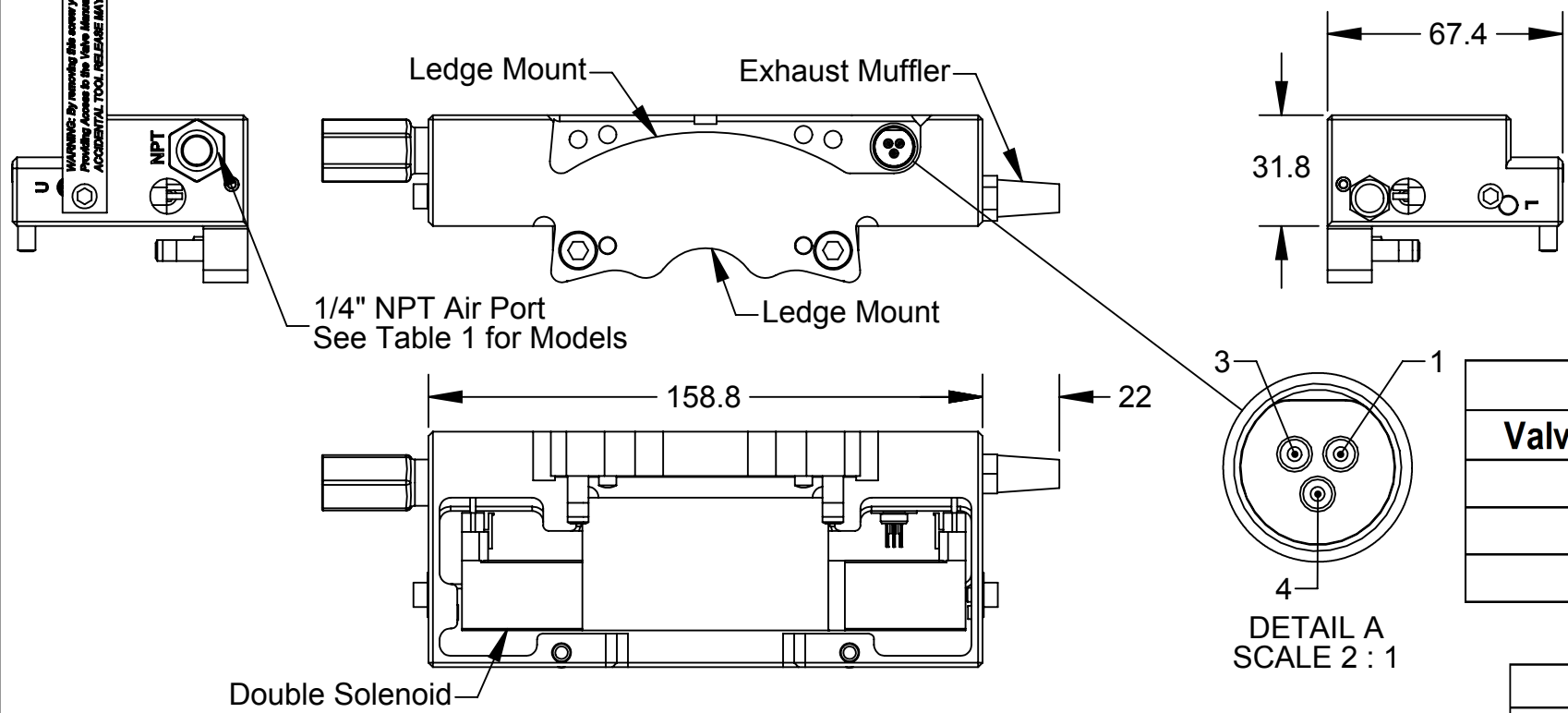
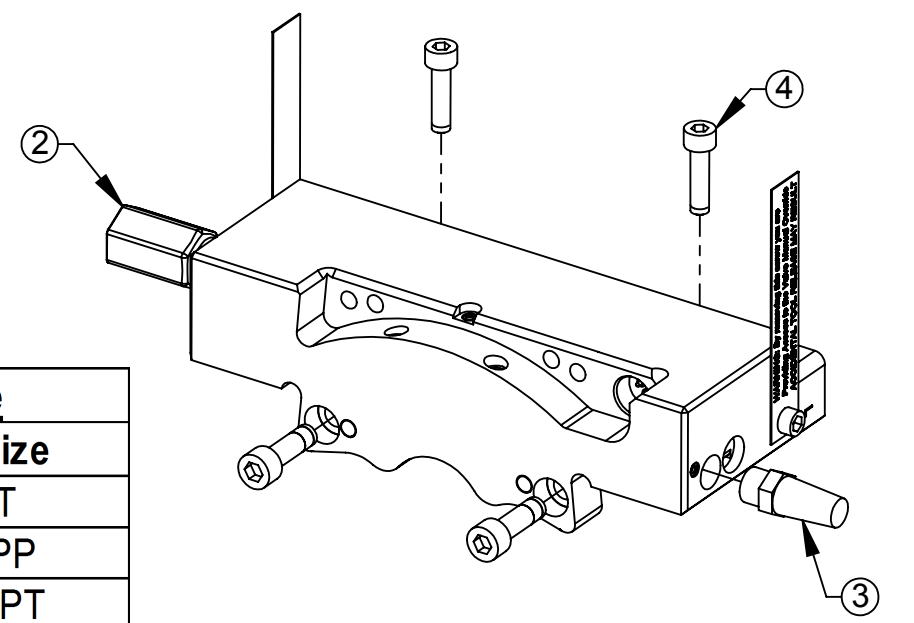

Table 1: Valve Adapter Port Size

Valve Adapter Model	Air Port Size
9121-JT3-M	1/4" NPT
9121-JU3-M	G 1/4 BSPP
9121-JP5-M	Rc 1/4 BSPT

Table 2: 3-Pin Valve Pin Block Signals

Pin	Signal	Wire
1	Unlatch (+19-29 VDC)	Brown
3	0 VDC	Blue
4	Latch (+19-29 VDC)	Black



Valve Adapters with Double Solenoids and G 1/4 (BSPP) Air Ports

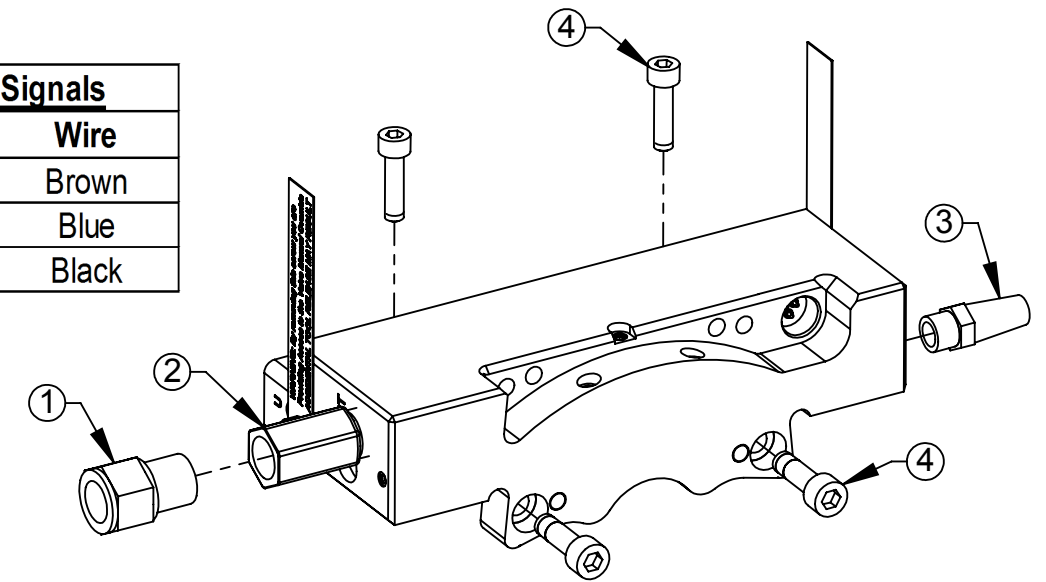
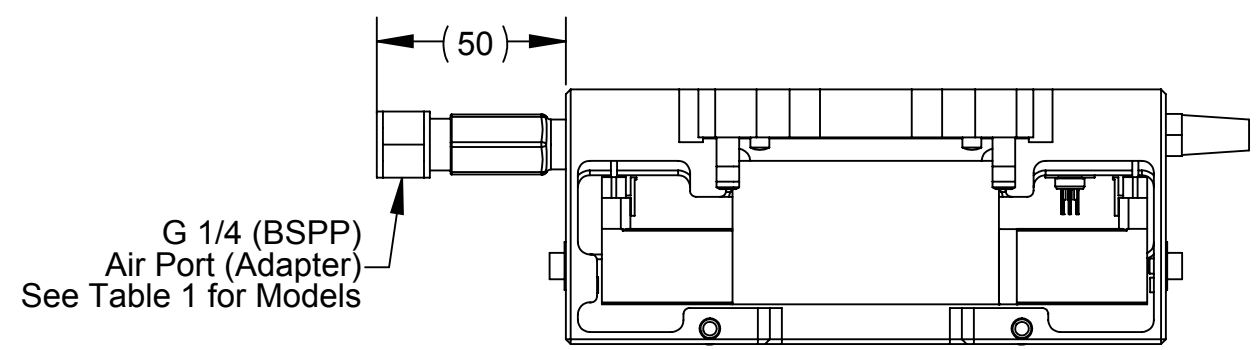

Valve Adapters with Double Solenoids and Rc 1/4 (BSPT) Air Ports

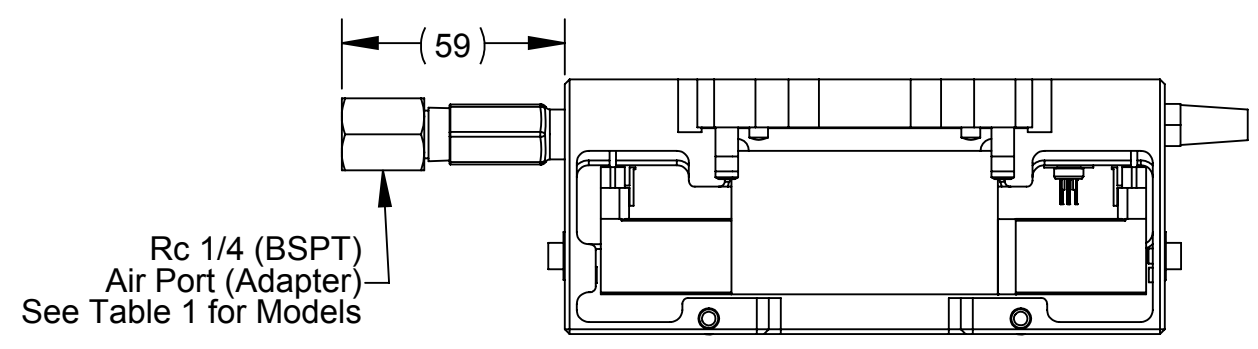

ITEM NO.	QTY	PART NUMBER	DESCRIPTION
1	1	3405-1030005-01	Fitting, Adapter, 1/4NPT to G1/4
	1	3405-1030008-01	Adapter, 1/4 NPT Male x Rc 1/4 Female
2	1	3490-0010005-01	Air Filter, 1/4 NPT Male X 1/4 NPT Female
3	1	3490-1010002-00	Conical Breather 1/8 NPT
4	2	3500-1066020-15A	M6-1 x 20mm SHCS, Blue, Pre-Applied

- Notes:
- Valve Adapter to Tool Changer mounting is shown on Sheet 2.
 - Pneumatic and Electrical Schematic are shown on Sheet 3.
 - Other models are covered in the 9620-20-C-Jxx Valve adapter with a Double Solenoid with Valve Pass Through manual.

NOTES: UNLESS OTHERWISE SPECIFIED.
DO NOT SCALE DRAWING. ALL DIMENSIONS ARE IN MILLIMETERS.



1031 Goodworth Drive, Apex, NC 27539, USA
Tel: +1.919.772.0115 Email: info@ati-ia.com
Fax: +1.919.772.8259 www.ati-ia.com
ISO 9001 Registered Company

PROPERTY OF ATI INDUSTRIAL AUTOMATION, INC. NOT TO BE REPRODUCED IN ANY MANNER EXCEPT ON ORDER OR WITH PRIOR WRITTEN AUTHORIZATION OF ATI.

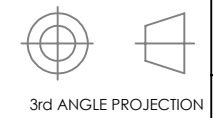

DRAWN BY: J. Handy, 1/7/16		TITLE	
CHECKED BY: W Berrocal, 9/8/16		QC-310 Valve Adapter with Double solenoid, Valve Pass Through	
PROJECT #	SHEET 1 OF 3	SCALE	SIZE
		1:2	B
DRAWING NUMBER		REVISION	
9630-20-Jxx Dou Sol Pas Thru QC310		03	

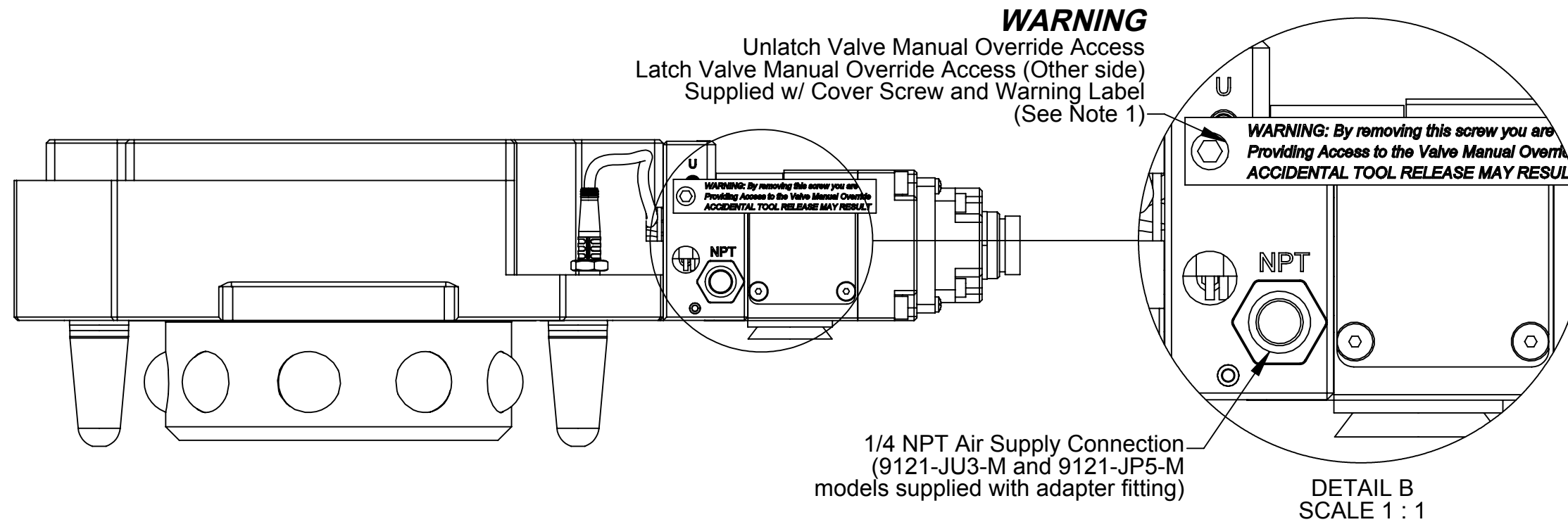

The valve adapter and control/signal module are mounted to Flat A on the Tool Changer

The Integrated Sensor Cables for Locked, Unlocked and Ready-to-Lock inputs are supplied with the base tool changer package.

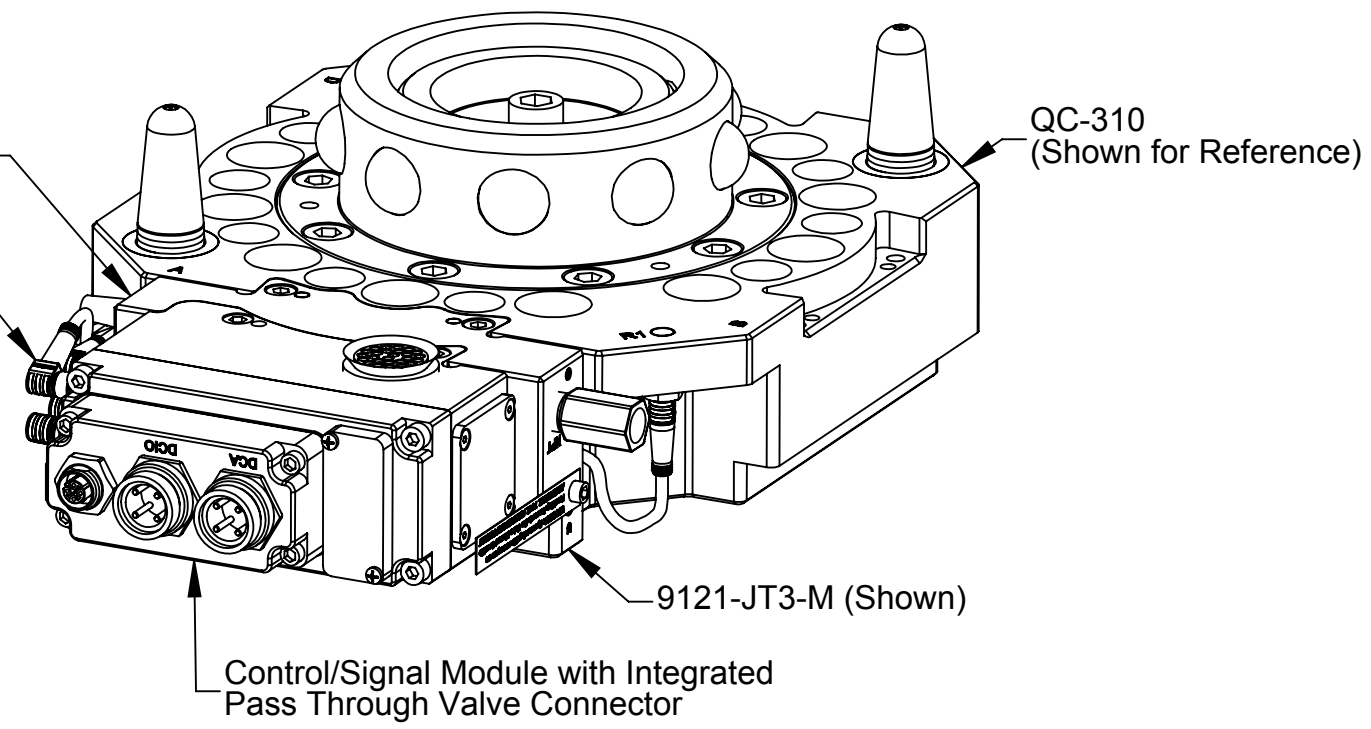

Notes:

1. **WARNING:** Tool Release Will Occur with actuation of the Unlatch Valve Manual Override. Use of the valve manual override is restricted to contingency situations. The tool changer and associated tool should be in a stand or storage location prior to actuation of the manual override.

NOTICE: Actuation of valve override buttons requires very little travel (~1mm) and only a small amount of force. Applying excess force can damage the solenoid or cause override button to stick in one position. Use non-sharp object, similar to ball nose 2mm Allen key, to gently depress the override button; an air release should be heard when the solenoid is activated.

- 2. The valve adapters with double solenoid are designed to mount to QC-310, QC-313, QC-510, and QC-1210 Tool Changers.
- 3. The valve adapters with double solenoid and valve pass through connectors are designed to be integrated with specific models of control/signal modules with an integrated pass through valve connector.

NOTES: UNLESS OTHERWISE SPECIFIED.				1031 Goodworth Drive, Apex, NC 27539, USA Tel: +1.919.772.0115 Email: info@ati-ia.com Fax: +1.919.772.8259 www.ati-ia.com ISO 9001 Registered Company	
DO NOT SCALE DRAWING. ALL DIMENSIONS ARE IN MILLIMETERS.				PROPERTY OF ATI INDUSTRIAL AUTOMATION, INC. NOT TO BE REPRODUCED IN ANY MANNER EXCEPT ON ORDER OR WITH PRIOR WRITTEN AUTHORIZATION OF ATI.	
DRAWN BY: J. Handy, 1/7/16		TITLE		QC-310 Valve Adapter with Double solenoid, Valve Pass Through	
CHECKED BY: W Berrocal, 9/8/16		SCALE		1:2	
PROJECT #		SHEET 2 OF 3		DRAWING NUMBER	
3rd ANGLE PROJECTION		B		9630-20-Jxx Dou Sol Pas Thru QC310	
				REVISION	
				03	

Double Solenoid shown with Energized Lock Solenoid (L2)

Electrical Schematic

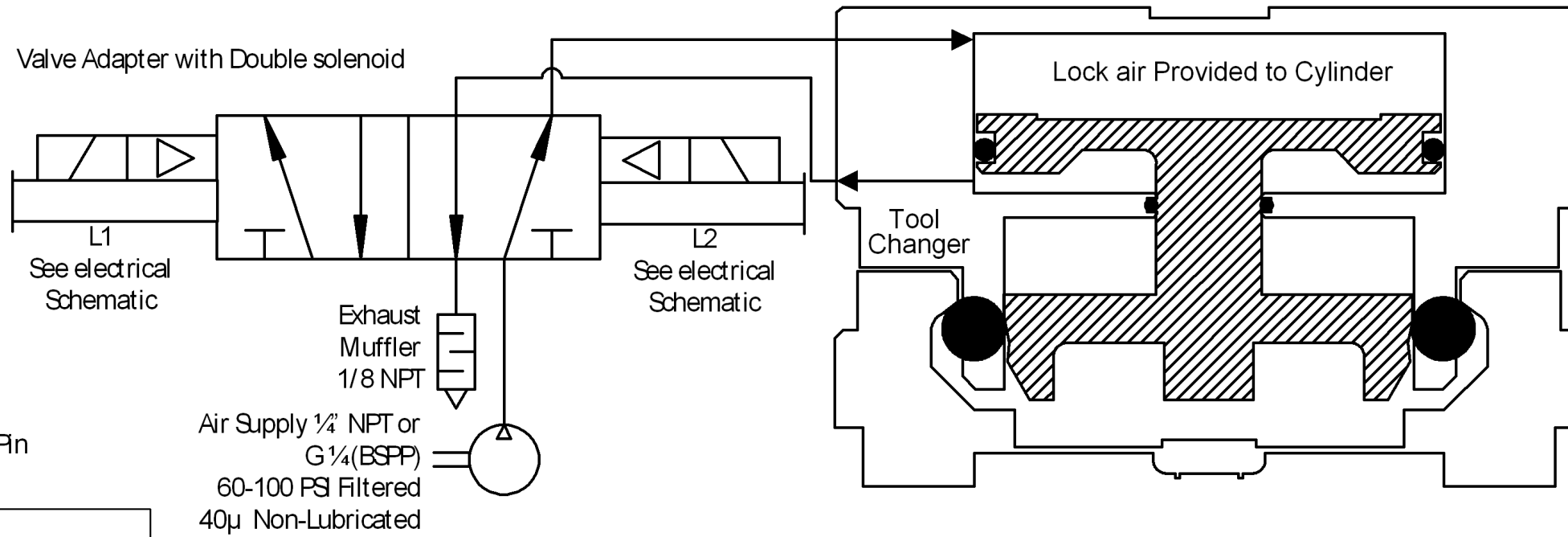
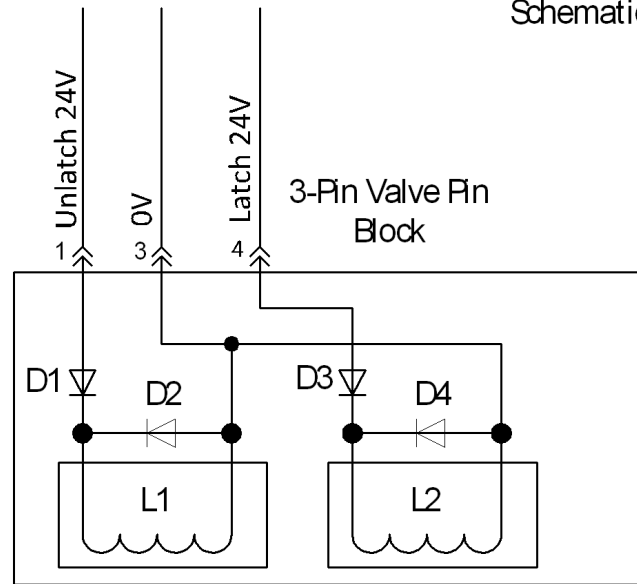

Double Solenoid shown with Energized Unlock Solenoid (L1)

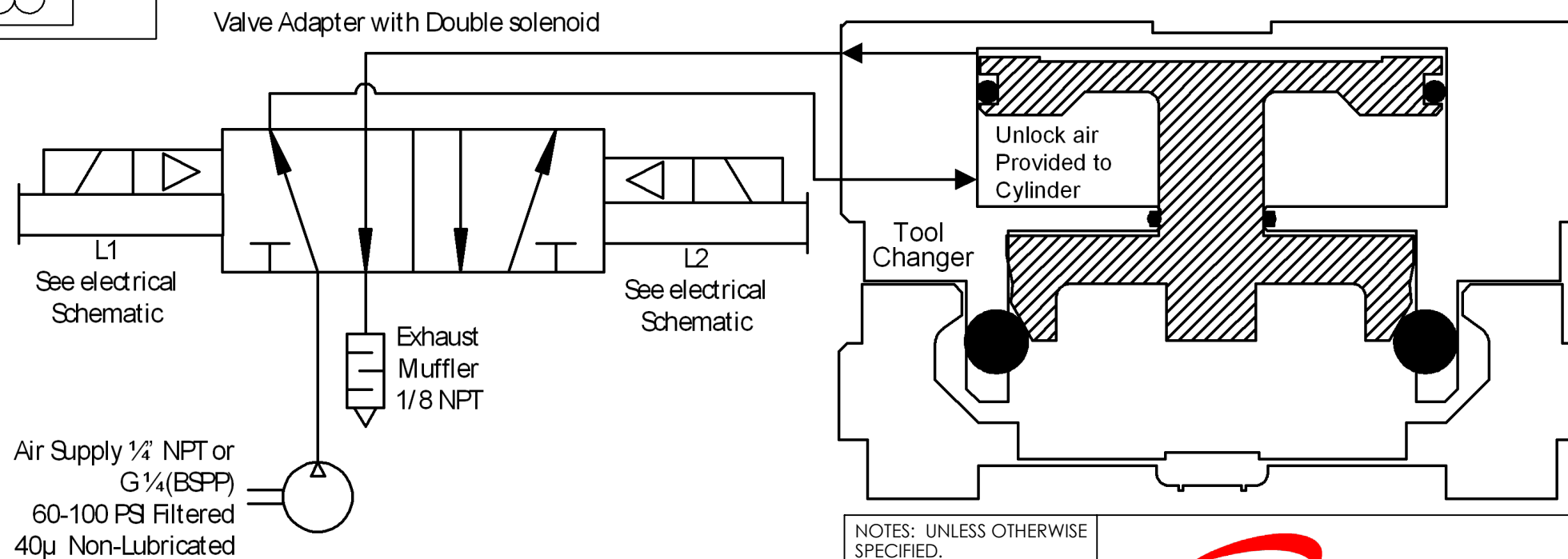

Notes:

- The valve adapters utilize a double solenoid 5/2 valve. The valve requires supply voltage between 19-29V. The Valve CV is 1.1.
- The valve must be supplied clean, dry, non-lubricated air at 60 to 100 psi (4.1-6.9 Bar) and filtered at 40 microns or better. The valve will NOT operate correctly if insufficient air pressure is supplied.
- It is critical that the exhaust mufflers are not restricted. As part of a preventative maintenance program, periodically inspect and/or replace the exhaust mufflers.

NOTES: UNLESS OTHERWISE SPECIFIED.

DO NOT SCALE DRAWING. ALL DIMENSIONS ARE IN MILLIMETERS.



3rd ANGLE PROJECTION



1031 Goodworth Drive, Apex, NC 27539, USA
 Tel: +1.919.772.0115 Email: info@ati-ia.com
 Fax: +1.919.772.8259 www.ati-ia.com
 ISO 9001 Registered Company

PROPERTY OF ATI INDUSTRIAL AUTOMATION, INC. NOT TO BE REPRODUCED IN ANY MANNER EXCEPT ON ORDER OR WITH PRIOR WRITTEN AUTHORIZATION OF ATI.

DRAWN BY: J. Handy, 1/7/16		TITLE	
CHECKED BY: W Berrocal, 9/8/16		QC-310 Valve Adapter with Double solenoid, Valve Pass Through	
PROJECT #	SHEET 3 OF 3	SCALE	REVISION
		1:5	B
DRAWING NUMBER		9630-20-Jxx Dou Sol Pas Thru QC310	