

Rev.	Description	Initiator	Date
04	ECO 15118; Updated model to reflect new Master Side BOM structure and to add "Other sensors..." to Note 2.	SZJ	2/2/2017

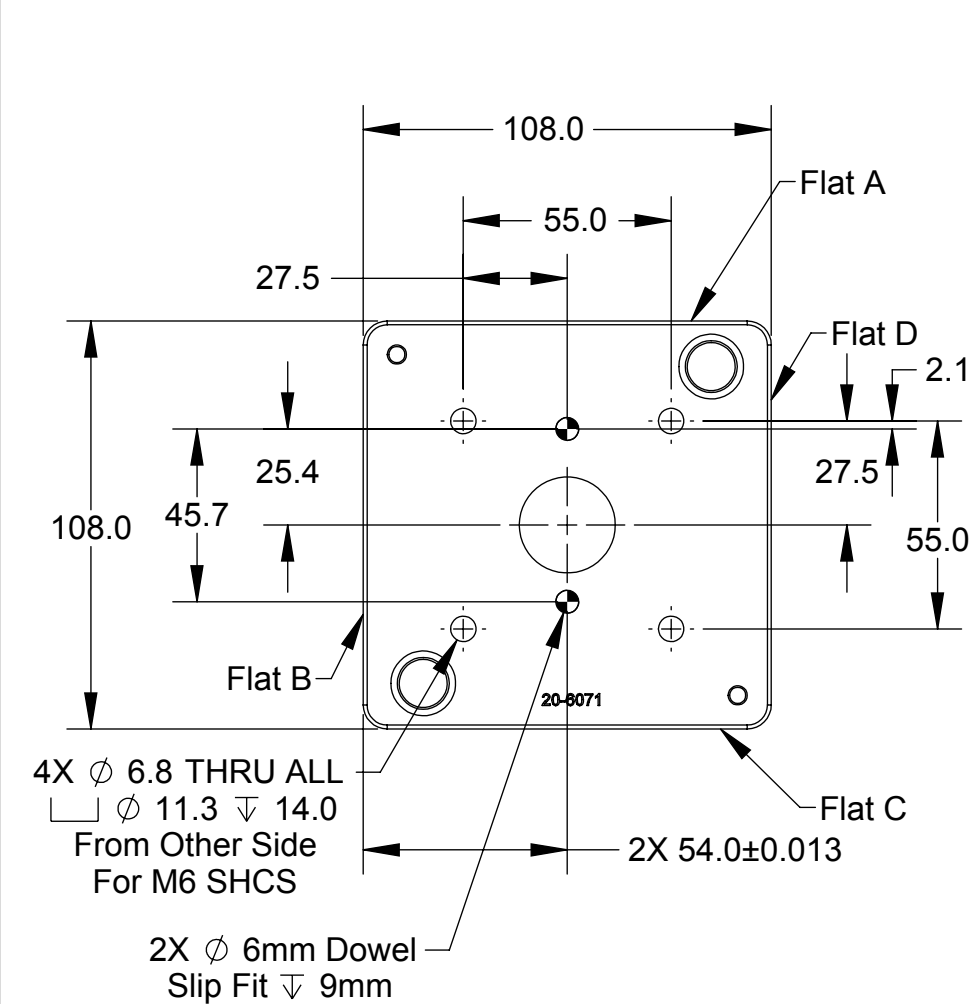

Tool Side View

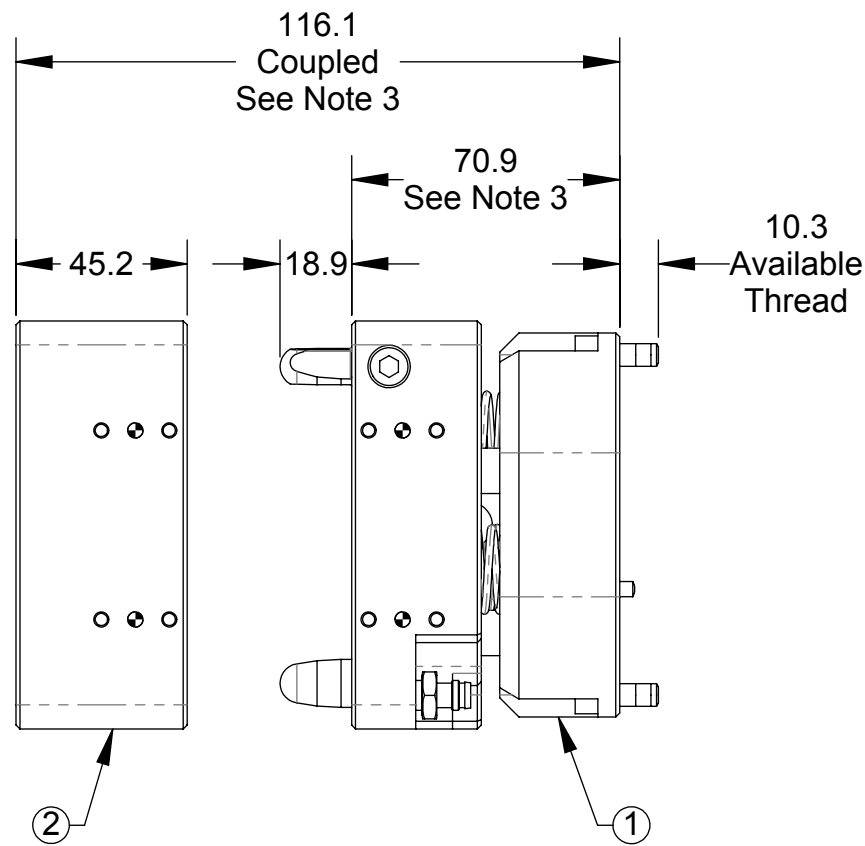

Side View, Uncoupled

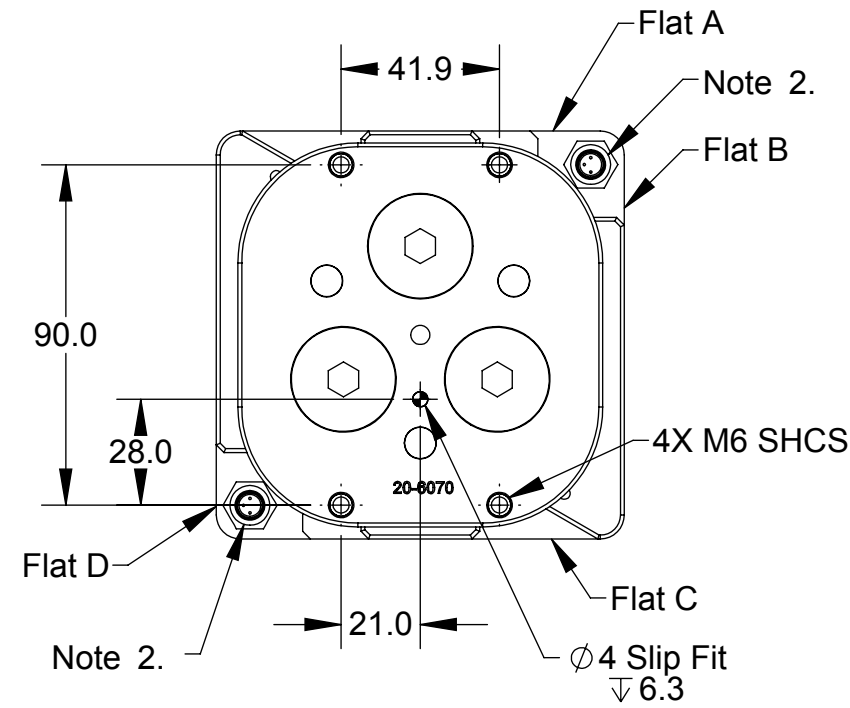

Master Side View

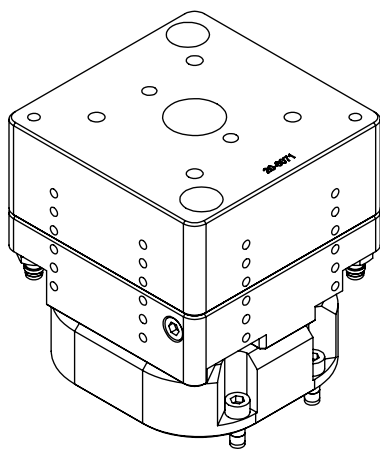

Notes:

- Continuous Coupling Force must be maintained in order to keep Master and Tool engaged.
- Master side SG models feature 2x 3-Wire PNP prox sensors to detect tool presence, M8 quick disconnect style. Other sensor options available.
- Master side coupler body compresses 2mm - 4mm when coupled.

ITEM NO.	QTY	PART NUMBER	DESCRIPTION
1	1	9123-GK1CM-0-0-0-0-SG	GK1 Compliant Utility Coupler Master, +/- 4mm Compliance, 3 Degrees Angular, w/(2) DC PNP Sensors
2	1	9123-GK1T-0-0-0-0	GK1 Utility Coupler Tool Base Assembly

NOTES: UNLESS OTHERWISE SPECIFIED.

DO NOT SCALE DRAWING. ALL DIMENSIONS ARE IN MILLIMETERS.

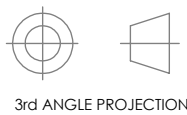

1031 Goodworth Drive, Apex, NC 27539, USA
Tel: +1.919.772.0115 Email: info@ati-ia.com
Fax: +1.919.772.8259 www.ati-ia.com
ISO 9001 Registered Company

PROPERTY OF ATI INDUSTRIAL AUTOMATION, INC. NOT TO BE REPRODUCED IN ANY MANNER EXCEPT ON ORDER OR WITH PRIOR WRITTEN AUTHORIZATION OF ATI.

DRAWN BY: M. Perrault, 9/28/12		TITLE GK1 Compliant Utility Coupler			
CHECKED BY: D. Norton, 10/12/12					
PROJECT #		SCALE	SIZE	DRAWING NUMBER	REVISION
SHEET 1 OF 3		1:5	B	9630-20-GK1	04

Rev.	Description	Initiator	Date
-	See Sheet1	-	-

GK1 Compliant Utility Coupler Master Assembly

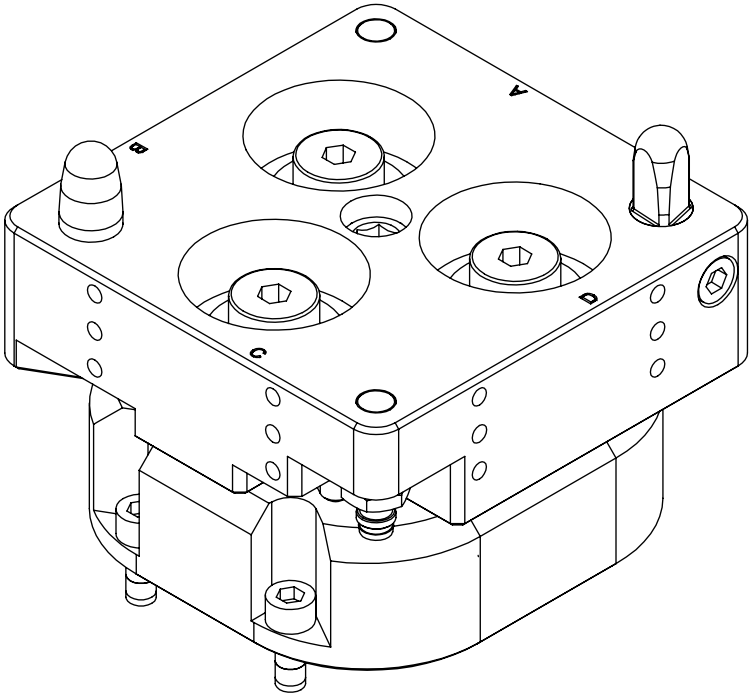
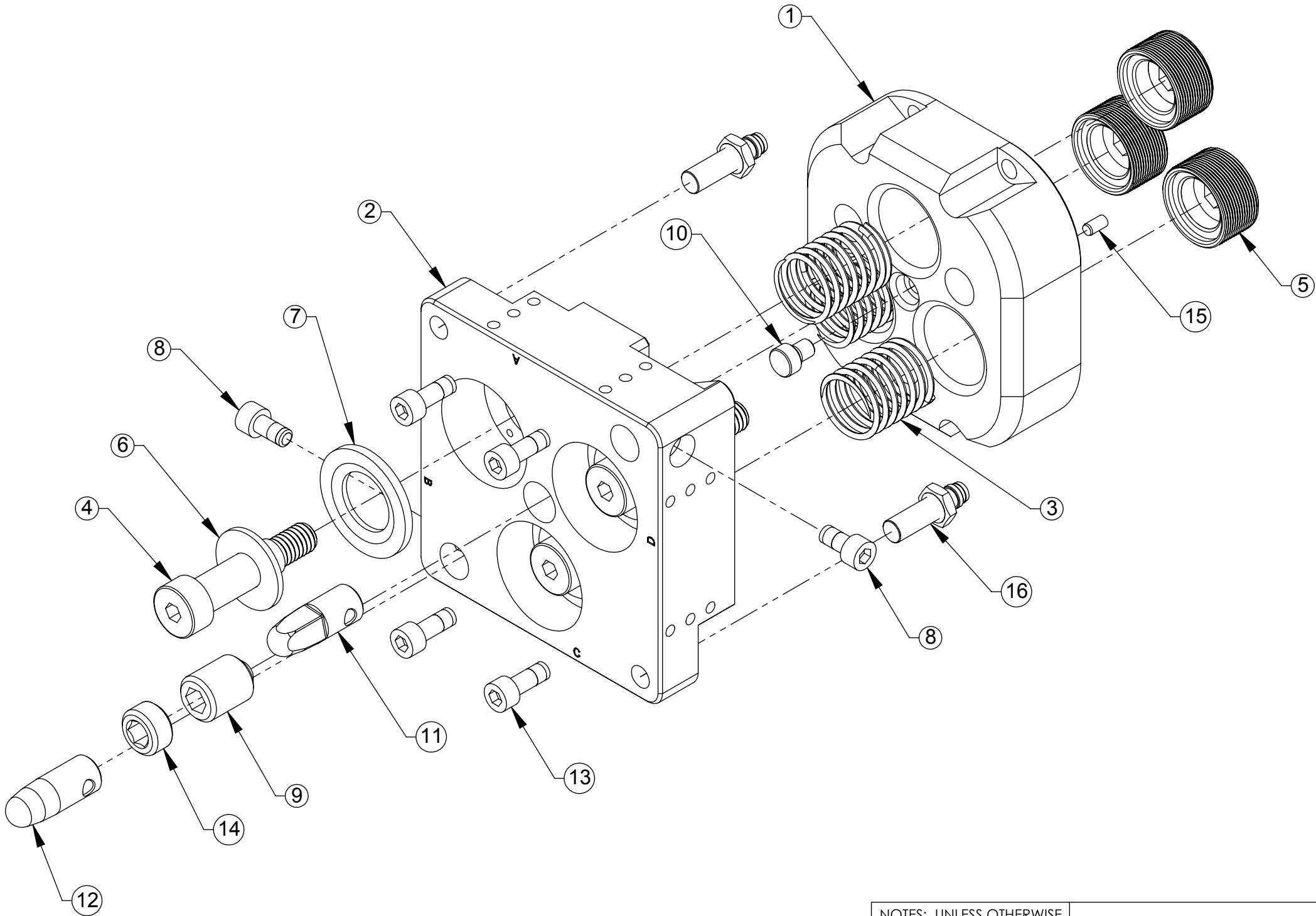

NOTES: UNLESS OTHERWISE SPECIFIED.

DO NOT SCALE DRAWING. ALL DIMENSIONS ARE IN MILLIMETERS.

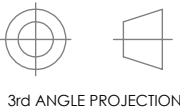

3rd ANGLE PROJECTION



1031 Goodworth Drive, Apex, NC 27539, USA
 Tel: +1.919.772.0115 Email: info@ati-ia.com
 Fax: +1.919.772.8259 www.ati-ia.com
 ISO 9001 Registered Company

PROPERTY OF ATI INDUSTRIAL AUTOMATION, INC. NOT TO BE REPRODUCED IN ANY MANNER EXCEPT ON ORDER OR WITH PRIOR WRITTEN AUTHORIZATION OF ATI.

DRAWN BY: M. Perrault, 9/28/12		TITLE GK1 Compliant Utility Coupler			
CHECKED BY: D. Norton, 10/12/12					
PROJECT #		SCALE	SIZE	DRAWING NUMBER	REVISION
SHEET 2 OF 3		2:3	B	9630-20-GK1	04

Rev.	Description	Initiator	Date
-	See Sheet1	-	-

GK1 Compliant Utility Coupler Tool Assembly

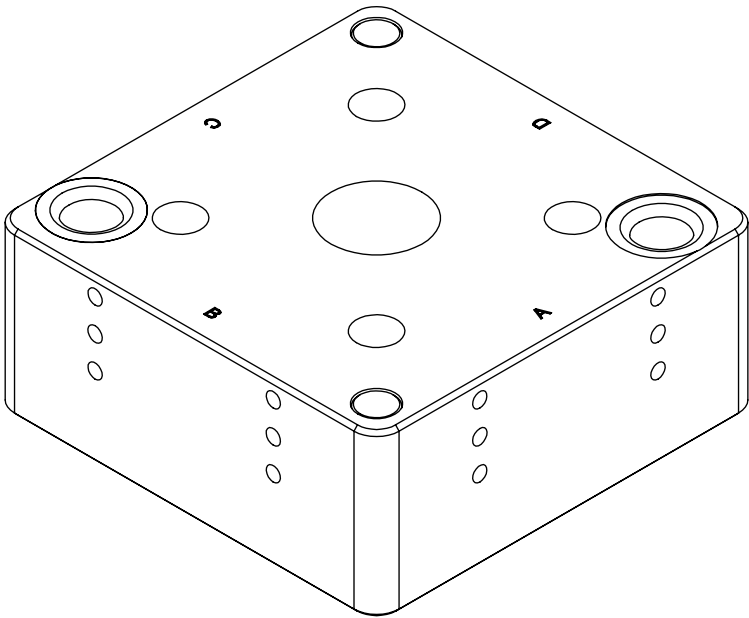
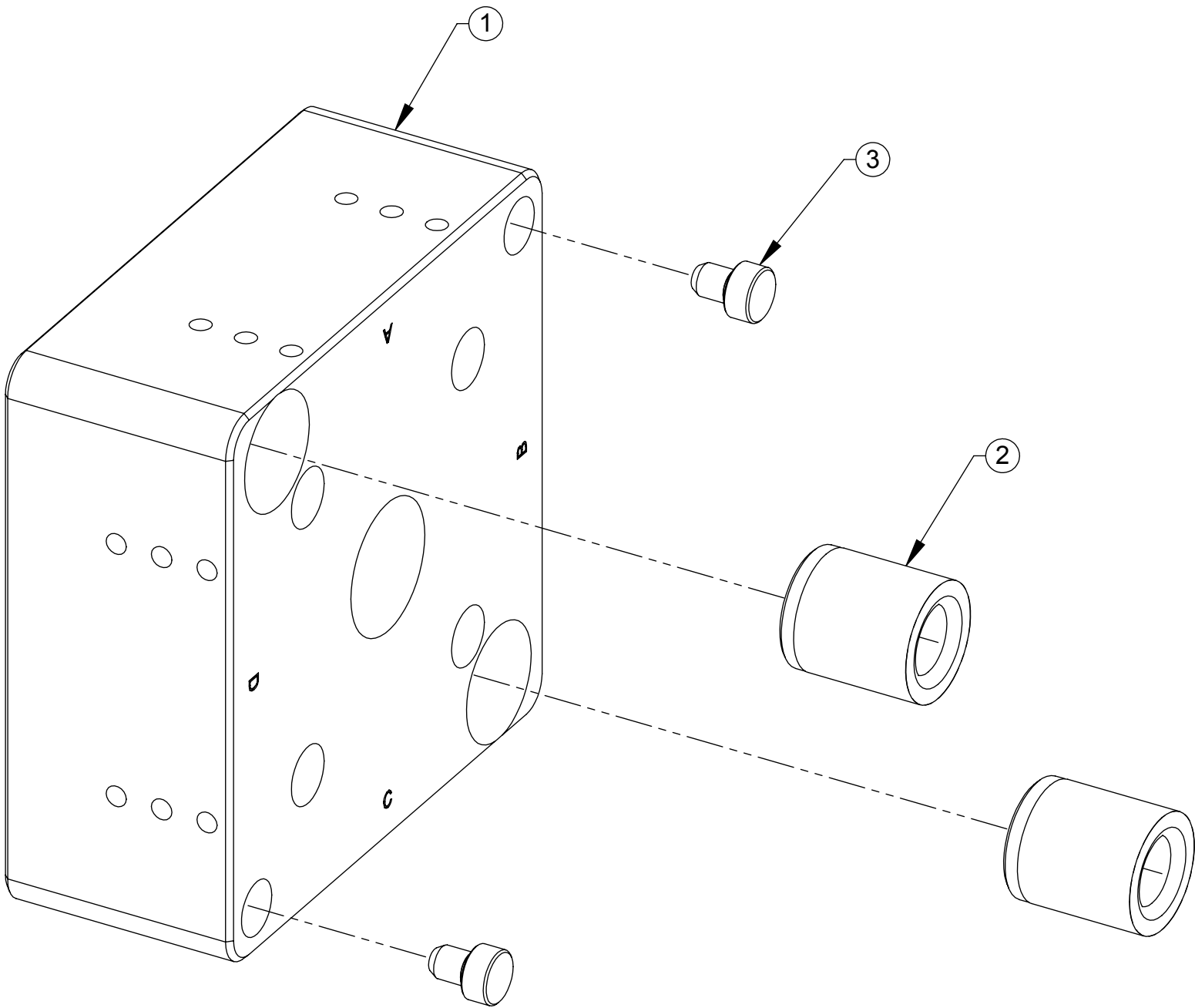

NOTES: UNLESS OTHERWISE SPECIFIED.

DO NOT SCALE DRAWING.
ALL DIMENSIONS ARE IN MILLIMETERS.

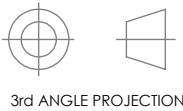

3rd ANGLE PROJECTION



1031 Goodworth Drive, Apex, NC 27539, USA
Tel: +1.919.772.0115 Email: info@ati-ia.com
Fax: +1.919.772.8259 www.ati-ia.com
ISO 9001 Registered Company

PROPERTY OF ATI INDUSTRIAL AUTOMATION, INC. NOT TO BE REPRODUCED IN ANY MANNER EXCEPT ON ORDER OR WITH PRIOR WRITTEN AUTHORIZATION OF ATI.

DRAWN BY: M. Perrault, 9/28/12		TITLE GK1 Compliant Utility Coupler			
CHECKED BY: D. Norton, 10/12/12					
PROJECT #		SCALE	SIZE	DRAWING NUMBER	REVISION
SHEET 3 OF 3		1:1	B	9630-20-GK1	04