

Rev.	Description	Initiator	Date
02	checked and revised	DAW	3/30/2009

"DANGER! - For electrical modules using > 60VDC or 42 VAC, NO contact should be attempted before removing power. This especially includes separation or insertion of the mating connectors or any contact with the tool changer or its components."

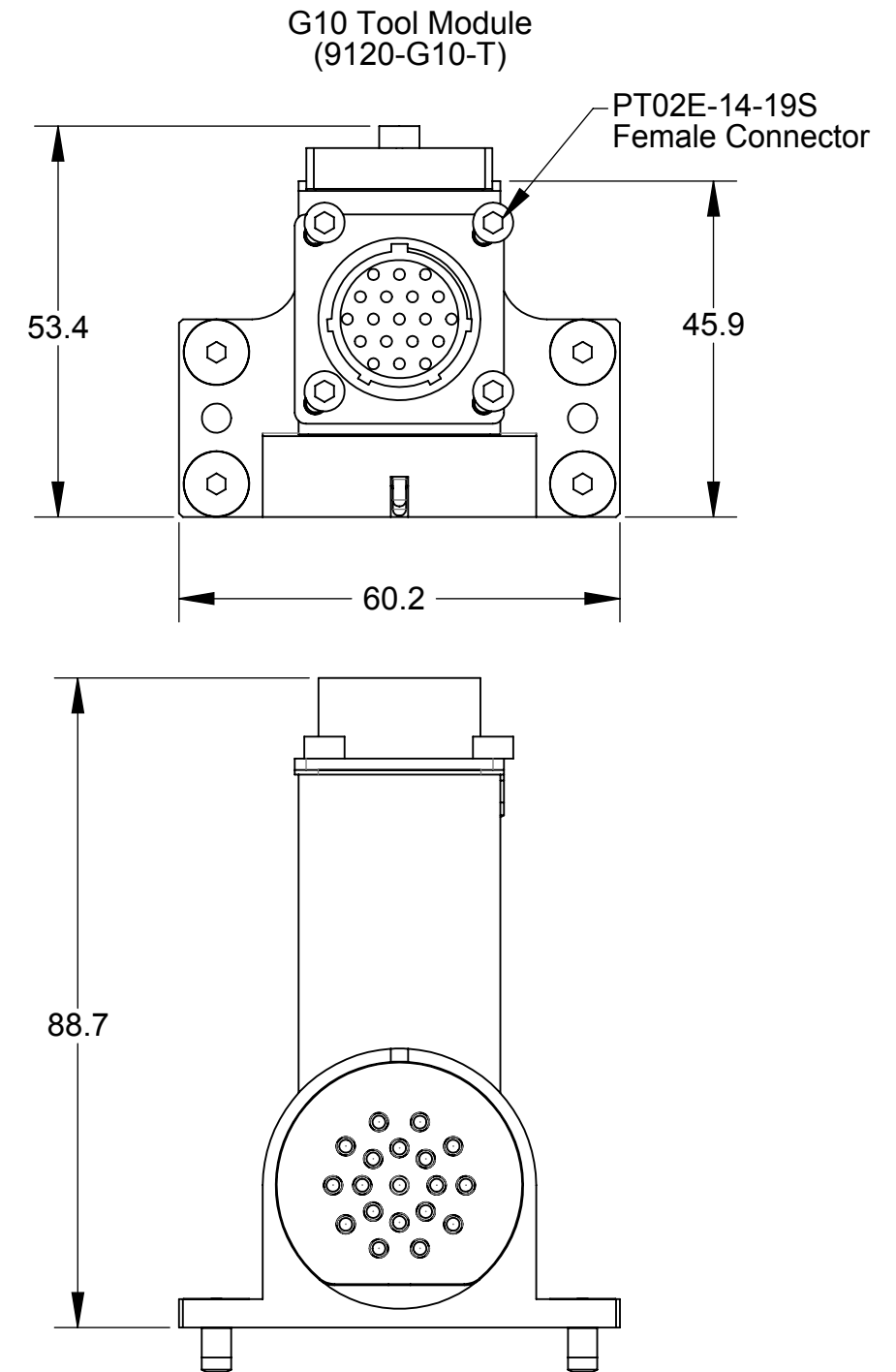
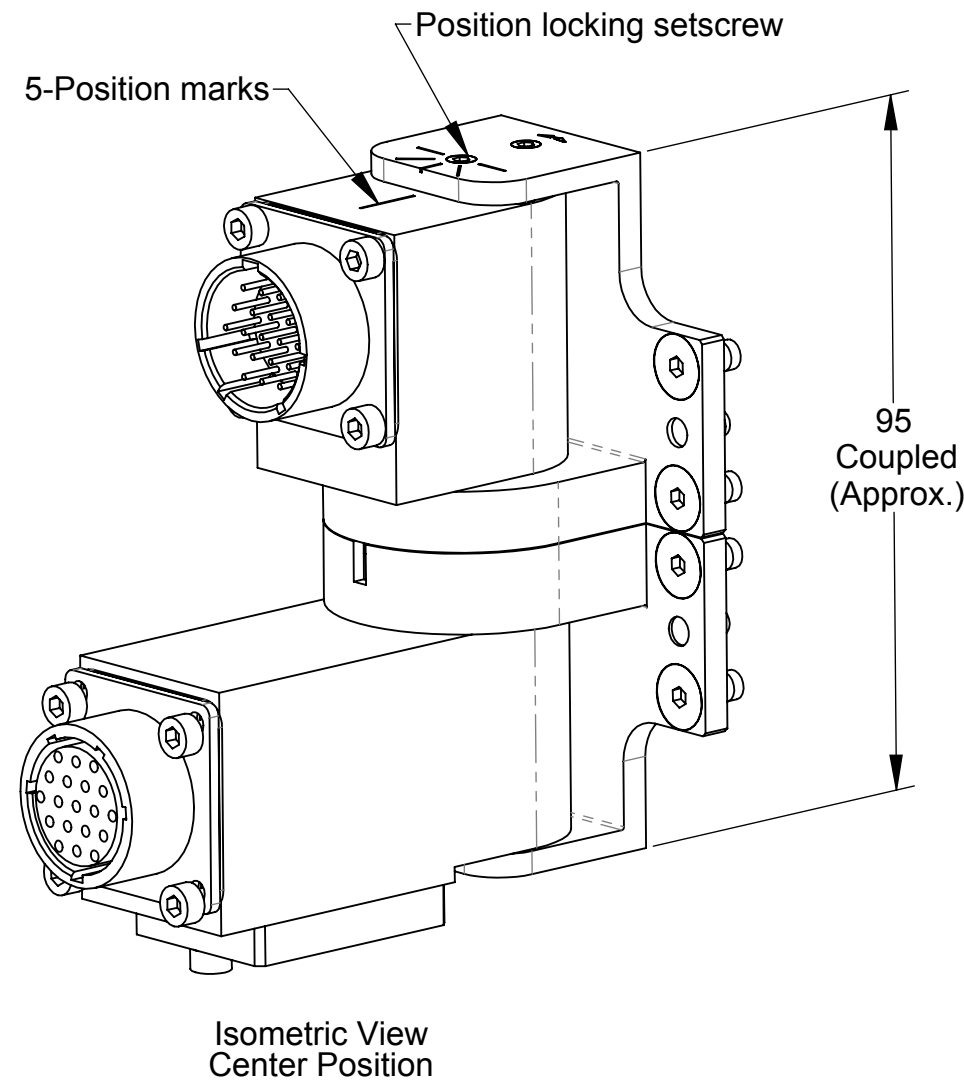
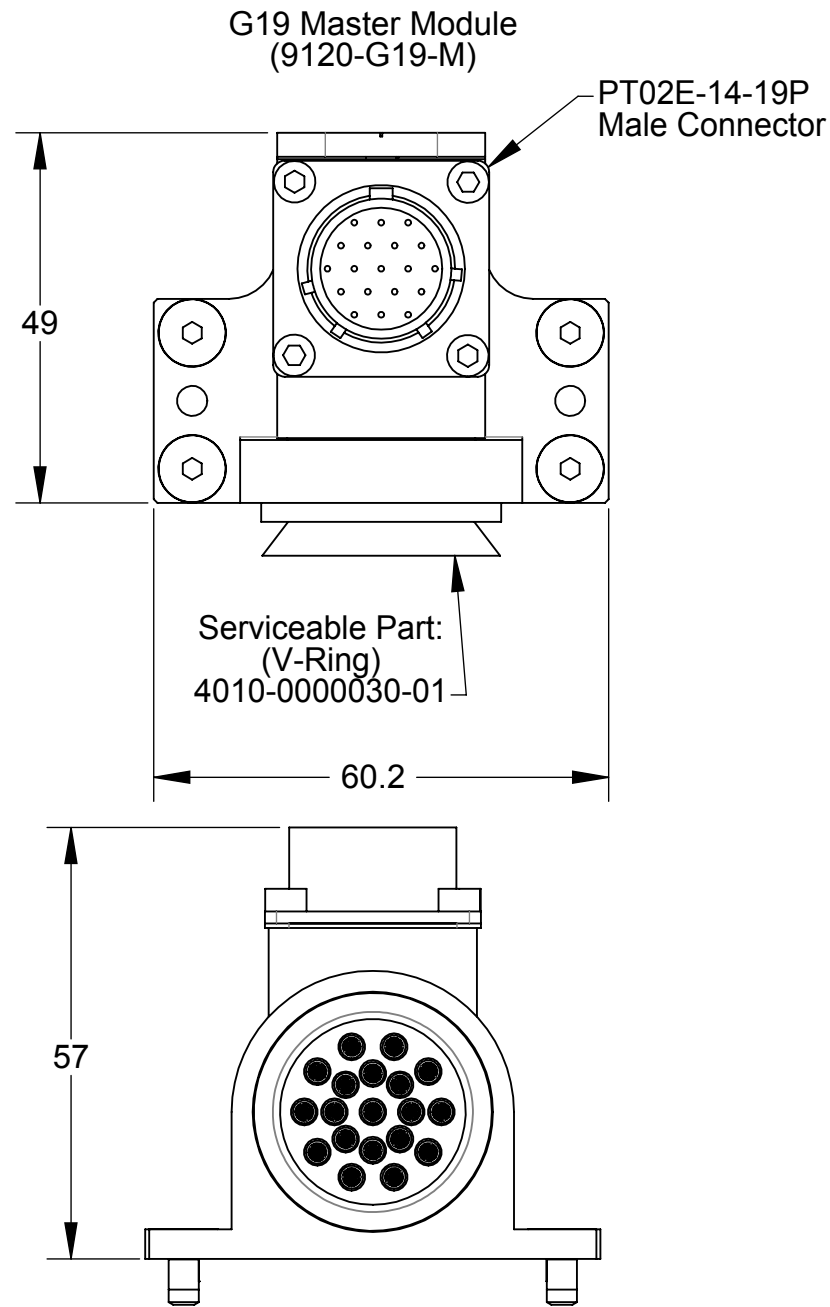

Notes:

- The master module and tool module have 5-position options which can be adjusted as required.
- Warning:** The modules must be adjusted and secured into position prior to operation, otherwise internal damage to conductors may occur.

NOTES: UNLESS OTHERWISE SPECIFIED
 DO NOT SCALE DRAWING. DRAWN IN SOLIDWORKS.
 ALL DIMENSIONS ARE IN MILLIMETERS.

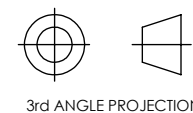

1031 Goodworth Drive, Apex, NC 27539, USA
 Tel: +1.919.772.0115 Email: info@ati-ia.com
 Fax: +1.919.772.8259 www.ati-ia.com
 ISO 9001 Registered Company

DRAWN BY: D. Wagner 3/12/09	TITLE 9630-20-G19M-G10T Module Drawing		
CHECKED BY: DSS 3-27-09	SCALE 1:1	SIZE B	DRAWING NUMBER 9630-20-G19M-G10T-02
WEIGHT LBS: -----	PRODUCT RELEASE # 080730-2		DATE:
ASSEMBLY REF:	SHEET 1		OF 2

Rev.	Description	Initiator	Date
-	See Sheet1	-	-

G19 to G10 Pin Out

G19 Master
 PT02E-14-19P
 Male Connector

G10 Tool
 PT02E-14-19S
 Female Connector

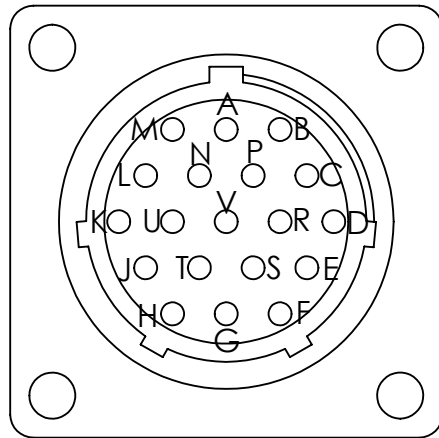

Face Side

Bendix Amphenol PT02E-14-19P

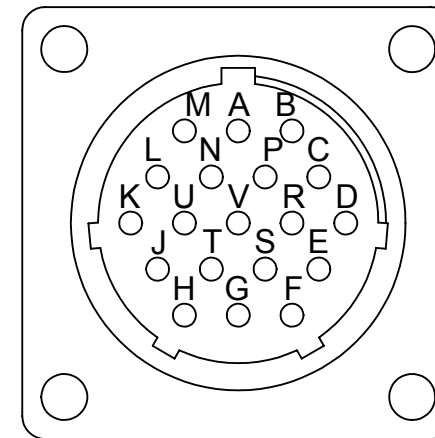

Face Side

Bendix Amphenol PT02E-14-19S

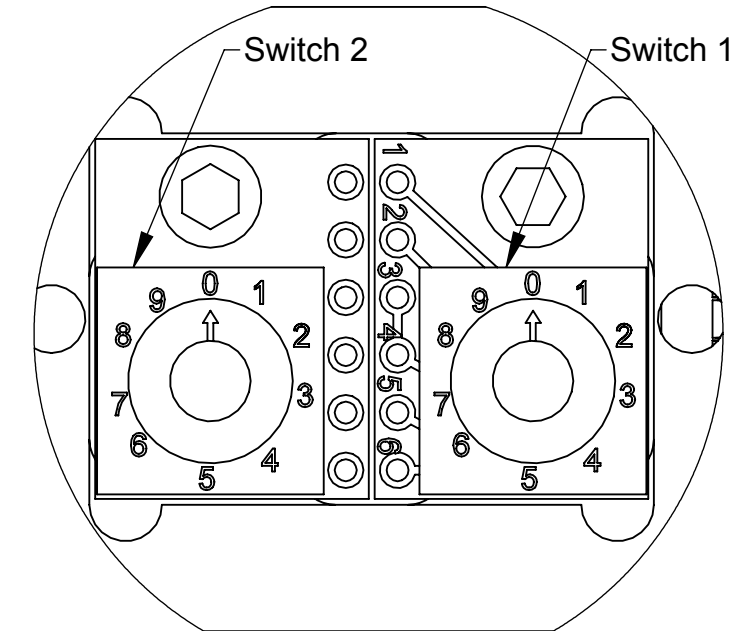
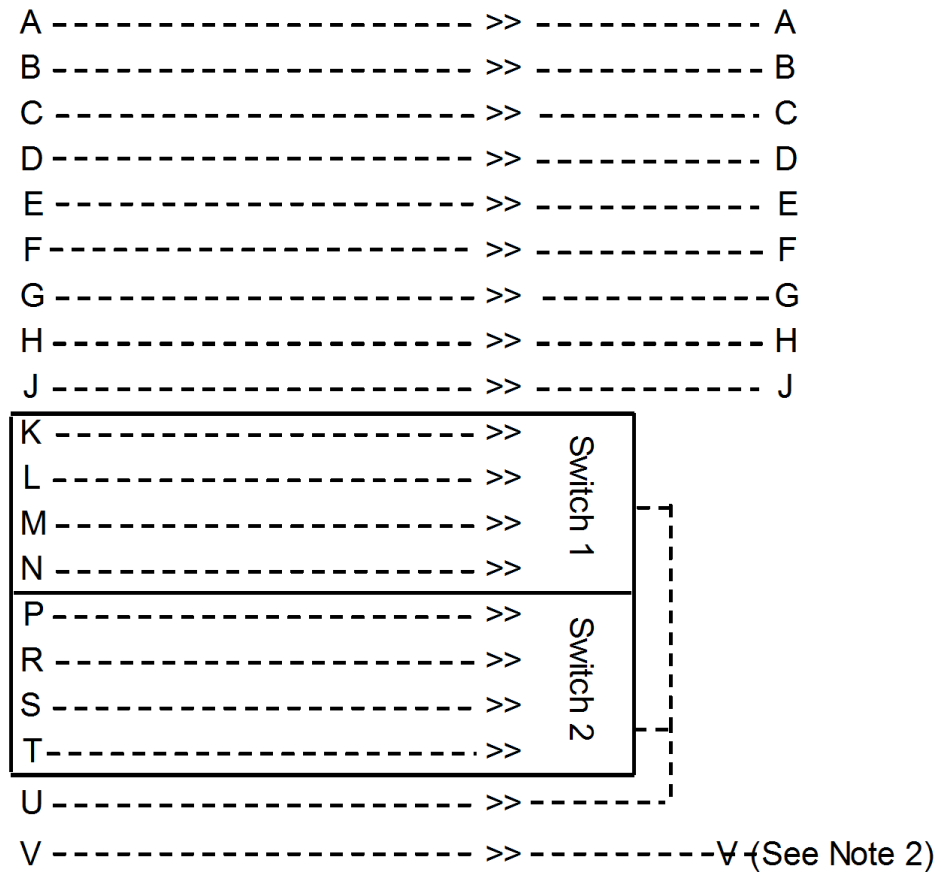

DETAIL A
 SCALE 3 : 1

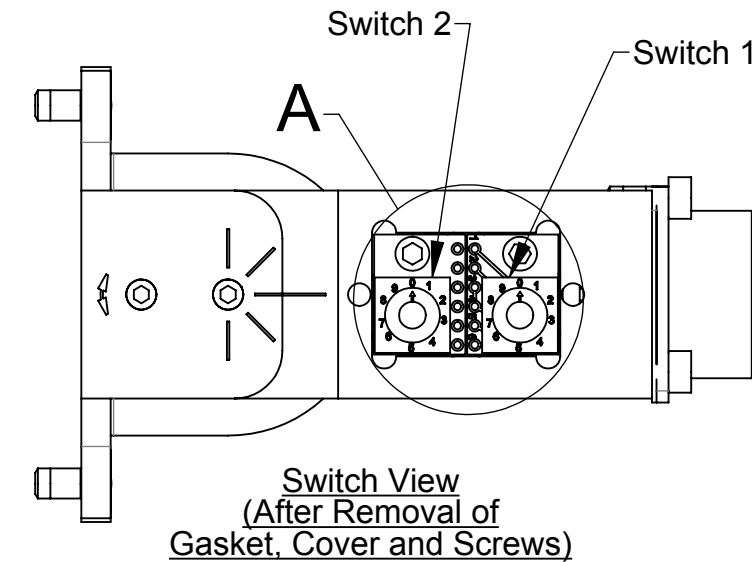

Switch View
 (After Removal of
 Gasket, Cover and Screws)

Binary Output of Tool ID

Switch Selection	Pin	Pin	Pin	Pin	Switch 1	Switch 2
	K	L	M	N		
0	0	0	0	0		
1	0	0	0	1		
2	0	0	1	0		
3	0	0	1	1		
4	0	1	0	0		
5	0	1	0	1		
6	0	1	1	0		
7	0	1	1	1		
8	1	0	0	0		
9	1	0	0	1		

- Notes:
 1. Views of connectors are 3:1 scale.
 2. Pin "V" on the connector is First-to-Mate Last-to-Break at Tool Changer interface. This pin is recommended for use as ground.

NOTES: UNLESS OTHERWISE SPECIFIED
 DO NOT SCALE DRAWING. DRAWN IN SOLIDWORKS.
 ALL DIMENSIONS ARE IN MILLIMETERS.

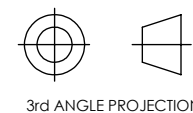

1031 Goodworth Drive, Apex, NC 27539, USA
 Tel: +1.919.772.0115 Email: info@ati-ia.com
 Fax: +1.919.772.8259 www.ati-ia.com
 ISO 9001 Registered Company

DRAWN BY: D. Wagner 3/12/09	TITLE 9630-20-G19M-G10T Module Drawing		
CHECKED BY: DSS 3-27-09	SCALE 1:1	SIZE B	DRAWING NUMBER 9630-20-G19M-G10T-02
WEIGHT LBS: -----	PRODUCT RELEASE # 080730-2		DATE: _____
ASSEMBLY REF:	SHEET 2 OF 2		