

"DANGER!" - Electrical Shock Hazard

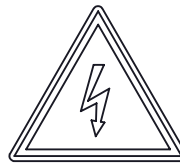

This module has a Voltage of 50V or greater, NO contact should be attempted before removing power. This especially includes separation or insertion of the mating connectors or any contact with the tool changer or its components.

REV.	DESCRIPTION	INITIATOR	DATE
04P	Updated format per ATI standards and corrected the module rating as per Electrical checking group.	VV	6/6/2018
05	Production Release	VV	6/19/2018

9120-G19A-M

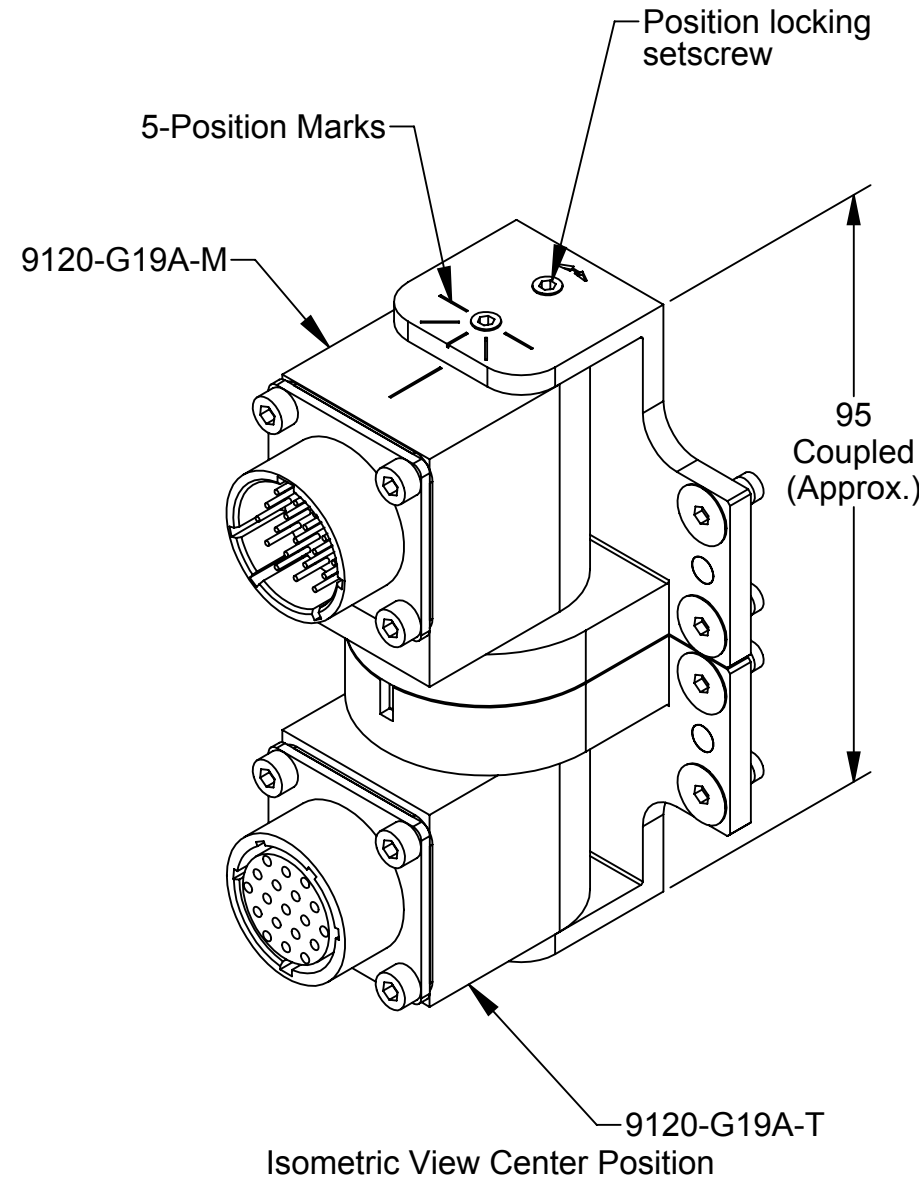
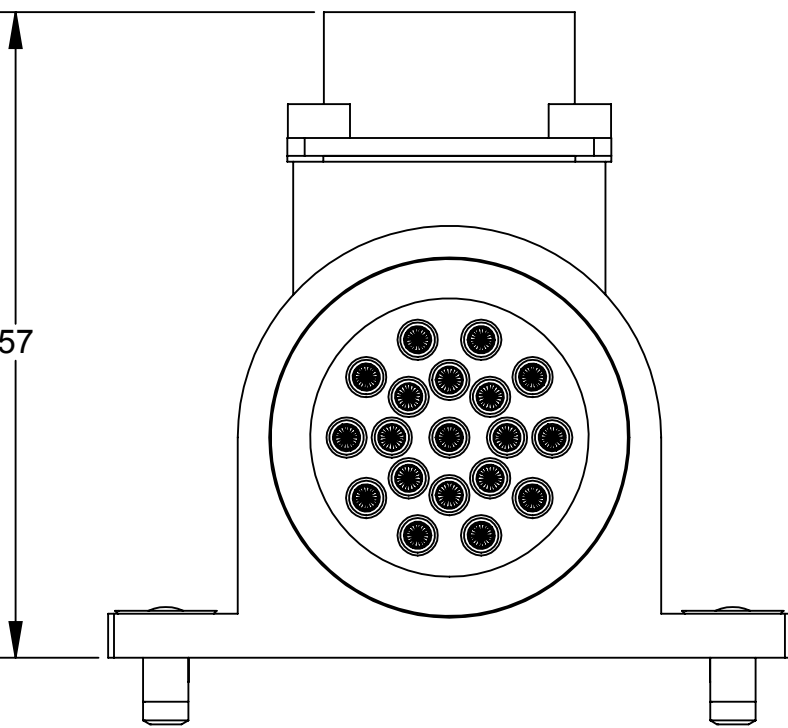
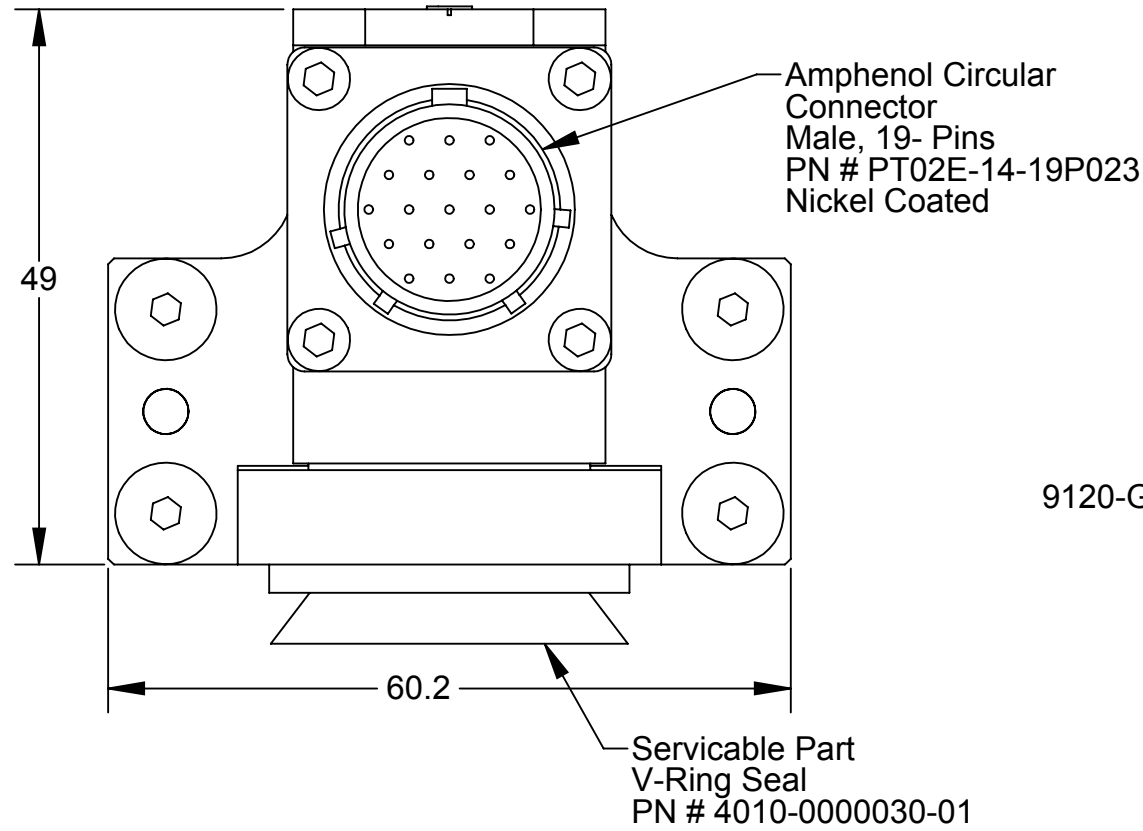

9120-G19A-T

Amphenol Circular Connector Female, 19- Pins
PN # PT02E-14-19S023
Nickel Coated

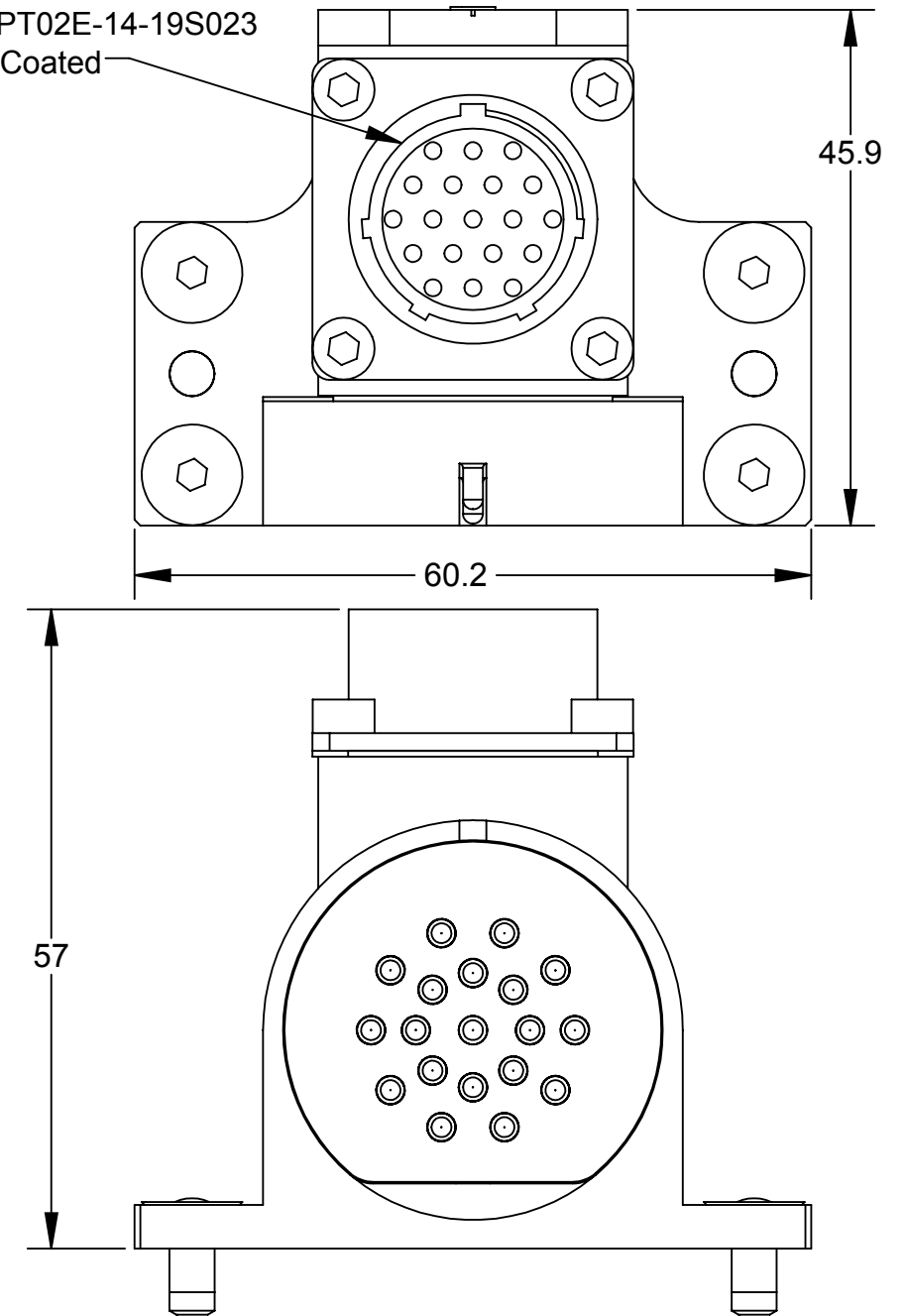

Notes:

1. The Master Module and the Tool module have 5-position options which can be adjusted as required.
2. The modules must be adjusted and secured into position prior to operation, otherwise internal damage to conductors may occur.
3. See sheet 2 for detailed information regarding G19A Master and Tool Connectors and Pin Blocks.
4. See Sheet 3 for detailed G19A electrical schematic and electrical ratings.

NOTES: UNLESS OTHERWISE SPECIFIED.

DO NOT SCALE DRAWING. ALL DIMENSIONS ARE IN MILLIMETERS.

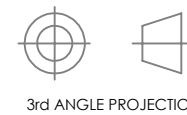

3rd ANGLE PROJECTION



1031 Goodworth Drive, Apex, NC 27539, USA
Tel: +1.919.772.0115 Email: info@ati-ia.com
Fax: +1.919.772.8259 www.ati-ia.com
ISO 9001 Registered Company

PROPERTY OF ATI INDUSTRIAL AUTOMATION, INC. NOT TO BE REPRODUCED IN ANY MANNER EXCEPT ON ORDER OR WITH PRIOR WRITTEN AUTHORIZATION OF ATI.

DRAWN BY: V.Vavilikolane, 5/10/18		TITLE	
CHECKED BY: B.Smith, 06/05/18 K. Davis, 06/05/18		G19A Customer Drawing	
PROJECT # 180426-3	SHEET 1 OF 3	SCALE 1:2	SIZE B
		DRAWING NUMBER 9630-20-G19A	REVISION 05

9120-G19A-M

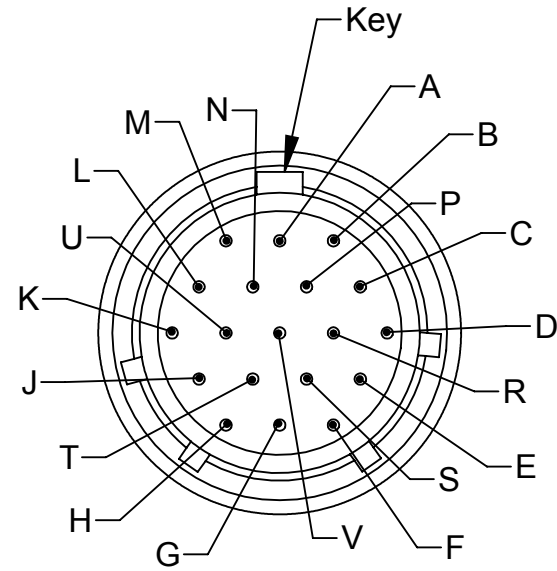
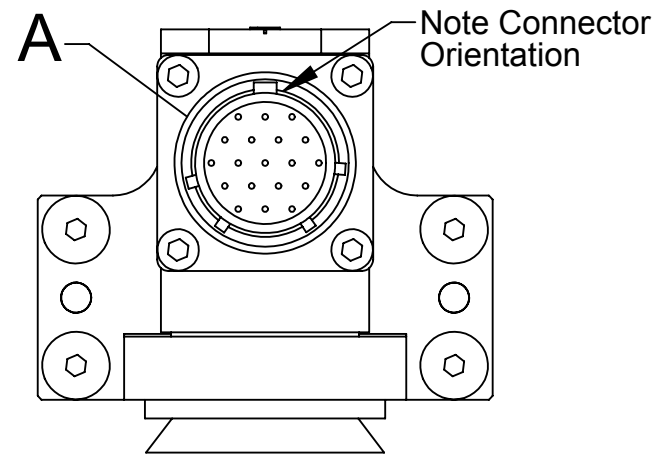

DETAIL A
SCALE 2 : 1

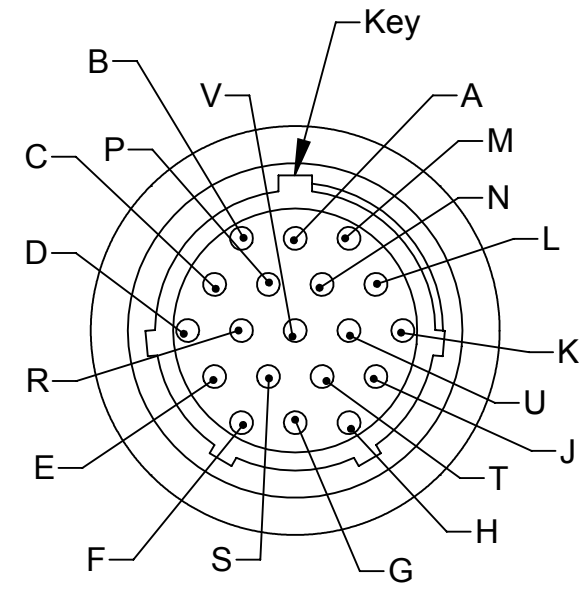

DETAIL C
SCALE 2 : 1

9120-G19A-T

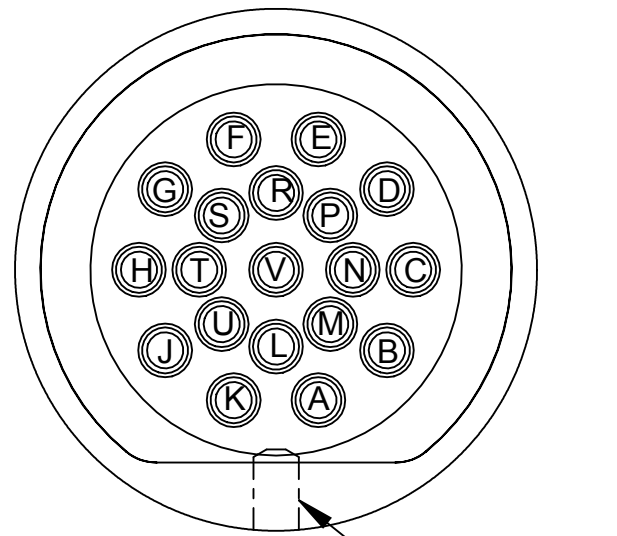
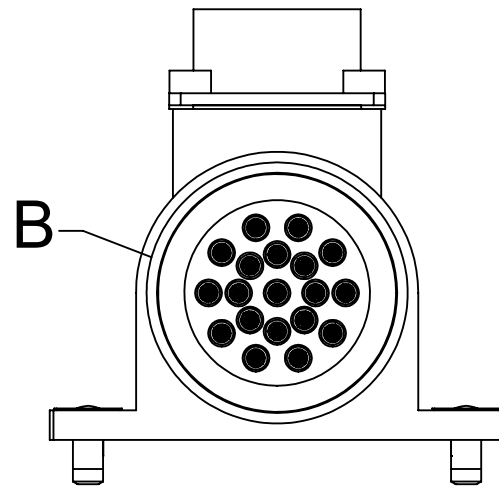
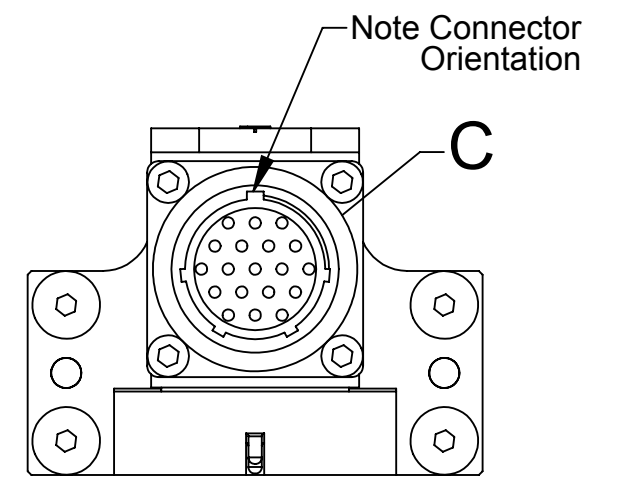

DETAIL B
SCALE 2 : 1

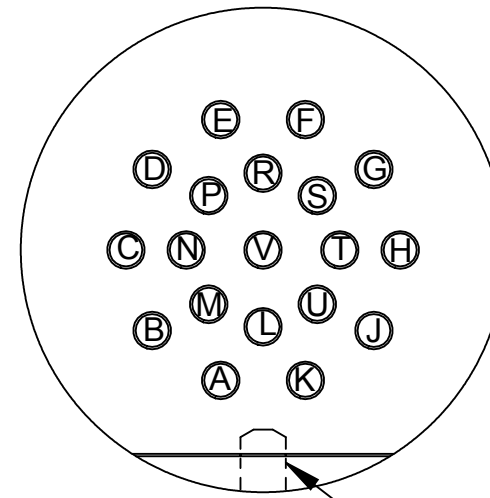

DETAIL D
SCALE 2 : 1

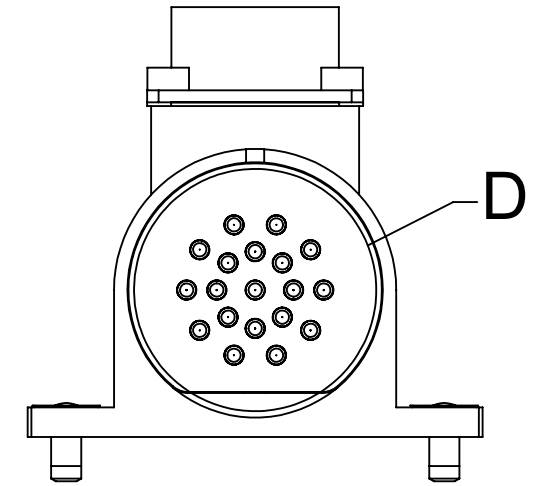

NOTES: UNLESS OTHERWISE SPECIFIED.

DO NOT SCALE DRAWING. ALL DIMENSIONS ARE IN MILLIMETERS.



3rd ANGLE PROJECTION



1031 Goodworth Drive, Apex, NC 27539, USA
Tel: +1.919.772.0115 Email: info@ati-ia.com
Fax: +1.919.772.8259 www.ati-ia.com
ISO 9001 Registered Company

PROPERTY OF ATI INDUSTRIAL AUTOMATION, INC. NOT TO BE REPRODUCED IN ANY MANNER EXCEPT ON ORDER OR WITH PRIOR WRITTEN AUTHORIZATION OF ATI.

DRAWN BY: V.Vavilikolane, 5/10/18

CHECKED BY: B.Smith, 06/05/18

K. Davis, 06/05/18

PROJECT # 180426-3 SHEET 2 OF 3

TITLE

G19A Customer Drawing

SCALE
1:1

SIZE
B

DRAWING NUMBER
9630-20-G19A

REVISION
05

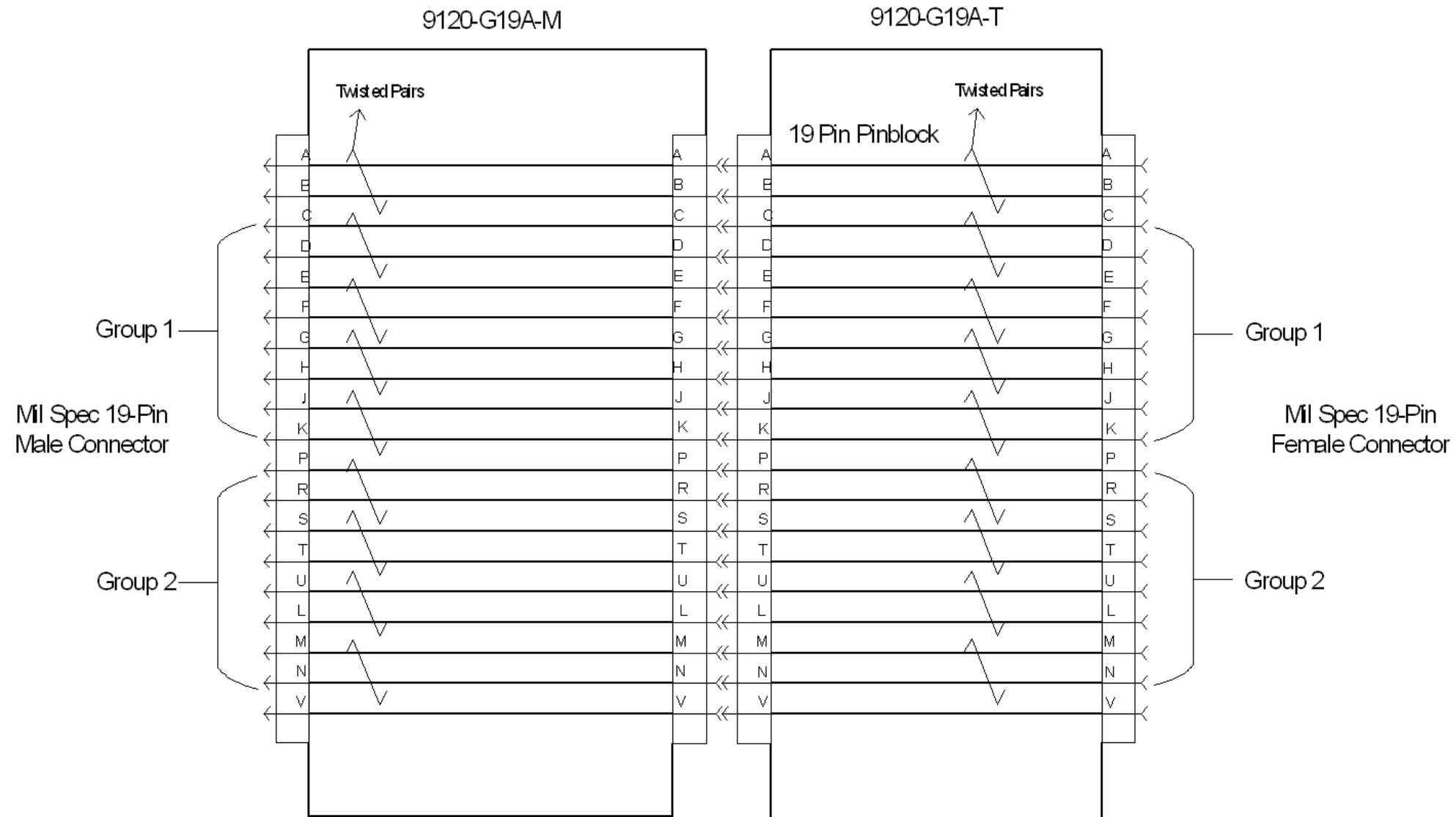

Notes:

1. The electrical rating for the module is 3A, 250VAC.
2. Pin V-V of 19-Pinblock is first to mate and last to break.

NOTES: UNLESS OTHERWISE SPECIFIED.

DO NOT SCALE DRAWING. ALL DIMENSIONS ARE IN MILLIMETERS.

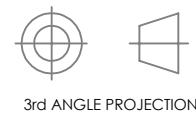

1031 Goodworth Drive, Apex, NC 27539, USA
 Tel: +1.919.772.0115 Email: info@ati-ia.com
 Fax: +1.919.772.8259 www.ati-ia.com
 ISO 9001 Registered Company

PROPERTY OF ATI INDUSTRIAL AUTOMATION, INC. NOT TO BE REPRODUCED IN ANY MANNER EXCEPT ON ORDER OR WITH PRIOR WRITTEN AUTHORIZATION OF ATI.

DRAWN BY: V.Vavilikolane, 5/10/18		TITLE	
CHECKED BY: B.Smith, 06/05/18 K. Davis, 06/05/18		G19A Customer Drawing	
PROJECT # 180426-3	SHEET 3 OF 3	SCALE 1:1	SIZE B
		DRAWING NUMBER 9630-20-G19A	REVISION 05