

Rev.	Description	Initiator	Date
03	ECO 12704; Added Torque Values To Valve Stem & Plug	TBC	11/7/2014

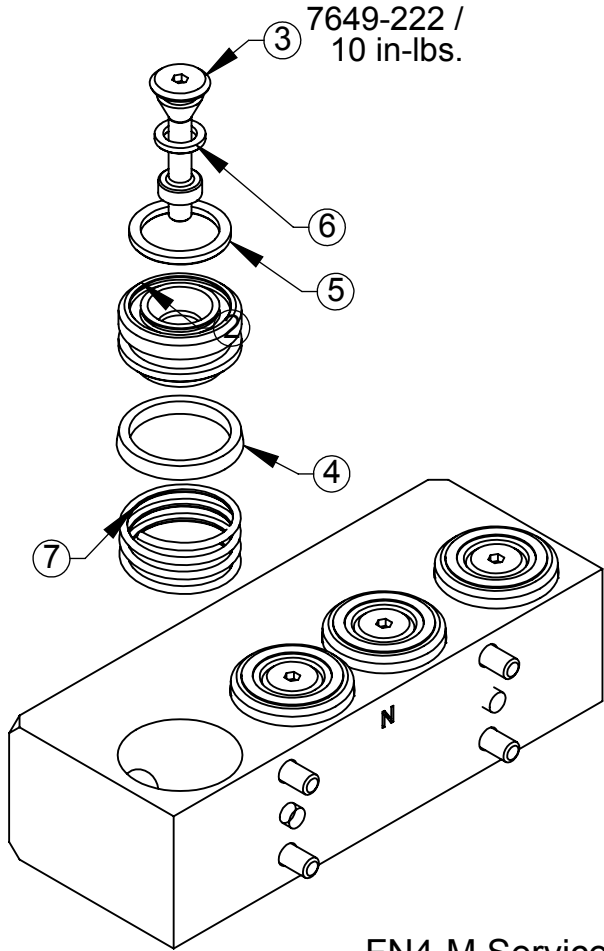
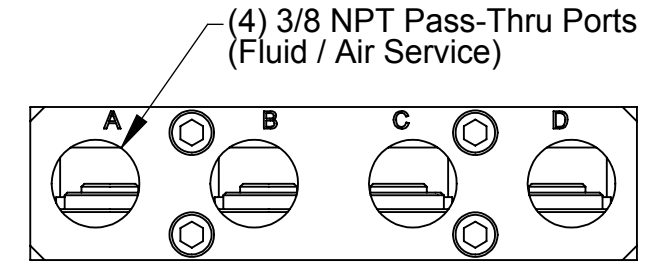
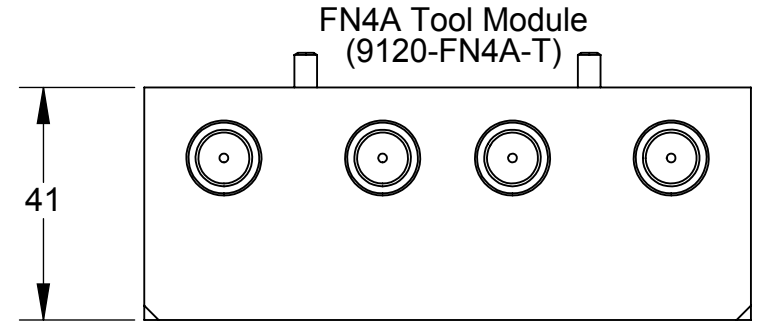
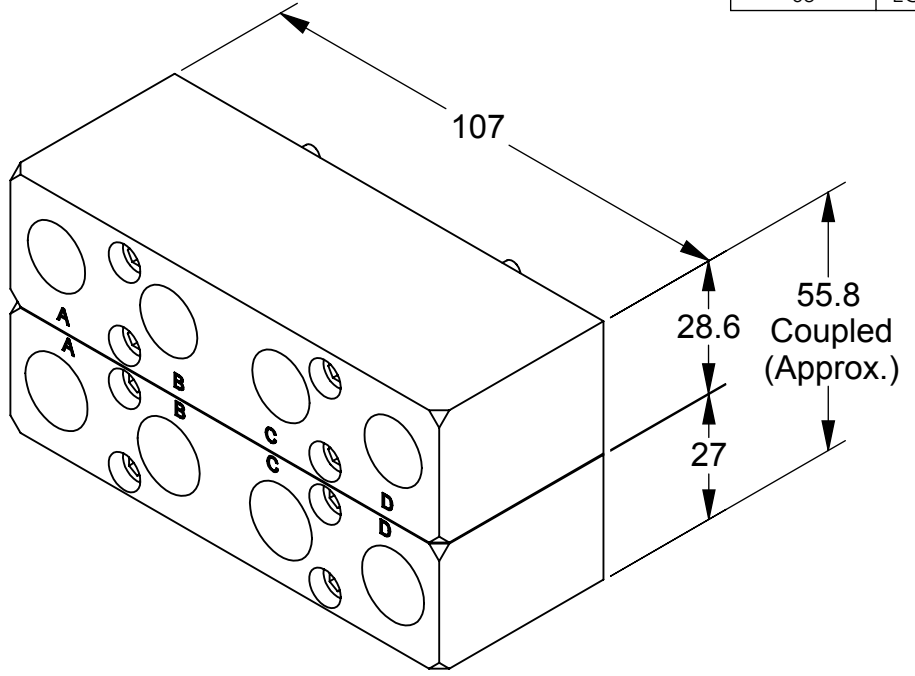
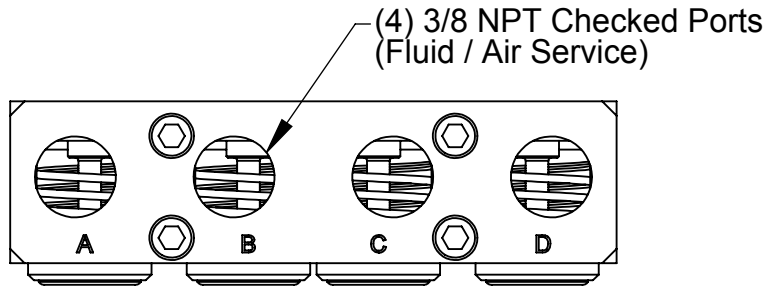
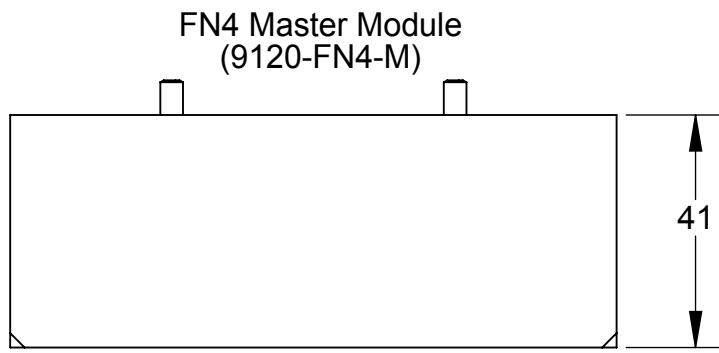

FN4-M Serviceable Parts

ITEM NO.	QTY.	PART NUMBER	DESCRIPTION
2	4	3700-20-2994	Master Check Valve Piston, FA44
3	4	3700-20-3488	Valve Stem
4	4	3410-0001068-01	Mini U-Cup Seal 18mm ID x 22mm Buna
5	4	3410-0001065-01	O-Ring 14MM X 2MM Buna
6	4	3410-0001183-01	O-Ring 6MM X 2MM Buna D90
7	4	3610-1907501-21	SS SPRING 7/8 OD

- Notes:
- Material of Construction:
- Housing - Stainless Steel
 - Valve Components - Buna-N, PVC & Stainless Steel
- Operation:
- For best results ensure fluids are near neutral pH, minimize fluid particulate size and keep fluid module mating surfaces free and clear of any debris.
 - Checked ports can produce significant forces when under high supply pressures. These forces have to be overcome to achieve tool changer coupling.
 - Checked ports do not support vacuum conditions.

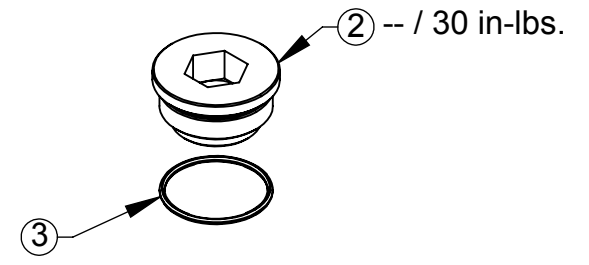

FN4A-T Serviceable Parts

ITEM NO.	QTY.	PART NUMBER	DESCRIPTION
2	4	3700-20-3288	Plug, F/A Tool
3	4	3410-0001284-01	O-ring, .669OD x .047 wall, 70D, Buna-N

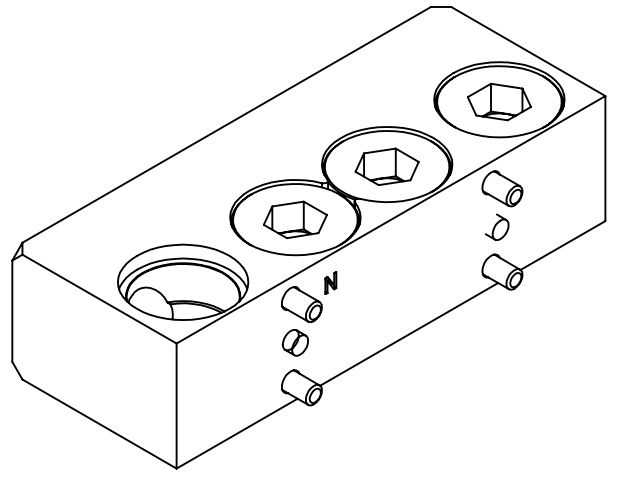

NOTES: UNLESS OTHERWISE SPECIFIED.

DO NOT SCALE DRAWING. ALL DIMENSIONS ARE IN MILLIMETERS.

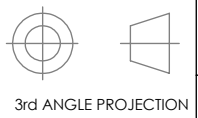

1031 Goodworth Drive, Apex, NC 27539, USA
 Tel: +1.919.772.0115 Email: info@ati-ia.com
 Fax: +1.919.772.8259 www.ati-ia.com
 ISO 9001 Registered Company

PROPERTY OF ATI INDUSTRIAL AUTOMATION, INC. NOT TO BE REPRODUCED IN ANY MANNER EXCEPT ON ORDER OR WITH PRIOR WRITTEN AUTHORIZATION OF ATI.

DRAWN BY: P.Sparrow, 10/26/04		TITLE	
CHECKED BY: B.Digeso, 10/29/04		FN4-M with FN4A-T Fluid/Air Module Drawing	
PROJECT # 030725-3	SHEET 1 OF 1	SCALE 3:4	SIZE B
DRAWING NUMBER 9630-20-FN4M FN4AT		REVISION 03	