

Rev.	Description	Initiator	Date
02	ECO 14748: Added torque & Magnalube information; Added Notes 4 & 5 to Materials of Construction.	TBC	9/27/2016

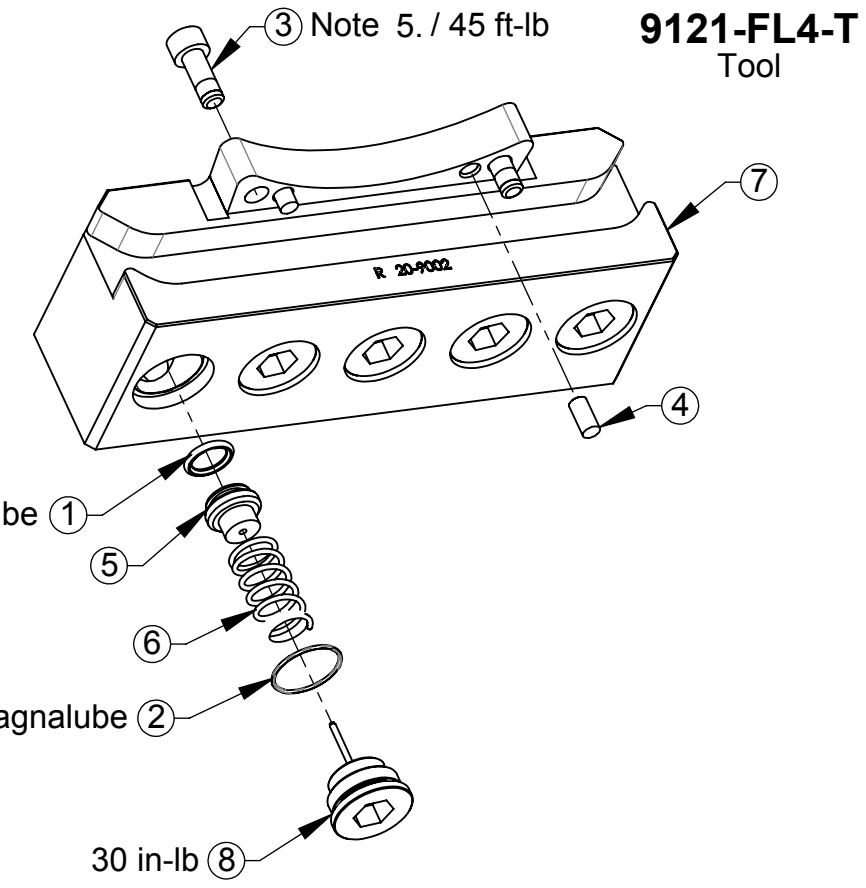
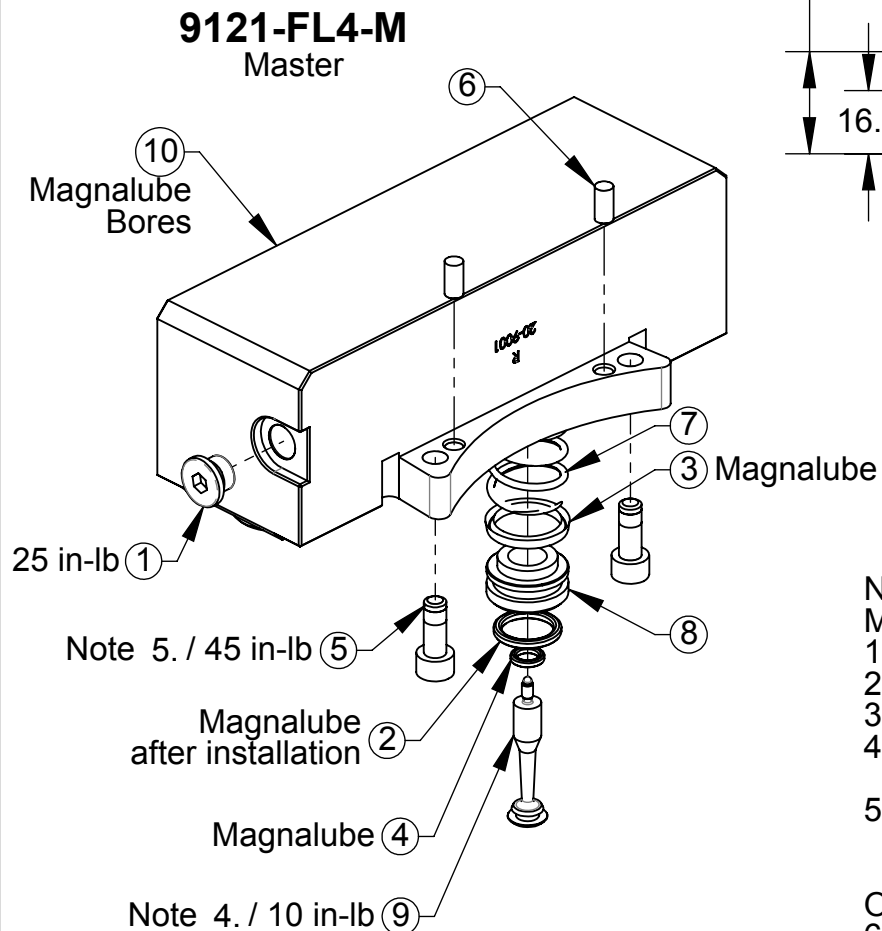
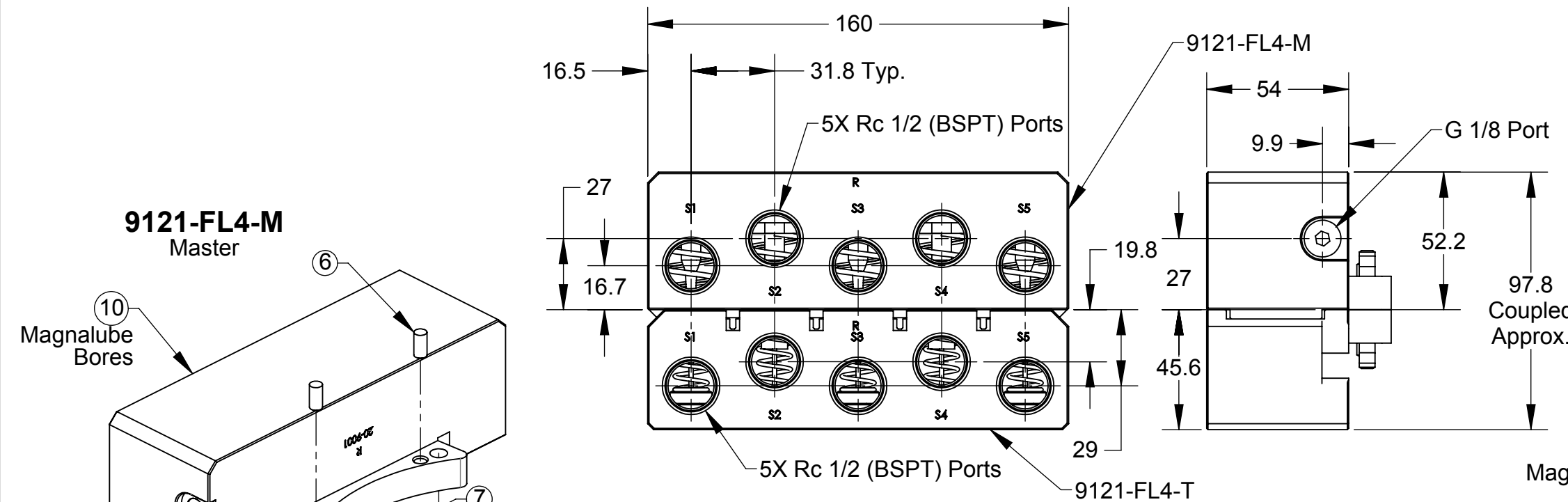

- Notes:
- Material of Construction:
1. Housings - Stainless Steel
 2. Valve Components - Stainless Steel, PVC & Nitrile
 3. G 1/8 Plug - Nickel Plated Brass
 4. Replacement stem contains pre-applied thread locker. Use Loctite 7649 primer and Loctite 222 if reassembling with original stem.
 5. Replacement screw contains pre-applied thread locker. Use Loctite 7649 primer and Loctite 242 if reassembling with original screw.
- Operations:
6. For best results ensure fluids are near neutral pH, minimize fluid particulate size and keep fluid module mating surfaces free and clear of any debris.
 7. Checked ports can produce significant forces when under high supply pressures. See product manual regarding proper operating procedure.

ITEM NO.	QTY.	PART NUMBER	DESCRIPTION
1	5	3410-0001067-01	O-ring, 10mm x 2mm, Buna N, Dur. 90
2	5	3410-0001284-01	O-ring, .669OD x .047 wall, 70D, Buna-N
3	2	3500-1066016-21A	M6-1 x 16mm SHCS, SS, Pre-Applied
4	2	3540-0105010-21	5mm x 10mm Dowel Pin SST
5	5	3700-20-1457	SW-150A Tool Check Valve Piston
6	5	3700-20-1460	SPRING, F/A TOOL
7	1	3700-20-9002	FL4 Housing, Tool
8	5	9005-20-1515	3/8" Check Port Long Plug with Dowel

ITEM NO.	QTY.	PART NUMBER	DESCRIPTION
1	1	3405-1000002-00	G1/8 Plug, Hex Socket, O-Ring Seal
2	5	3410-0001065-01	O-Ring 14MM X 2MM Buna
3	5	3410-0001068-01	Mini U-Cup Seal 18mm ID x 22mm Buna
4	5	3410-0001183-01	O-Ring 6MM X 2MM Buna D90
5	2	3500-1066016-21A	M6-1 x 16mm SHCS, SS, Pre-Applied
6	2	3540-0105010-21	5mm x 10mm Dowel Pin SST
7	5	3700-20-1459	SW-150A Master Fluid / Air Spring SS
8	5	3700-20-2994	Master Check Valve Piston, FA44
9	5	3700-20-2996	VALVE STEM, HIGH STRENGTH
10	1	3700-20-9001	FL4 Housing, Master

Note: Service Kit 9120-F2-M-Kit consists of (1) each of items 2, 3, 4, & 7.

Note: Service Kit 9120-F1-T-Kit consists of (1) each of items 1, 2, & 6.

NOTES: UNLESS OTHERWISE SPECIFIED.
DO NOT SCALE DRAWING. ALL DIMENSIONS ARE IN MILLIMETERS.

ATI INDUSTRIAL AUTOMATION

1031 Goodworth Drive, Apex, NC 27539, USA
Tel: +1.919.772.0115 Email: info@ati-ia.com
Fax: +1.919.772.8259 www.ati-ia.com
ISO 9001 Registered Company

PROPERTY OF ATI INDUSTRIAL AUTOMATION, INC. NOT TO BE REPRODUCED IN ANY MANNER EXCEPT ON ORDER OR WITH PRIOR WRITTEN AUTHORIZATION OF ATI.

DRAWN BY: D. Wagner 9/25/14
CHECKED BY: DKL 10/8/14

PROJECT # 140925-3 SHEET 1 OF 1

TITLE: FL4 Module Drawing

SCALE: 1:2
SIZE: B
DRAWING NUMBER: 9630-20-FL4
REVISION: 02

3rd ANGLE PROJECTION