

Rev.	Description	Initiator	Date
02	ECO 14747; Added "Magnalube bores" and added Note 4.	SZJ	9/20/2016

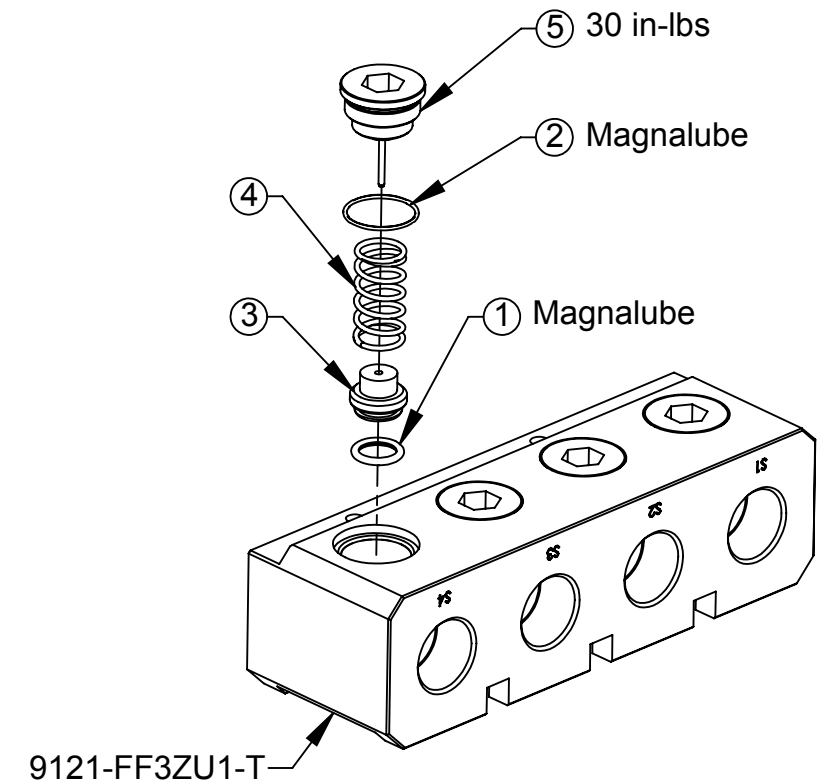
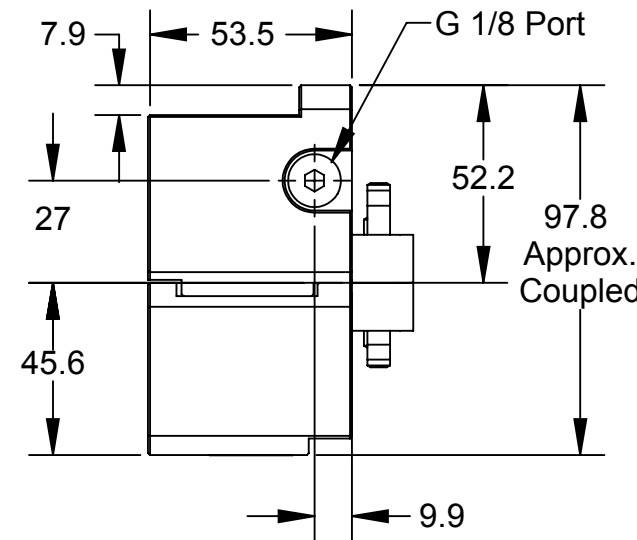
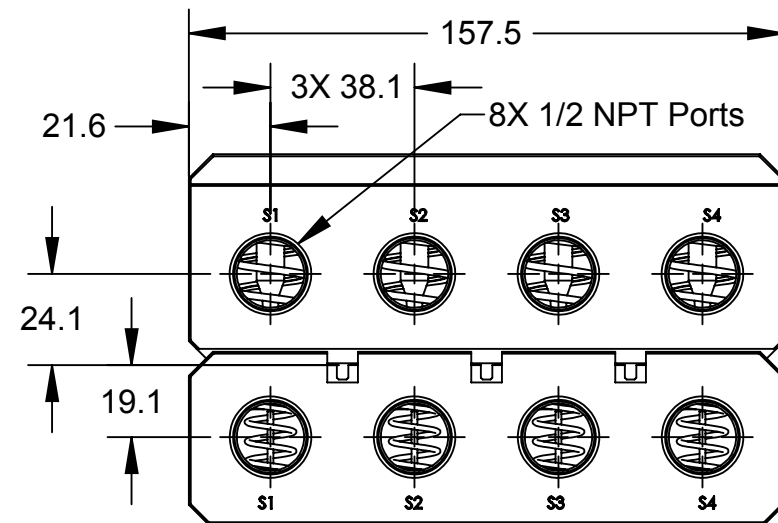
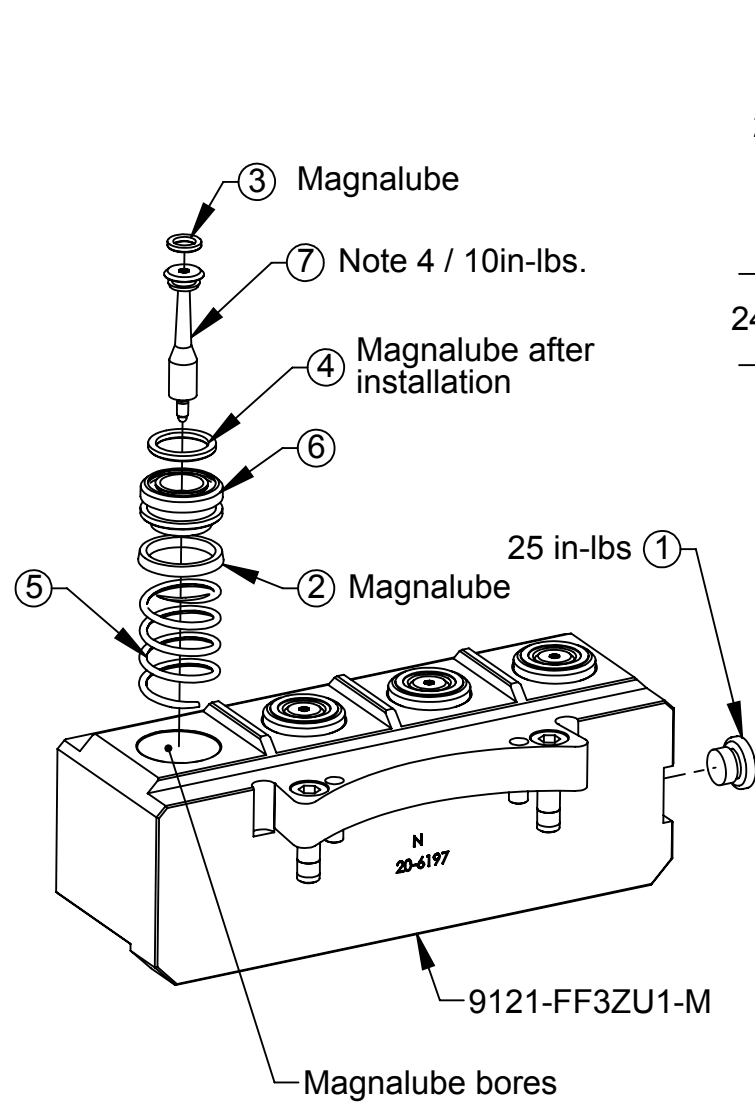

Notes:

Materials of Construction:

1. Housings - Stainless Steel
2. Valve Components - Stainless Steel, PVC & Viton
3. G 1/8 Plug - Nickel Plated Brass
4. Replacement stem contains pre-applied thread locker. Use Loctite 7649 primer and Loctite 222 if reassembling with original stem.

Operations:

5. For best results ensure fluids are near neutral pH, minimize fluid particulate size and keep fluid module mating surfaces free and clear of any debris.
6. Checked ports can produce significant forces when under high supply pressures. See product manual regarding proper operating procedure.

ITEM NO.	QTY.	PART NUMBER	DESCRIPTION
1	1	3405-1000002-00	G1/8 Plug, Hex Socket, O-Ring Seal
2	4	3410-0001124-01	U-CUP SEAL, 18x22, VITON
3	4	3410-0001229-01	O-Ring 6MM X 2MM, Viton
4	4	3410-0001230-01	O-Ring 14MM X 2MM, Viton
5	4	3700-20-1459	SW-150A Master Fluid / Air Spring SS
6	4	3700-20-2994	Master Check Valve Piston, FA44
7	4	3700-20-2996	VALVE STEM, HIGH STRENGTH

Note: Service Kit 9005-20-2450 consists of (1) each of items 2, 3, 4 & 5.

ITEM NO.	QTY.	PART NUMBER	DESCRIPTION
1	4	3410-0001218-01	O-ring, 10mm x 2mm, Viton, Dur. 75
2	4	3410-0001231-01	O-ring, Viton, ID 18mm x 1mm wall
3	4	3700-20-1457	SW-150A Tool Check Valve Piston
4	4	3700-20-1460	SPRING, F/A TOOL
5	4	9005-20-1515	3/8" Check Port Long Plug with Dowel

Note: Service Kit 9005-20-2451 consists of (1) each of items 1, 2 & 4.

NOTES: UNLESS OTHERWISE SPECIFIED.

DO NOT SCALE DRAWING. ALL DIMENSIONS ARE IN MILLIMETERS.



3rd ANGLE PROJECTION



1031 Goodworth Drive, Apex, NC 27539, USA
 Tel: +1.919.772.0115 Email: info@ati-ia.com
 Fax: +1.919.772.8259 www.ati-ia.com
 ISO 9001 Registered Company

PROPERTY OF ATI INDUSTRIAL AUTOMATION, INC. NOT TO BE REPRODUCED IN ANY MANNER EXCEPT ON ORDER OR WITH PRIOR WRITTEN AUTHORIZATION OF ATI.

DRAWN BY: D. Wagner 6/1/15		TITLE	
CHECKED BY: DKL 6/2/15		FF3ZU1 Module Drawing	
PROJECT #	SHEET 1 OF 1	SCALE	SIZE
		1:2	B
DRAWING NUMBER		REVISION	
9630-20-FF3ZU1		02	