

PROPERTY OF ATI INDUSTRIAL AUTOMATION, INC.  
 NOT TO BE REPRODUCED IN ANY MANNER EXCEPT ON  
 ORDER OR WITH PRIOR WRITTEN AUTHORIZATION OF ATI.

Rev.	Description	Initiator	Date
02	Initial Issue	PS	9/13/2004

**E10-010 Master Module  
 (9120-E10M-010)**

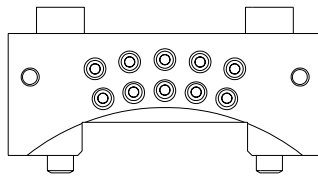
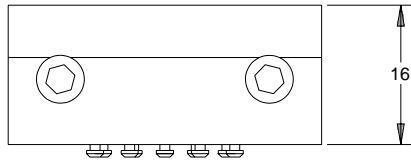

**E10-010 Tool Module  
 (9120-E10T-010)**

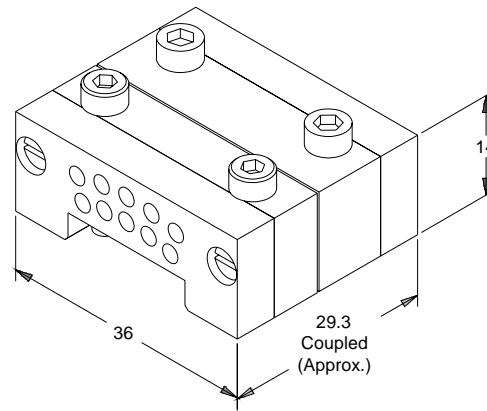
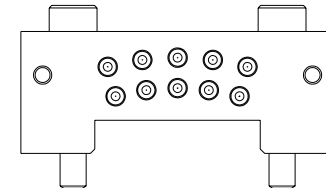
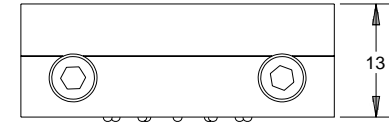

NOTES: UNLESS OTHERWISE SPECIFIED  
 DO NOT SCALE DRAWING. DRAWN IN SOLIDWORKS.  
 ALL DIMENSIONS ARE IN MILLIMETERS.



1031 Goodworth Drive, Apex, NC 27539, USA  
 Tel: +1.919.772.0115 Email: info@ati-ia.com  
 Fax: +1.919.772.8259 www.ati-ia.com  
 ISO 9001 Registered Company

- Notes:
- The E10-010 is a customer configurable 10-pin module designed to fit the QC-10, providing 3A/50V rated gold plated contacts with solder connections in a miniature size.

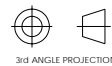

DRAWN BY: P.Sparrow 6/13/03	TITLE: E10-010 Module Drawing		
CHECKED BY: B.Digeso, 10/29/04	SCALE: 2:1	SIZE: B	DRAWING NUMBER: 9630-20-E10-010-02
WEIGHT LBS: .05	PRODUCT RELEASE # 030725-3 DATE: SHEET 1 OF 1		
ASSEMBLY REF:			