

Rev.	Description	Initiator	Date
05	ECO 13117; Changed 4-Pin Male Mini note to 5-Pin Male Mini in top view of drawing.	TBC	8/19/2015

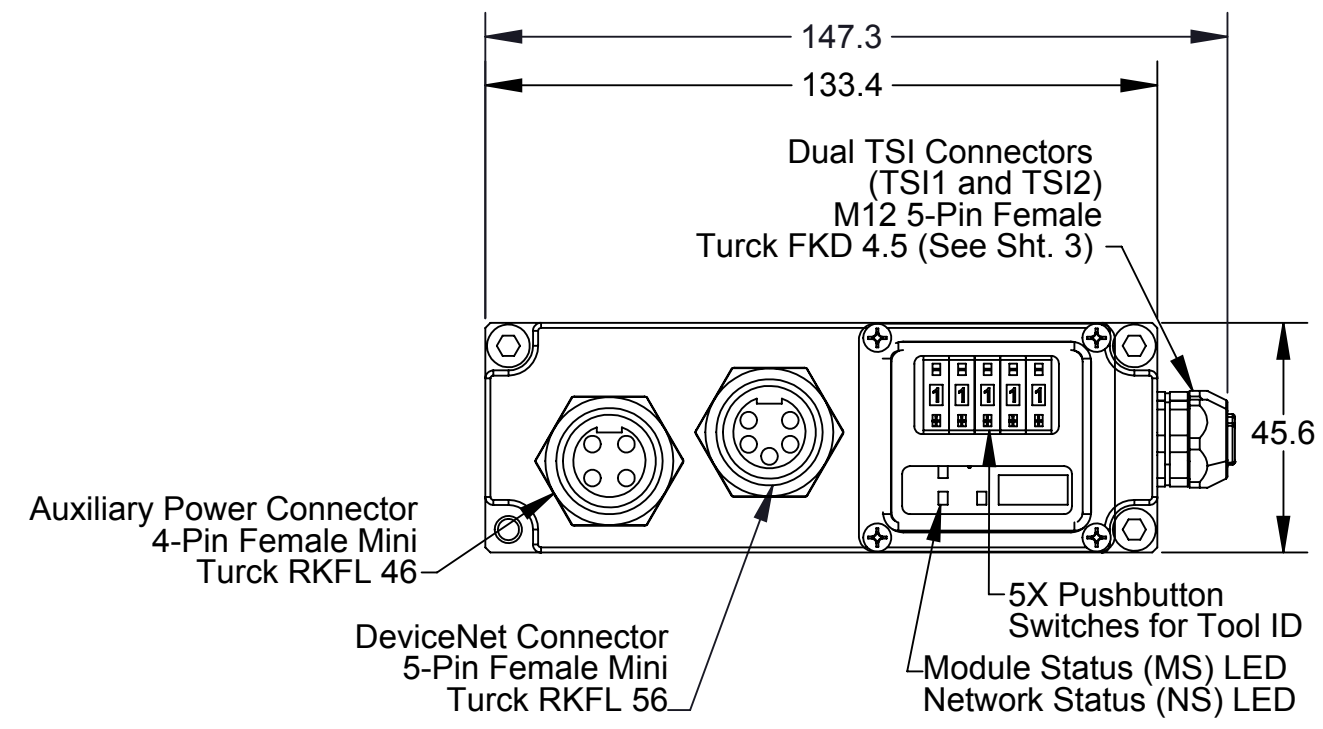
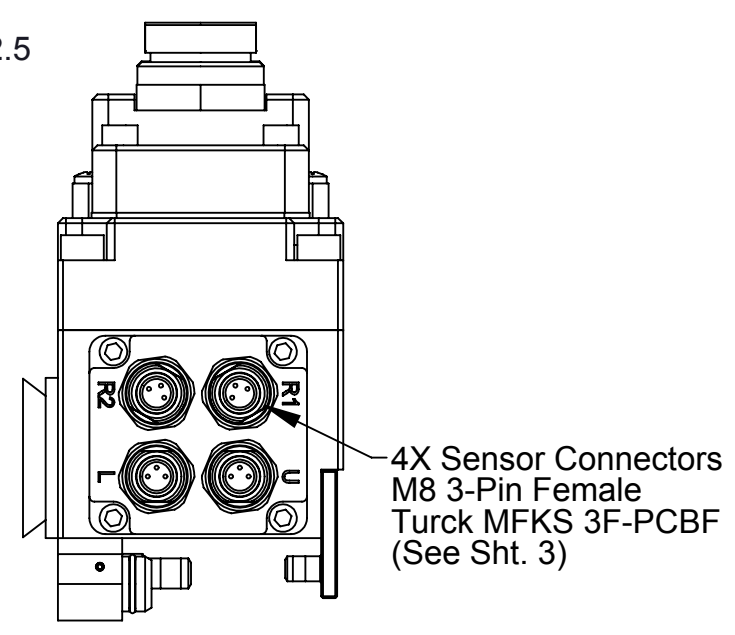
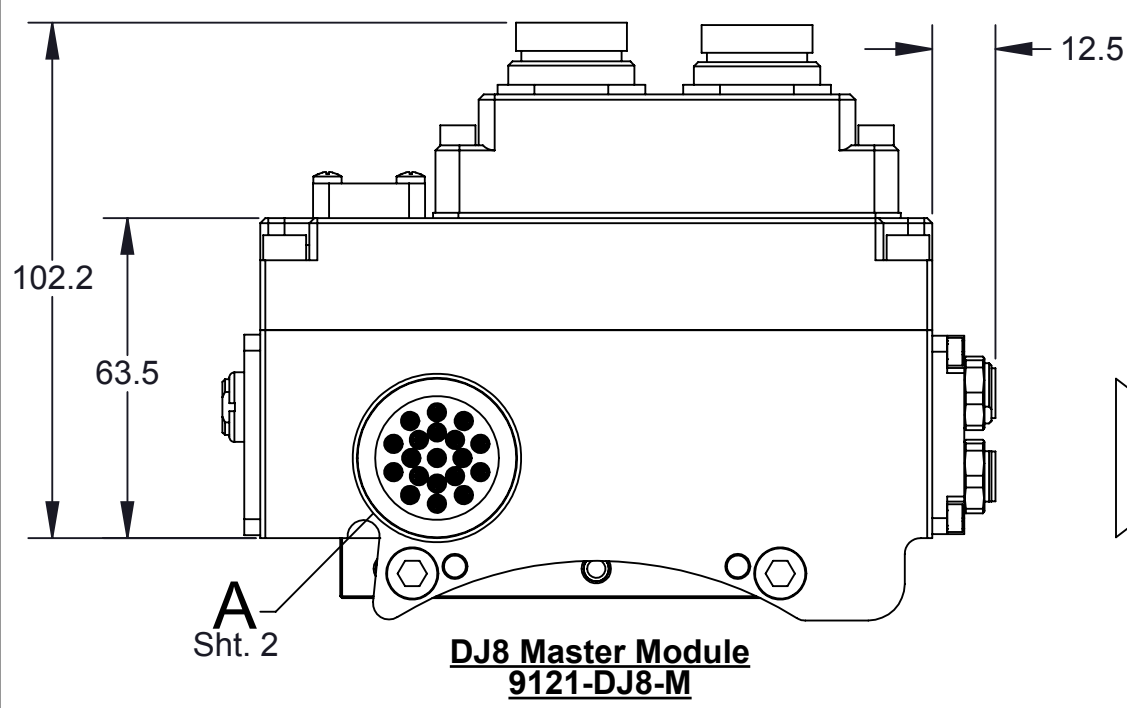
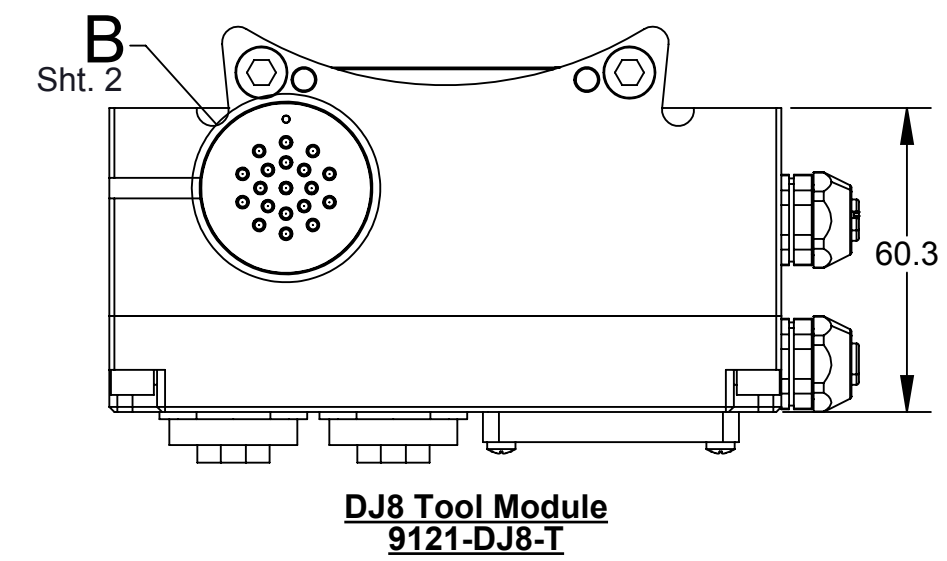
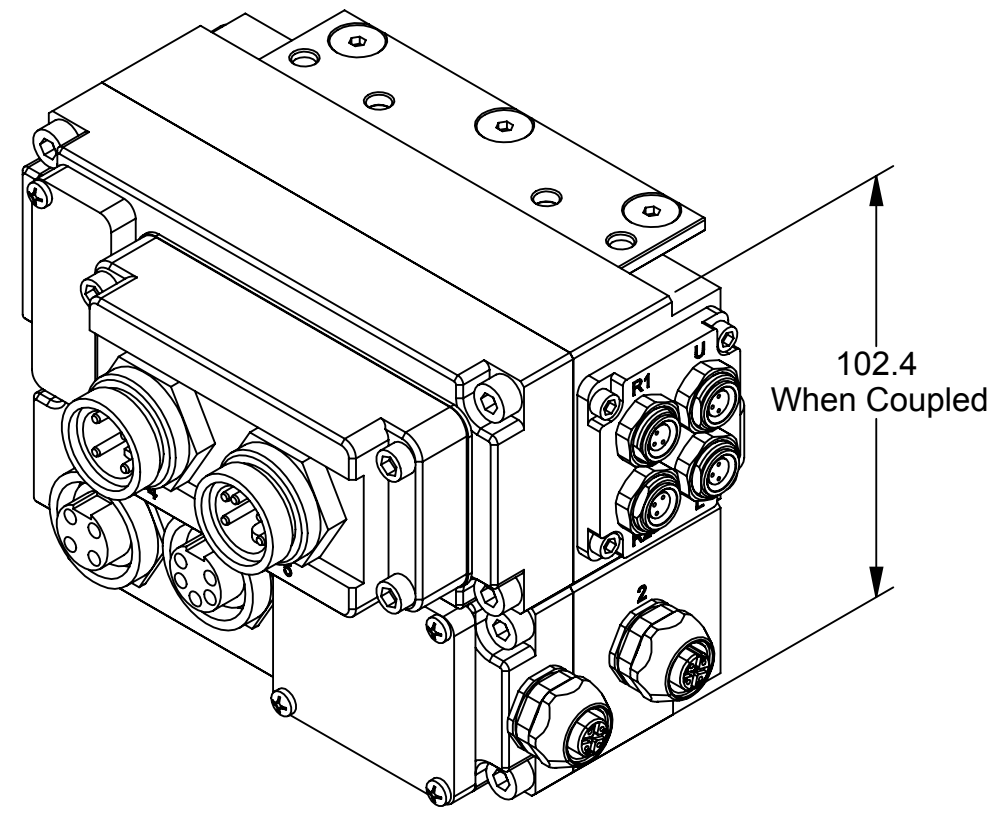
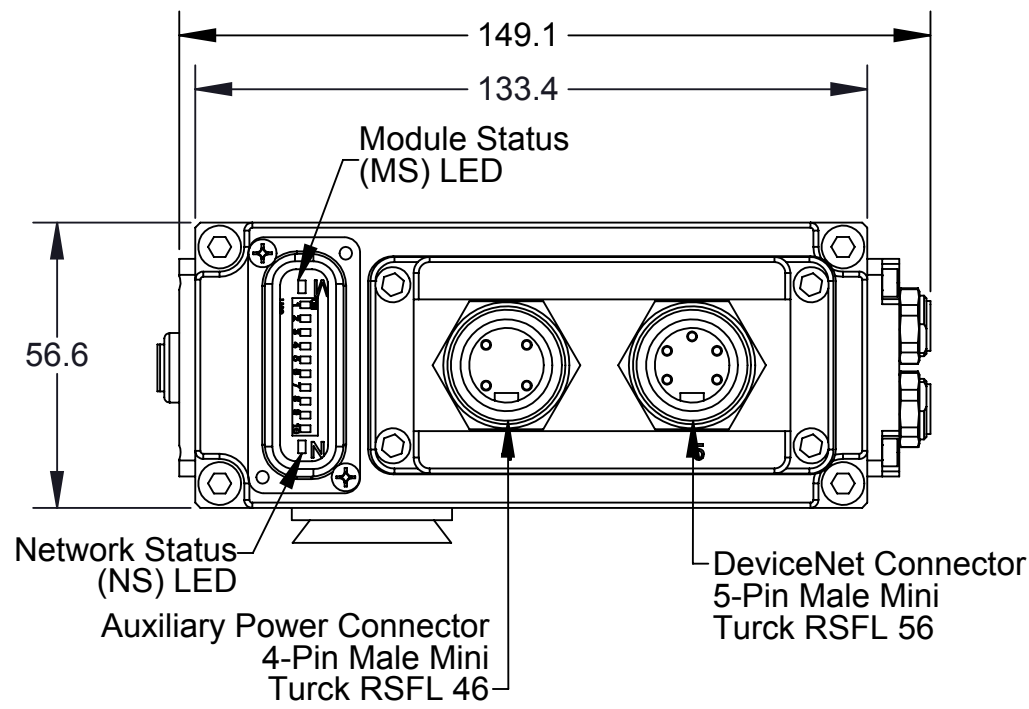

- Notes:
- The modules are shown at sheet scale. All connector face views are shown at a 2:1 scale, except as noted.
 - Serviceable parts for the DJ8 modules are shown on Sheet 4. The electrical schematic is shown on Sheet 5.
 - Unless otherwise noted, the Auxiliary Power and Devicenet connectors are oriented as shown in this drawing.
 - Valve adapters integrated with the DJ8 Master module **must be single-solenoid**.

NOTES: UNLESS OTHERWISE SPECIFIED.

DO NOT SCALE DRAWING. ALL DIMENSIONS ARE IN MILLIMETERS.

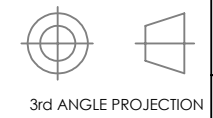

1031 Goodworth Drive, Apex, NC 27539, USA
Tel: +1.919.772.0115 Email: info@ati-ia.com
Fax: +1.919.772.8259 www.ati-ia.com
ISO 9001 Registered Company

PROPERTY OF ATI INDUSTRIAL AUTOMATION, INC. NOT TO BE REPRODUCED IN ANY MANNER EXCEPT ON ORDER OR WITH PRIOR WRITTEN AUTHORIZATION OF ATI.

DRAWN BY: W. Berrocal, 4/17/14		TITLE	
CHECKED BY: A. Strotzer, 4/25/14		DJ8 Dual Redundant Devicenet Module	
PROJECT # 140220-1	SHEET 1 OF 5	SCALE 2:3	SIZE B
		DRAWING NUMBER 9630-20-DJ8	REVISION 05

Rev.	Description	Initiator	Date
-	See Sheet1	-	-

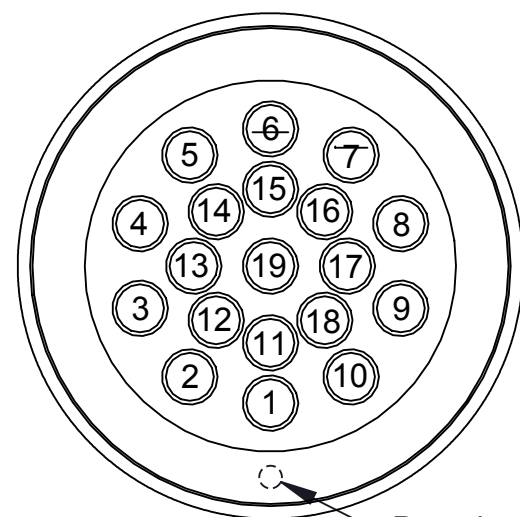

**Master Pin Block
(See Table 1)
DETAIL A**

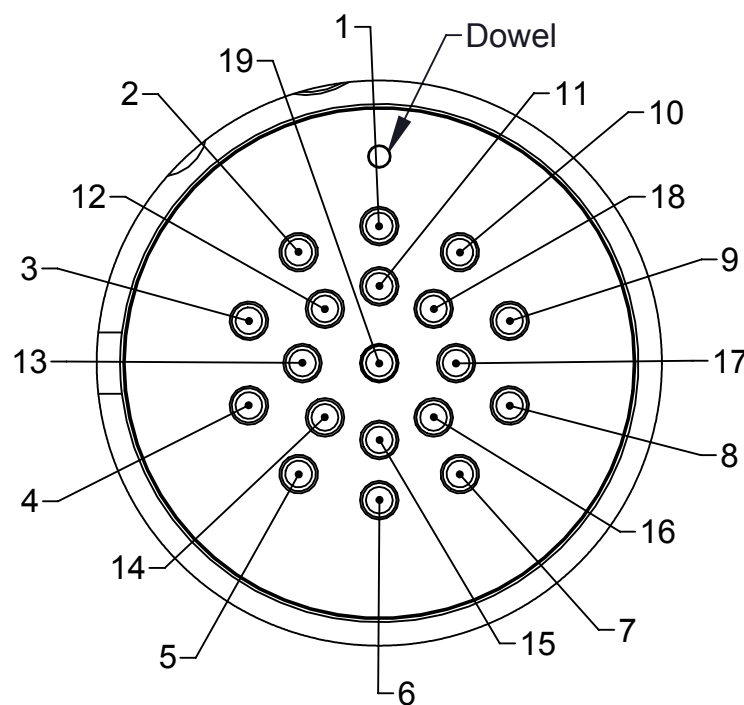

**Tool Pin Block
(See Table 1)
DETAIL B**

Table 1: Pin Designations

1	AUX2 V+_AP
2	AUX1 V+_AP
3	CAN V+_AP
4	Drain
5	TSI IN
6	CAN V-
7	AUX1 V-
8	TSI OUT
9	DRx
10	CAN V+ (TSI)
11	TSRV2
12	TSIV1
13	TSRV1
14	CAN_L
15	CAN_H
16	AUX2 V-
17	DTx
18	TSIV2
19	Tool Presence

NOTES: UNLESS OTHERWISE SPECIFIED.

DO NOT SCALE DRAWING.
ALL DIMENSIONS ARE IN
MILLIMETERS.



3rd ANGLE PROJECTION



1031 Goodworth Drive, Apex, NC 27539, USA
Tel: +1.919.772.0115 Email: info@ati-ia.com
Fax: +1.919.772.8259 www.ati-ia.com
ISO 9001 Registered Company

PROPERTY OF ATI INDUSTRIAL AUTOMATION, INC. NOT TO BE REPRODUCED IN ANY MANNER EXCEPT ON ORDER OR WITH PRIOR WRITTEN AUTHORIZATION OF ATI.

DRAWN BY: W. Berrocal, 4/17/14

CHECKED BY: A. Strotzer, 4/25/14

TITLE

DJ8 Dual Redundant Devicenet Module

PROJECT # 140220-1 SHEET 2 OF 5

SCALE
2:3

SIZE
B

DRAWING NUMBER
9630-20-DJ8

REVISION
05

1	Drain
2	CAN V+
3	CAN V-
4	CAN_H
5	CAN_L

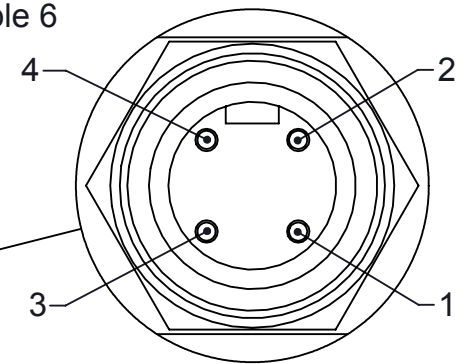
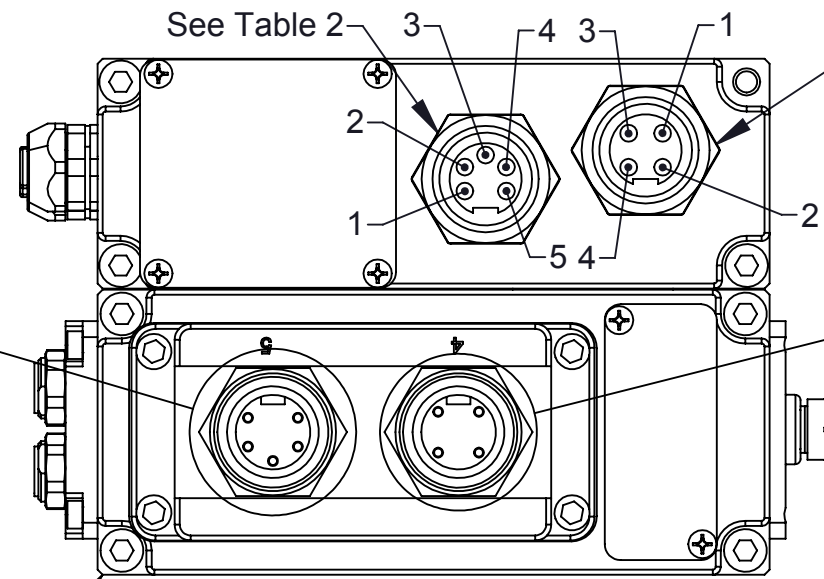
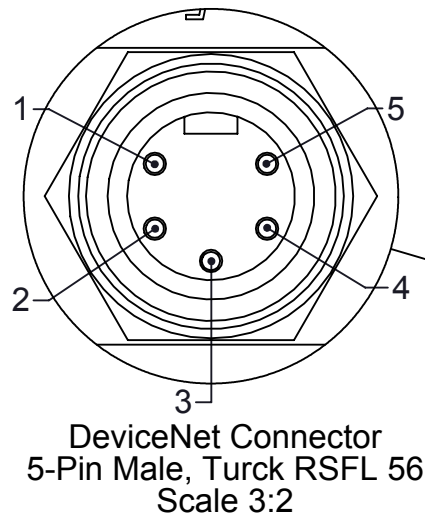

1	Aux1 V+
2	Aux2 V+
3	Aux2 V-
4	Aux1 V-

Tool Changer Integrated Proximity
Sensor I/O Connections
4X Turck MFKS 3F-PCBF
(Cables Provided by ATI, Not Shown)

9121-DJ8-T

TSI1 Connector
Turck FKD 4.5
Note Orientation
(See Table 3)

TSI2 Connector
Turck FKD 4.5
Note Orientation
(See Table 3)

Cleat hidden
for clarity

9121-DJ8-M

Cleat hidden
for clarity

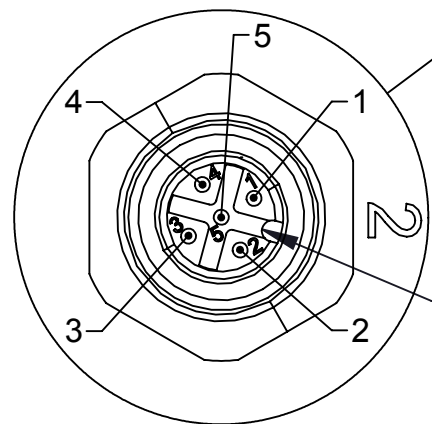

TSI Connectors (TSI1 and TSI2)
M12 5-Pin Female
Turck FKD 4.5
Scale 2:1

1	CAN V+
2	CAN V+
3	TSI Relay Control
4	TSIV Input
5	N/C

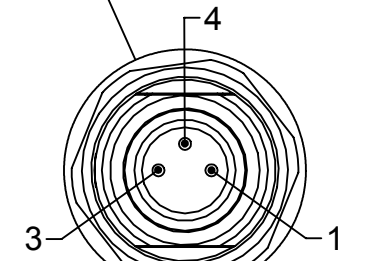

1	CAN V+
3	CAN V-
4	Sensor Input

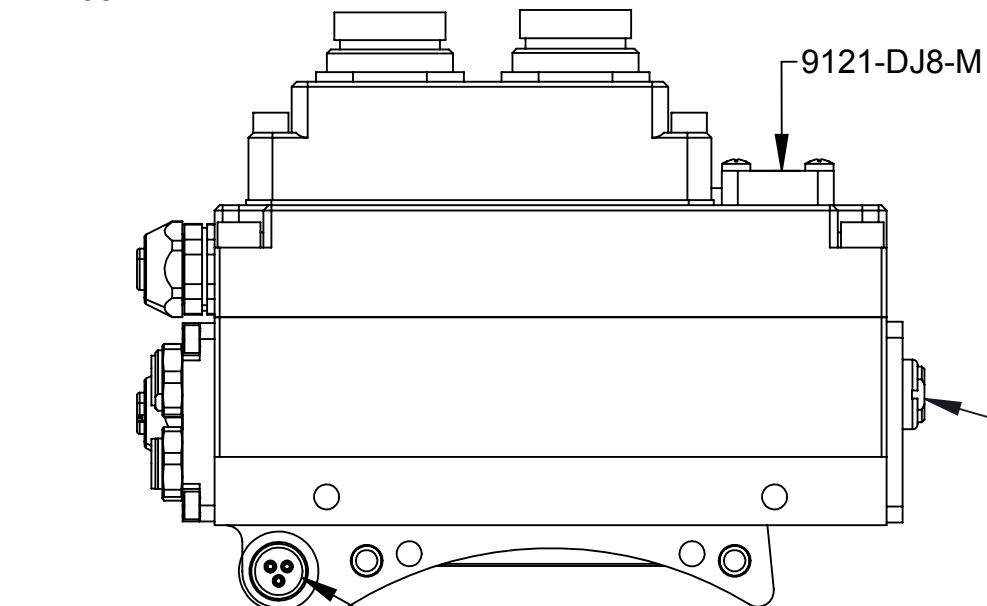

Programming Connector
4-Pin M8 Female
Turck MFKS 4F
ATI USE ONLY

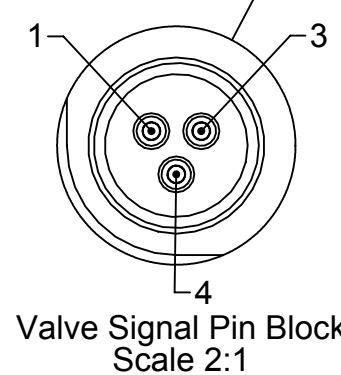

Integrated Tool Changer
Valve Connection
(Interfaces with Valve
Adapter Module, Not Shown)

1	Unlatch
3	AUX1 V-
4	Latch

NOTES: UNLESS OTHERWISE
SPECIFIED.

DO NOT SCALE DRAWING.
ALL DIMENSIONS ARE IN
MILLIMETERS.



1031 Goodworth Drive, Apex, NC 27539, USA
Tel: +1.919.772.0115 Email: info@ati-ia.com
Fax: +1.919.772.8259 www.ati-ia.com
ISO 9001 Registered Company

PROPERTY OF ATI INDUSTRIAL AUTOMATION, INC. NOT TO BE REPRODUCED IN ANY MANNER
EXCEPT ON ORDER OR WITH PRIOR WRITTEN AUTHORIZATION OF ATI.

DRAWN BY: W. Berrocal, 4/17/14

CHECKED BY: A. Strotzer, 4/25/14

TITLE
DJ8 Dual Redundant Devicenet Module

PROJECT # 140220-1 SHEET 3 OF 5

SCALE	SIZE	DRAWING NUMBER	REVISION
1:1	B	9630-20-DJ8	05

DJ8 Master and Tool Serviceable Parts

Rev.	Description	Initiator	Date
-	See Sheet 1	-	-

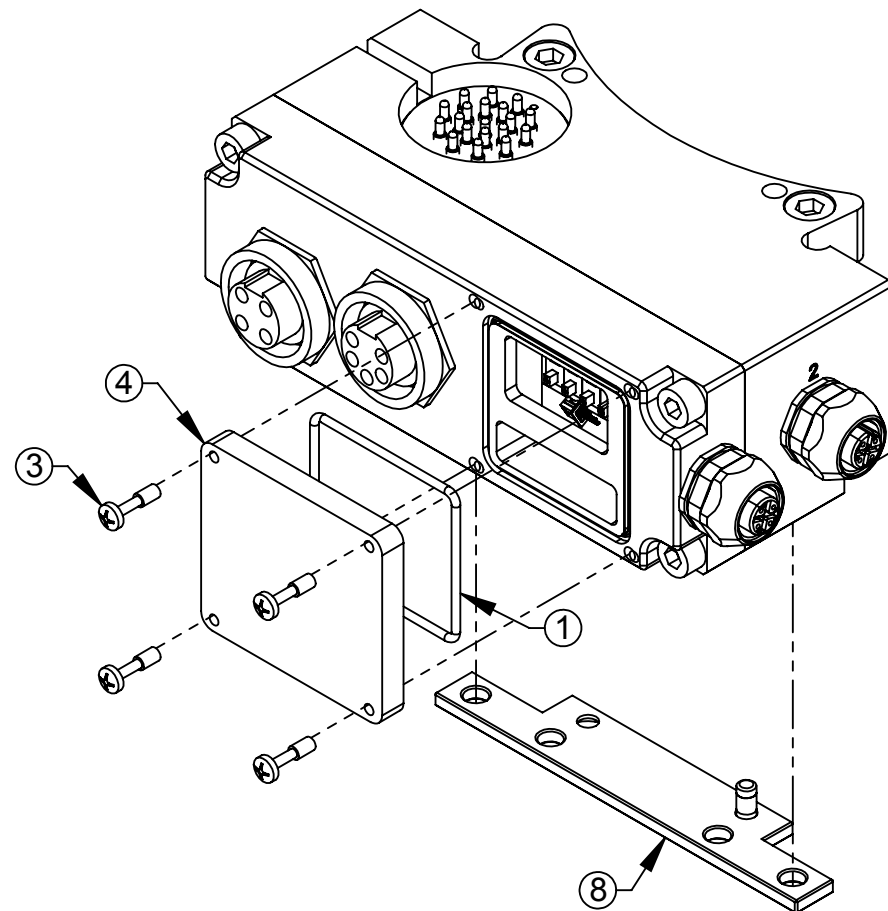
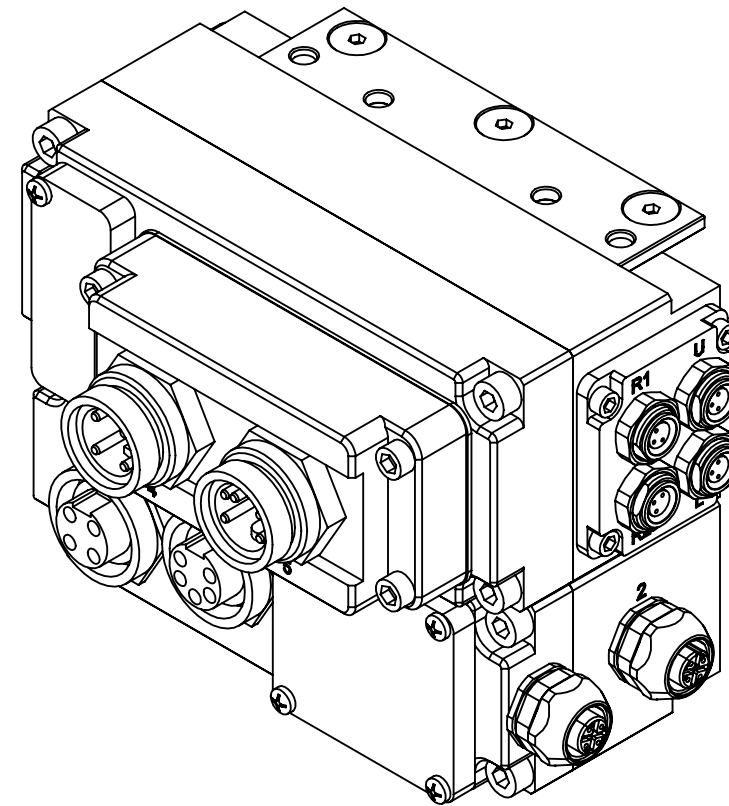
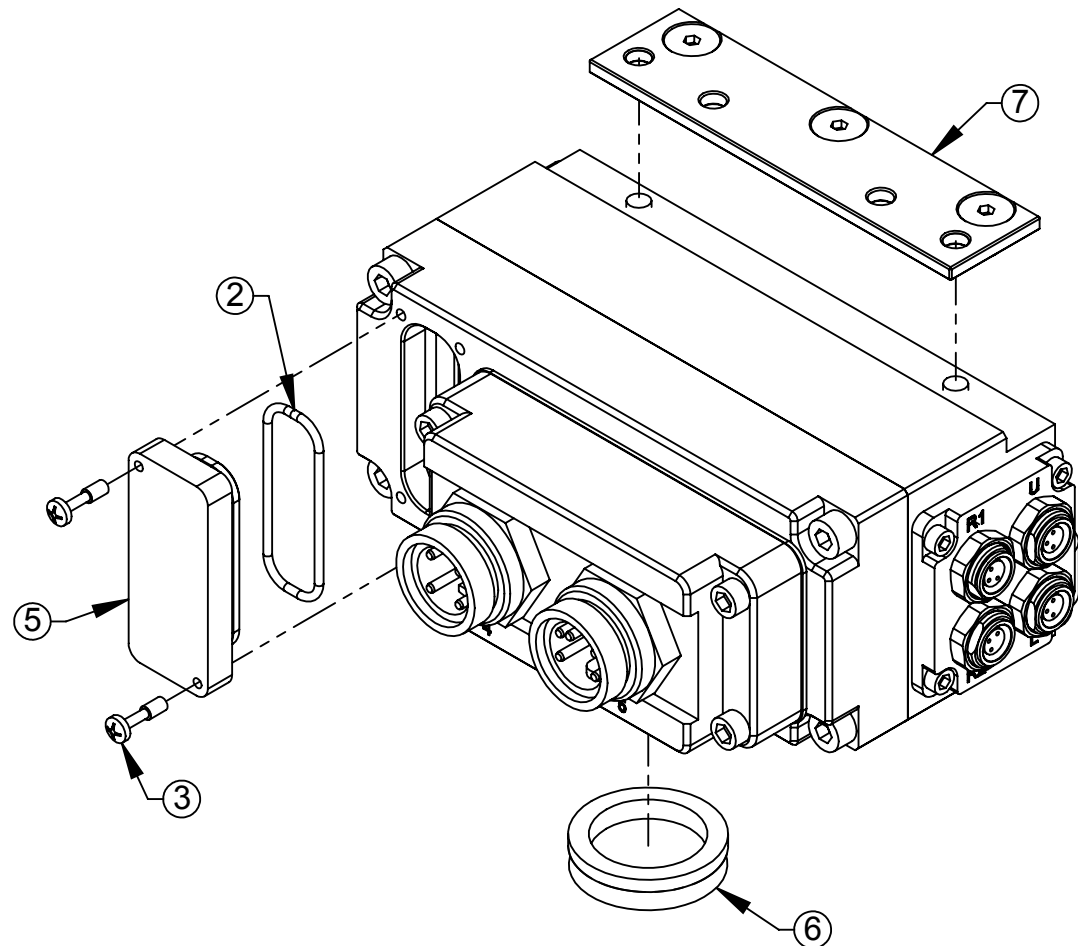

ITEM NO.	QTY.	PART NUMBER	DESCRIPTION
1	1	3410-0001021-01	O-ring, AS568-031
2	1	3410-0001201-01	O-ring, AS568-024
3	6	3500-9957012-21	Captive Screw M3 x 12 Slotted Head SS
4	1	3700-20-3058	Tool ID Window
5	1	3700-20-4820	Window, Master, DJ Module, Annular Seal
6	1	4010-0000030-01	V-Ring Seal
7	1	9005-20-1198	Master Cleat Assembly
8	1	9005-20-1199	Tool Cleat Assembly

NOTES: UNLESS OTHERWISE SPECIFIED.

DO NOT SCALE DRAWING. ALL DIMENSIONS ARE IN MILLIMETERS.



3rd ANGLE PROJECTION



1031 Goodworth Drive, Apex, NC 27539, USA
 Tel: +1.919.772.0115 Email: info@ati-ia.com
 Fax: +1.919.772.8259 www.ati-ia.com
 ISO 9001 Registered Company

PROPERTY OF ATI INDUSTRIAL AUTOMATION, INC. NOT TO BE REPRODUCED IN ANY MANNER EXCEPT ON ORDER OR WITH PRIOR WRITTEN AUTHORIZATION OF ATI.

DRAWN BY: W. Berrocal, 4/17/14		TITLE	
CHECKED BY: A. Strotzer, 4/25/14		DJ8 Dual Redundant Devicenet Module	
PROJECT # 140220-1	SHEET 4 OF 5	SCALE 2:3	SIZE B
		DRAWING NUMBER 9630-20-DJ8	REVISION 05

9121-DJ8-M

9121-DJ8-T

Rev.	Description	Initiator	Date
-	See Sheet1	-	-

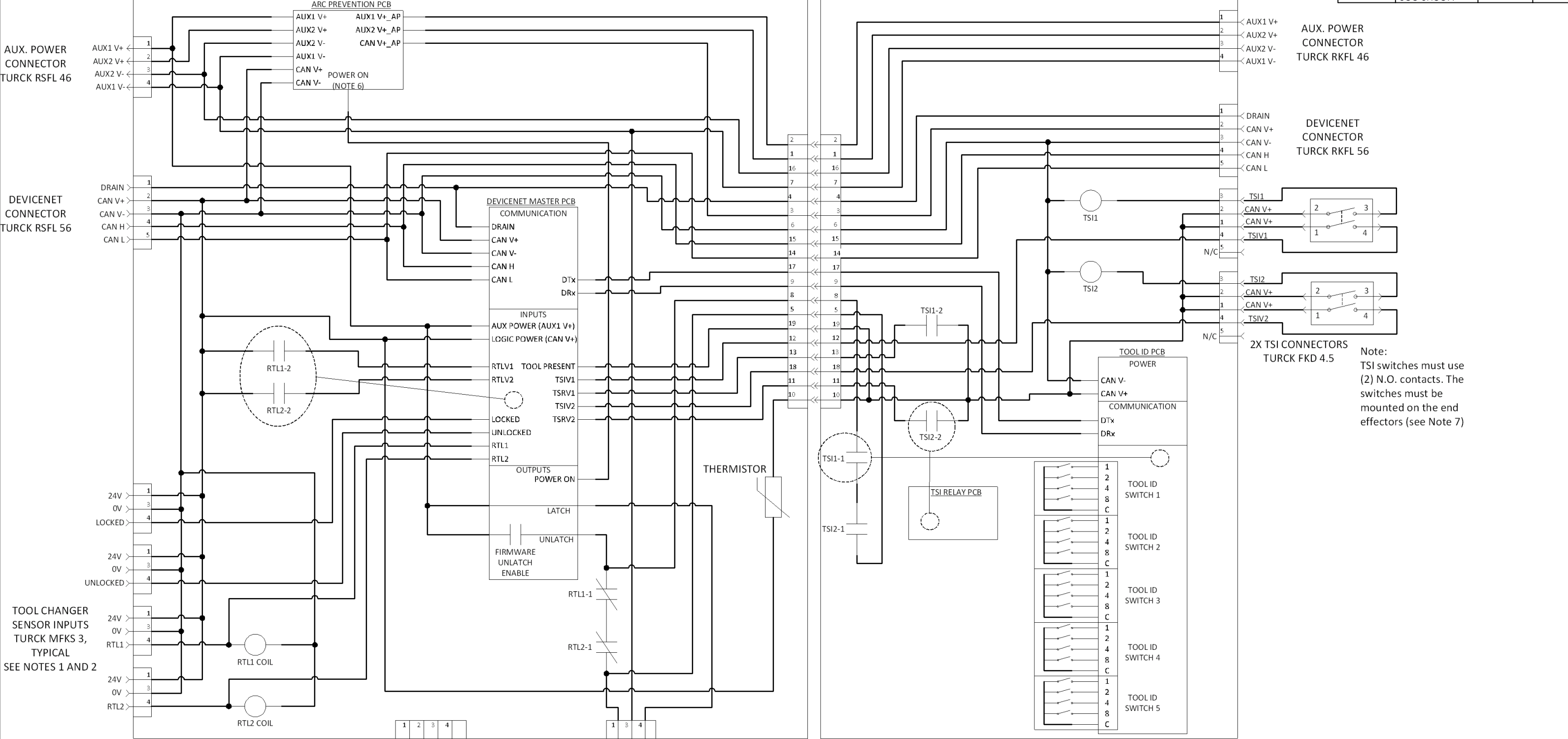

Note:
TSI switches must use (2) N.O. contacts. The switches must be mounted on the end effectors (see Note 7)

- Schematic Notes:**
- The sensors are powered by Input power.
 - The complete tool changer package comes equipped with external cables that are connected to the sensors.
 - An internal pin block is used to transmit the Latch/Unlatch signal to the valve adapter.
 - Cables for DeviceNet and Auxiliary Power are supplied by the customer.
 - The Tool ID I/O is reported in the DJ8 Master Bitmap. Refer to the product manual for more information.
 - The Arc Prevention Circuit turns off Output and Input Power during coupling and uncoupling of the Tool Changer. The switching function is controlled by the POWER ON signal from the Ethernet Master PCB. The TOOL PRESENT input is used to ensure that the spring/contact pins are touching when power is turned on. Refer to the manual for additional information.
 - The DJ8 supports the use of (2) mechanical limits switches for integration with dual redundant TSI. The limit switches connected to the TSI connectors must have two sets of N.O. contacts (double-pole, single-throw). A limit switch is available from ATI (PN 9005-20-1165) but is not included with the DJ8 modules. Contact ATI for specific switch requirements.
 - TSI related error bits are not shown on this schematic but are reported in the DJ8 Master Bitmap. Refer to the product manual for details.

NOTES: UNLESS OTHERWISE SPECIFIED.

DO NOT SCALE DRAWING. ALL DIMENSIONS ARE IN MILLIMETERS.



1031 Goodworth Drive, Apex, NC 27539, USA
 Tel: +1.919.772.0115 Email: info@ati-ia.com
 Fax: +1.919.772.8259 www.ati-ia.com
 ISO 9001 Registered Company

PROPERTY OF ATI INDUSTRIAL AUTOMATION, INC. NOT TO BE REPRODUCED IN ANY MANNER EXCEPT ON ORDER OR WITH PRIOR WRITTEN AUTHORIZATION OF ATI.

DRAWN BY: W. Berrocal, 4/17/14		TITLE	
CHECKED BY: A. Strotzer, 4/25/14		DJ8 Dual Redundant Devicenet Module	
PROJECT # 140220-1	SHEET 5 OF 5	SCALE 1:1	SIZE B
DRAWING NUMBER 9630-20-DJ8		REVISION 05	