

AR4 Master Module
(9121-AR4-M)

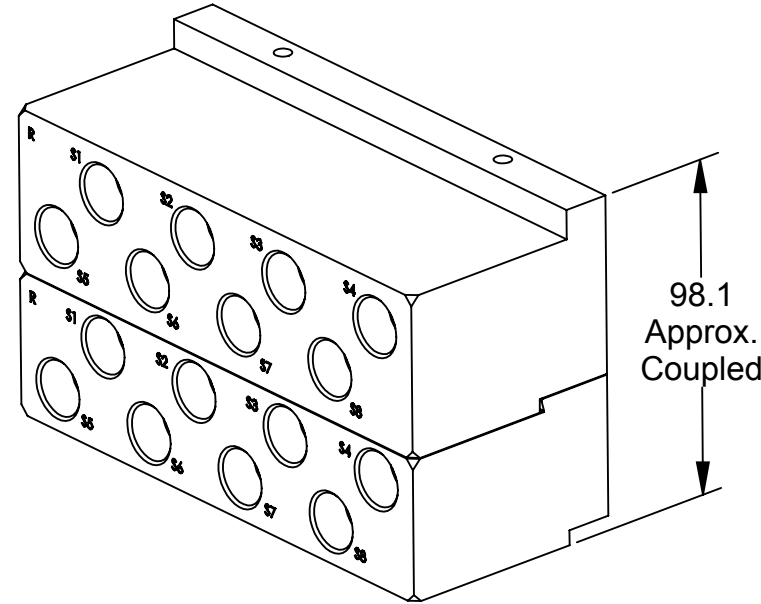

AR4 Tool Module (9121-AR4-T)
AR5 Tool Module (9121-AR5-T)
AR7 Tool Module (9121-AR7-T)

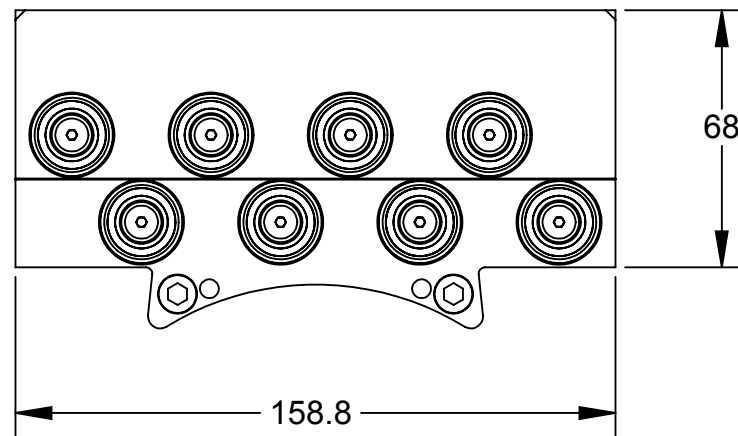
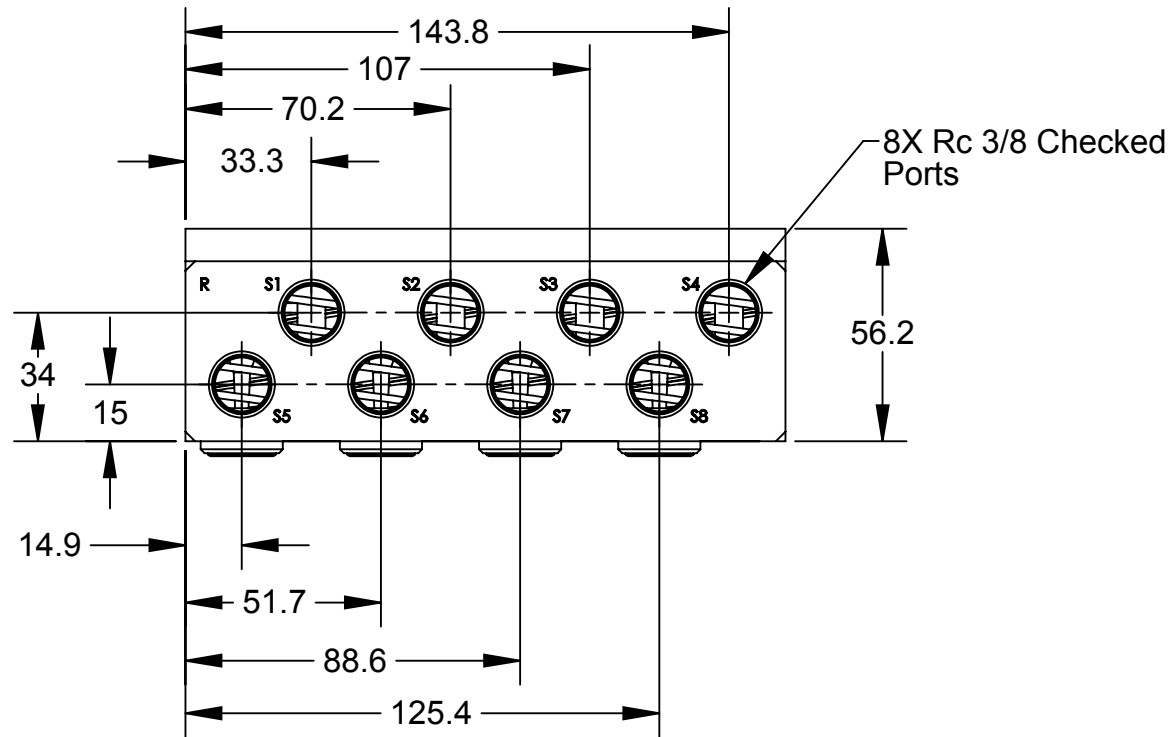
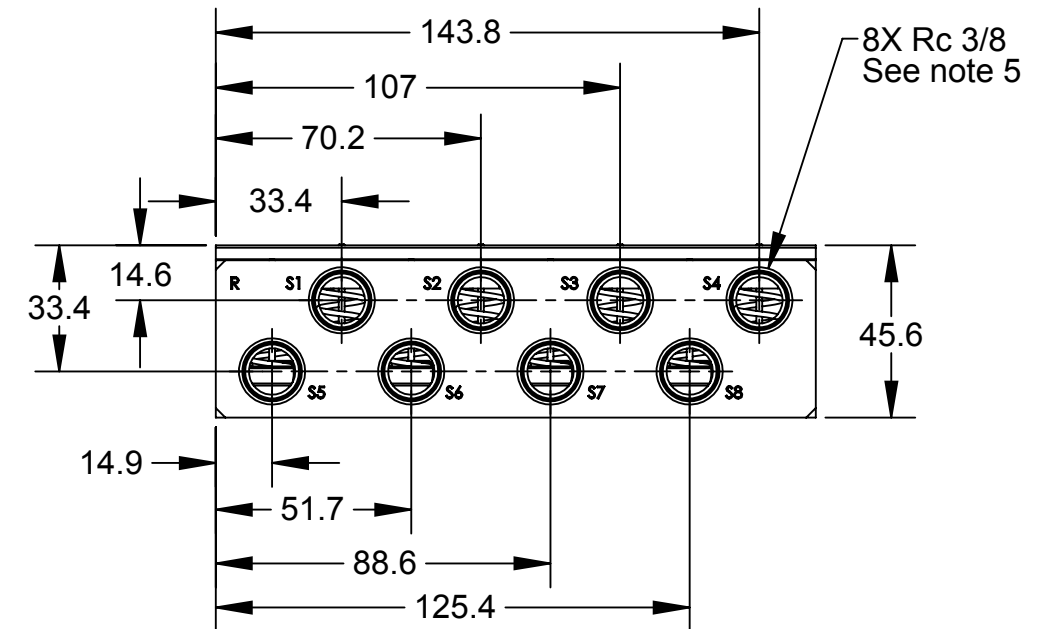
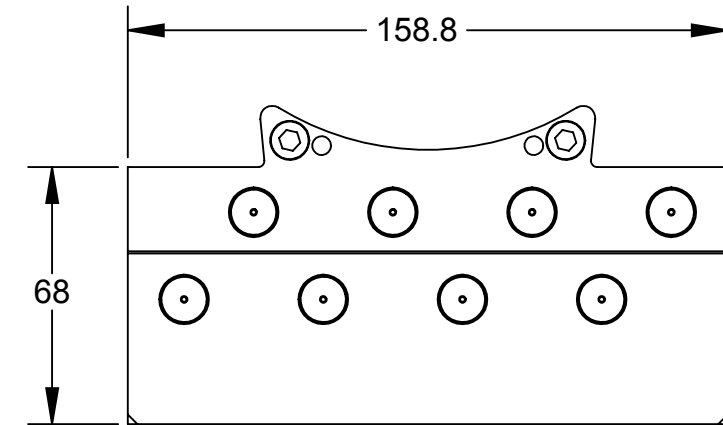

Notes:

Materials of Construction:

- Housings - Anodized aluminum.
- Valve Components - Stainless Steel, Nitrile & PVC
- Replacement stem contains pre-applied thread locker. Use Loctite 7649 primer and Loctite 222 if reassembling with original stem.

Operations:

- For best results keep air module mating surfaces free and clear of any debris.
- Checked ports can produce significant forces when under high supply pressures. These forces have to be overcome to achieve tool changer coupling.
- Checked ports do not support vacuum conditions.
- AR4-M master module has (8) Rc 3/8 checked ports for air service.
- AR4-T tool module has (8) checked Rc 3/8 ports for air service.
- AR5-T tool module has (8) pass thru Rc 3/8 ports for air service.
- AR7-T tool module has (4) pass thru Rc 3/8 ports (top row S1 thru S4) and (4) checked Rc 3/8 ports (bottom row S5 thru S8) for air service.

Rev.	Description	Initiator	Date
04	ECO 14747; Added torque and Magnalube information, added Note 3, and replaced 3540-0101750-21 & 3700-20-4121 with 9005-20-1515 in drawing BOMs (all 8 instances in 9121-AR4-T (sht 2) and 4 instances in 9121-AR7-T (sht 3)).	SZJ	9/19/2016

NOTES: UNLESS OTHERWISE SPECIFIED.

DO NOT SCALE DRAWING. ALL DIMENSIONS ARE IN MILLIMETERS.



3rd ANGLE PROJECTION



1031 Goodworth Drive, Apex, NC 27539, USA
Tel: +1.919.772.0115 Email: info@ati-ia.com
Fax: +1.919.772.8259 www.ati-ia.com
ISO 9001 Registered Company

PROPERTY OF ATI INDUSTRIAL AUTOMATION, INC. NOT TO BE REPRODUCED IN ANY MANNER EXCEPT ON ORDER OR WITH PRIOR WRITTEN AUTHORIZATION OF ATI.

DRAWN BY: D. Wagner 11/26/12		TITLE	
CHECKED BY: DKL 11/28/12		AR4/AR5/AR7 Module Drawing	
PROJECT # 120905-1	SHEET 1 OF 3	SCALE 1:2	SIZE B
		DRAWING NUMBER 9630-20-AR4	REVISION 04

Rev.	Description	Initiator	Date
-	See Sheet1	-	-

AR4 Master Module
(9121-AR4-M)

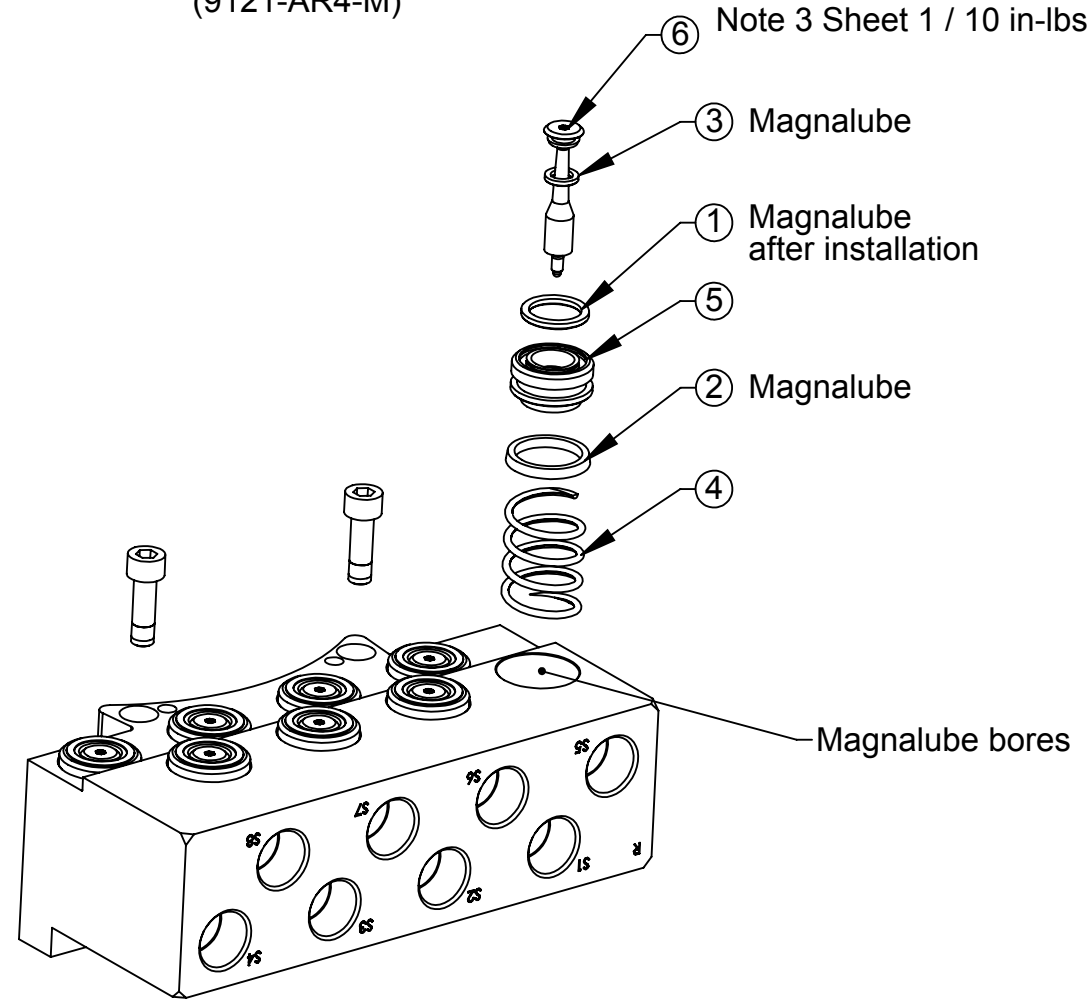

AR4 Tool Module
(9121-AR4-T)

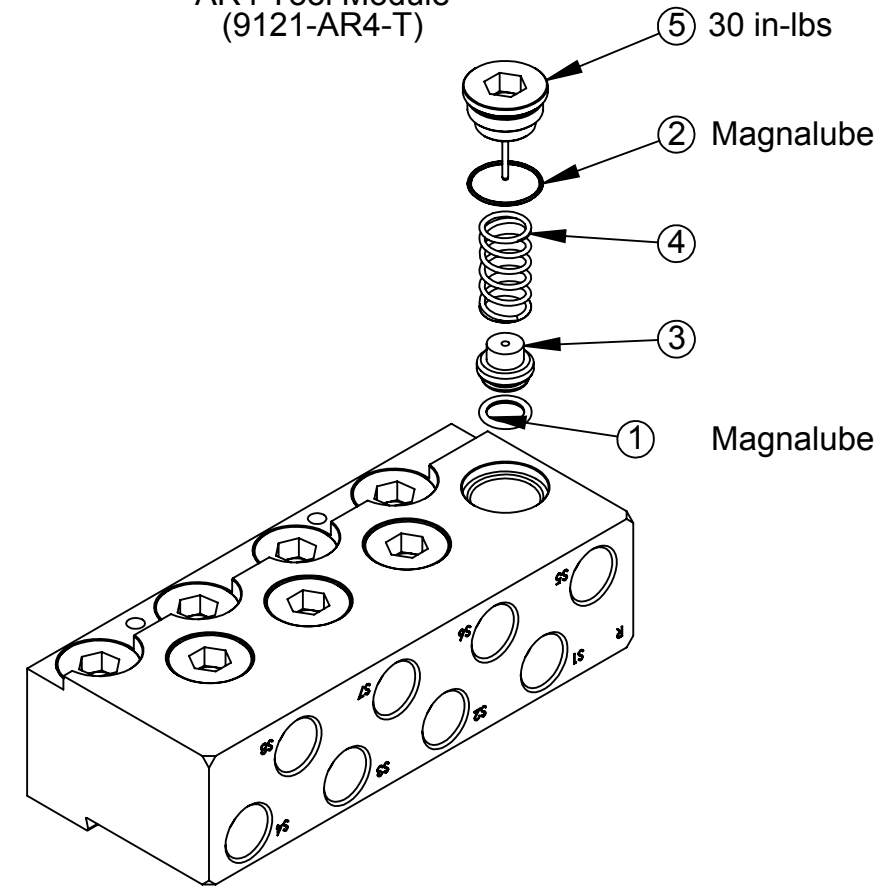

ITEM NO.	QTY.	PART NUMBER	DESCRIPTION
1	8	3410-0001065-01	O-Ring 14MM X 2MM Buna
2	8	3410-0001068-01	Mini U-Cup Seal 18mm ID x 22mm Buna
3	8	3410-0001183-01	O-Ring 6MM X 2MM Buna D90
4	8	3700-20-1459	SW-150A Master Fluid / Air Spring SS
5	8	3700-20-2994	Master Check Valve Piston, FA44
6	8	3700-20-2996	VALVE STEM, HIGH STRENGTH

Note: Service Kit 9120-F2-M-Kit consists of (1) each of items 1 thru 4.
 Note: Service Kit 9120-F4-M-Kit consists of (1) each of items 1 thru 6.

ITEM NO.	QTY.	PART NUMBER	DESCRIPTION
1	8	3410-0001067-01	O-ring, 10mm x 2mm, Buna N, Dur. 90
2	8	3410-0001284-01	O-ring, .669OD x .047 wall, 70D, Buna-N
3	8	3700-20-1457	SW-150A Tool Check Valve Piston
4	8	3700-20-1460	SPRING, F/A TOOL
5	8	9005-20-1515	Fluid/Air Long Plug for QC-210/310 Tool

Note: Service Kit 9120-F1-T-Kit consists of (1) each of items 1, 2, & 4.
 Note: Service Kit 9120-F5-T Kit consists of (1) each of items 1 thru 5.

NOTES: UNLESS OTHERWISE SPECIFIED.

DO NOT SCALE DRAWING. ALL DIMENSIONS ARE IN MILLIMETERS.



3rd ANGLE PROJECTION



1031 Goodworth Drive, Apex, NC 27539, USA
 Tel: +1.919.772.0115 Email: info@ati-ia.com
 Fax: +1.919.772.8259 www.ati-ia.com
 ISO 9001 Registered Company

PROPERTY OF ATI INDUSTRIAL AUTOMATION, INC. NOT TO BE REPRODUCED IN ANY MANNER EXCEPT ON ORDER OR WITH PRIOR WRITTEN AUTHORIZATION OF ATI.

DRAWN BY: D. Wagner 11/26/12		TITLE	
CHECKED BY: DKL 11/28/12		AR4/AR5/AR7 Module Drawing	
PROJECT # 120905-1	SHEET 2 OF 3	SCALE 1:2	SIZE B
		DRAWING NUMBER 9630-20-AR4	REVISION 04

Rev.	Description	Initiator	Date
-	See Sheet1	-	-

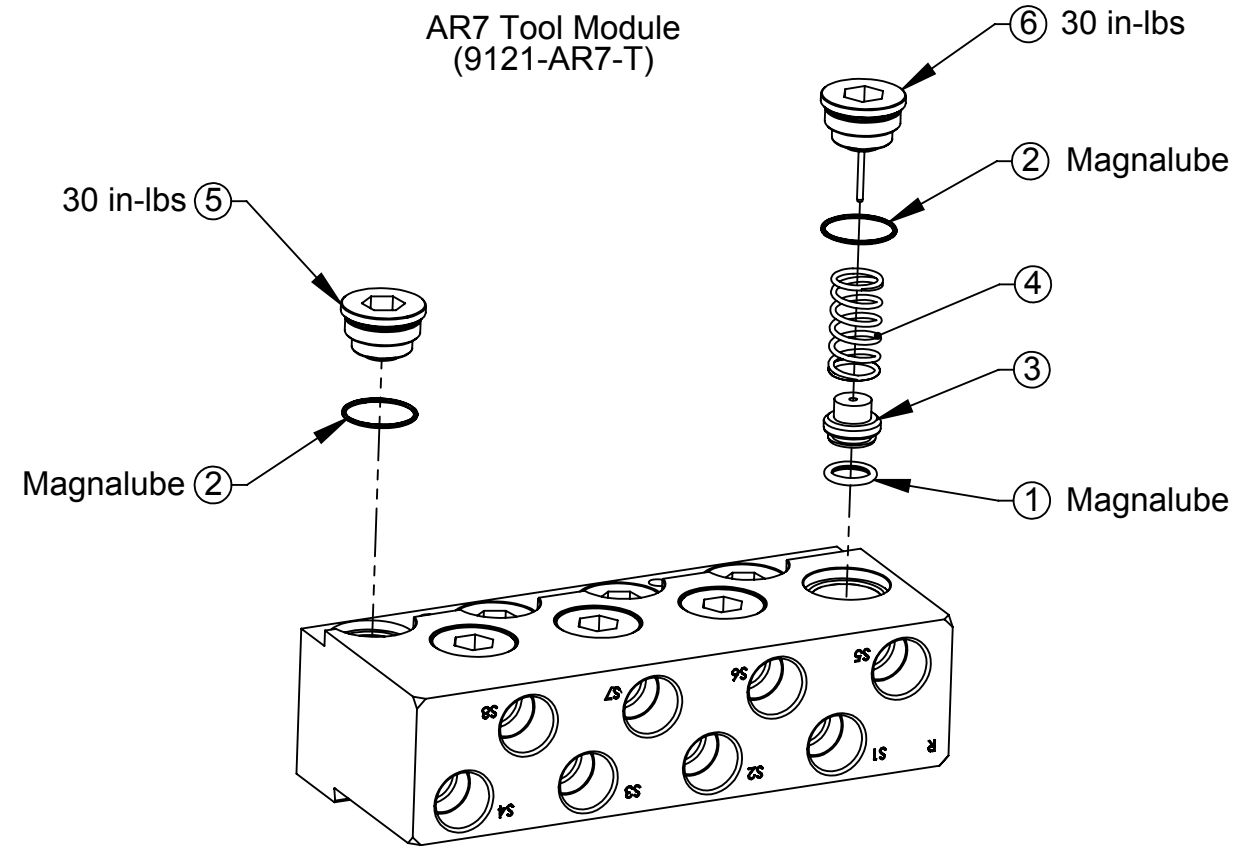
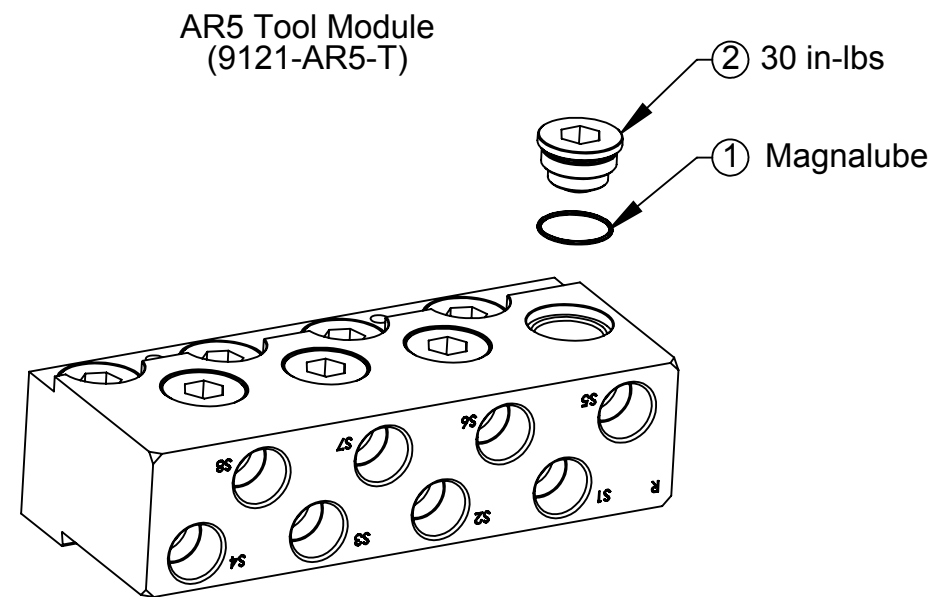

ITEM NO.	QTY.	PART NUMBER	DESCRIPTION
1	4	3410-0001067-01	O-ring, 10mm x 2mm, Buna N, Dur. 90
2	8	3410-0001284-01	O-ring, .669OD x .047 wall, 70D, Buna-N
3	4	3700-20-1457	SW-150A Tool Check Valve Piston
4	4	3700-20-1460	SPRING, F/A TOOL
5	4	3700-20-4121	Fluid/Air Long Plug for QC-210/310 Tool
6	4	9005-20-1515	3/8" Check Port Long Plug with Dowel

Note: Service Kit 9120-F1-T-Kit consists of (1) each of items 1, 2, & 4.
Note: Service Kit 9120-F5-T Kit consists of (1) each of items 1, 2, 3, 4, & 6.

ITEM NO.	QTY.	PART NUMBER	DESCRIPTION
1	8	3410-0001284-01	O-ring, .669OD x .047 wall, 70D, Buna-N
2	8	3700-20-4121	Fluid/Air Long Plug for QC-210/310 Tool

NOTES: UNLESS OTHERWISE SPECIFIED.

DO NOT SCALE DRAWING. ALL DIMENSIONS ARE IN MILLIMETERS.



3rd ANGLE PROJECTION



1031 Goodworth Drive, Apex, NC 27539, USA
Tel: +1.919.772.0115 Email: info@ati-ia.com
Fax: +1.919.772.8259 www.ati-ia.com
ISO 9001 Registered Company

PROPERTY OF ATI INDUSTRIAL AUTOMATION, INC. NOT TO BE REPRODUCED IN ANY MANNER EXCEPT ON ORDER OR WITH PRIOR WRITTEN AUTHORIZATION OF ATI.

DRAWN BY: D. Wagner 11/26/12		TITLE		REVISION	
CHECKED BY: DKL 11/28/12		AR4/AR5/AR7 Module Drawing			
PROJECT #	120905-1	SHEET	OF 3	SCALE	1:2
		SIZE	B	DRAWING NUMBER	9630-20-AR4
					04