

Rev.	Description	Initiator	Date
05	2X (Ø10mm Dowel Slip Fit) was (Ø10mm Dowel Press Fit)	RLR	12/22/2014

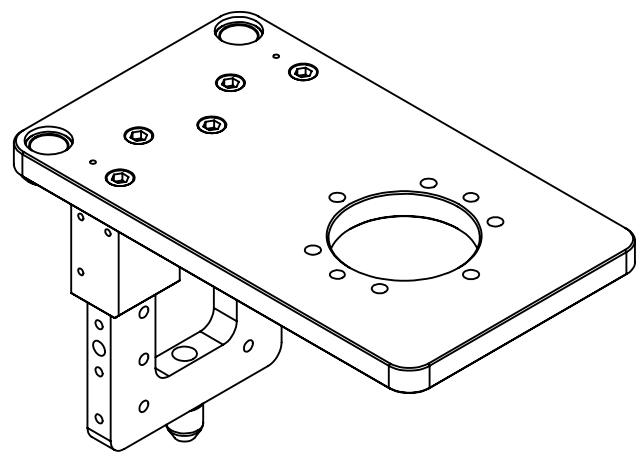

9121-210CT-DKF-AA2-EC6-0-SM
(Shown for Clarity)

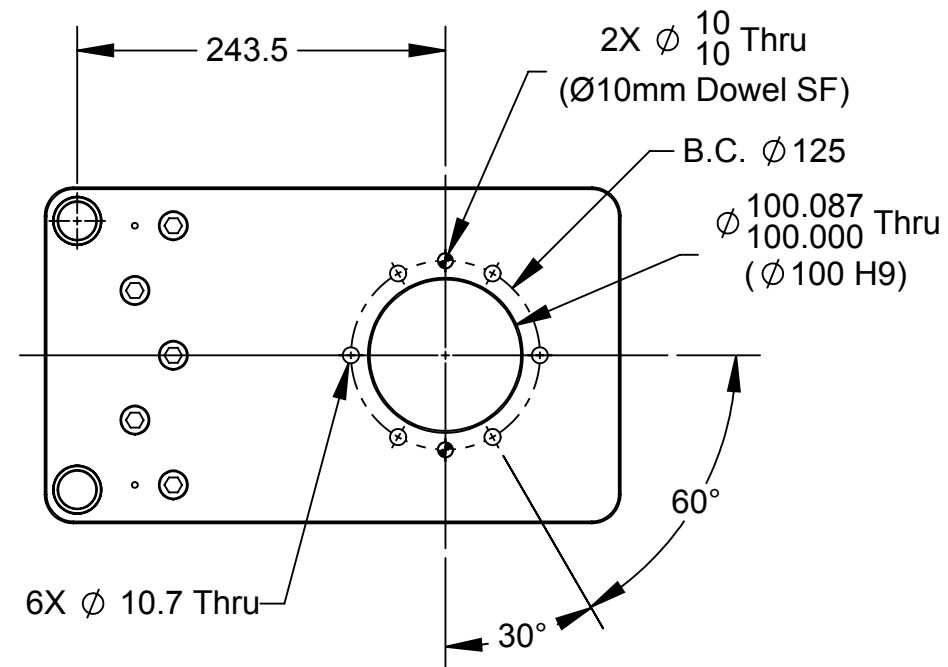
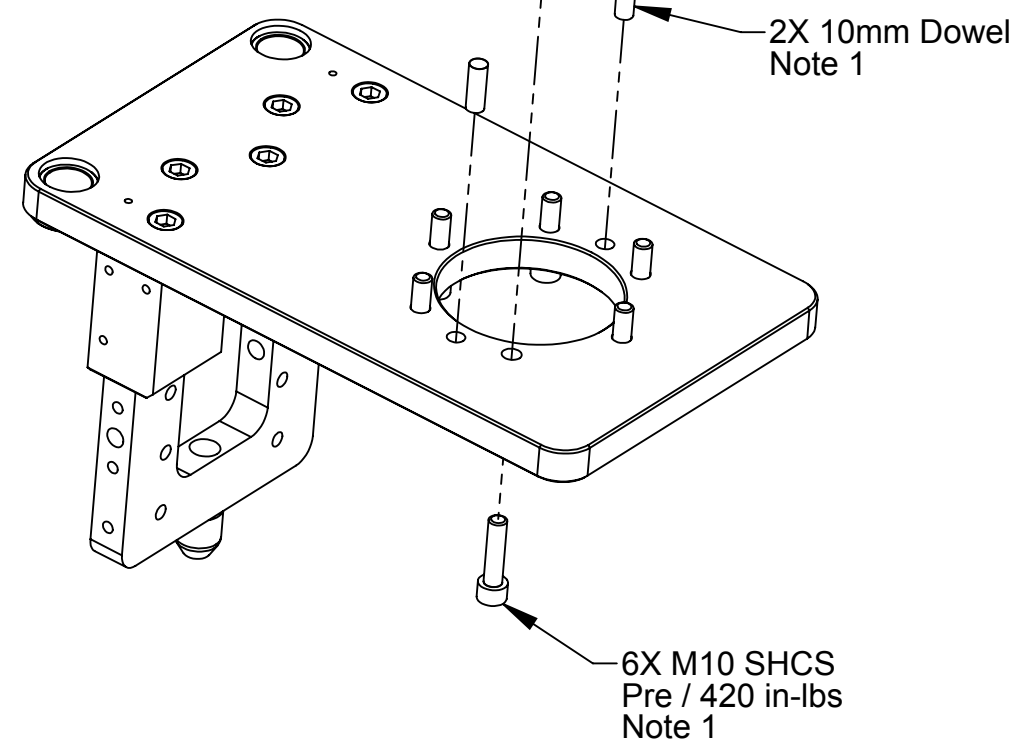
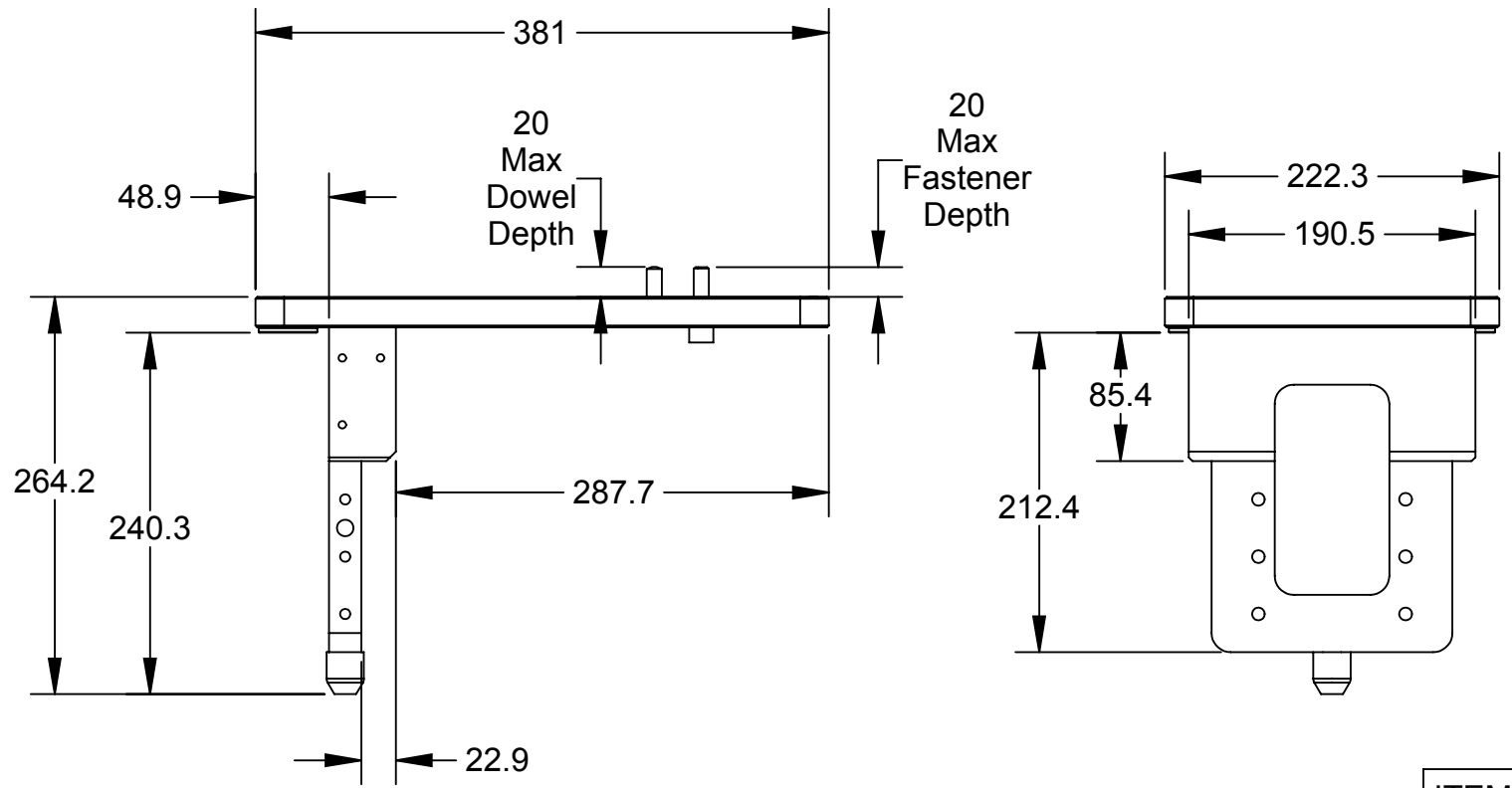
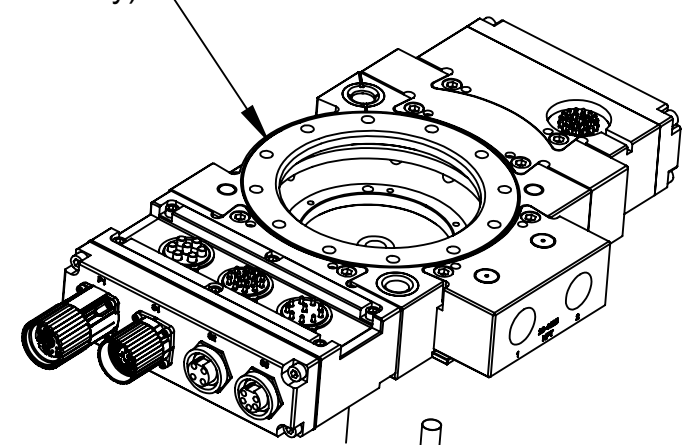

Notes:

1. Customer to provide EOAT mounting fasteners and dowels.

ITEM NO.	QTY.	PART NUMBER	DESCRIPTION
1	1	9120-TSL-HBC-9039	TSL Tooling Interface Plate for QC-210, 125mm B.C., (2) Dowel 10, (6) M10, 100mm Thru

NOTES: UNLESS OTHERWISE SPECIFIED. DO NOT SCALE DRAWING. ALL DIMENSIONS ARE IN MILLIMETERS.			1031 Goodworth Drive, Apex, NC 27539, USA Tel: +1.919.772.0115 Email: info@ati-ia.com Fax: +1.919.772.8259 www.ati-ia.com ISO 9001 Registered Company	
	DRAWN BY: R.Raines 10/31/14 CHECKED BY: J.Winterroth 11/05/14		TITLE 9120-TSL-HBC-9039 - Customer Drawing	
 3rd ANGLE PROJECTION		PROJECT # 141029-3 SHEET 1 OF 1	SCALE 1:8 SIZE B	DRAWING NUMBER 9230-20-7785 REVISION 05

PROPERTY OF ATI INDUSTRIAL AUTOMATION, INC. NOT TO BE REPRODUCED IN ANY MANNER EXCEPT ON ORDER OR WITH PRIOR WRITTEN AUTHORIZATION OF ATI.