

Rev.	Description	Initiator	Date
03	Added R19R-M callouts to pin out tables. Also added view of right angle connector.	PS	6/15/2006
04	ECO 7940 - Update connector part numbers (straight and 90°).	LDB	8/12/2010

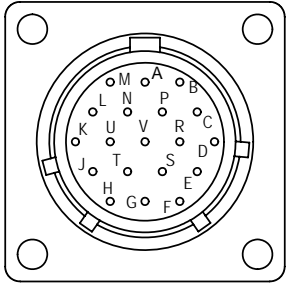

Face View Pins Master Connector
PN 1510-1413003-19 (PT02E-14-19P)

Mates:
Straight PN 1510-2412010-19 (PT06E14-19S(SR))
90° PN 1510-2412009-19 (PT08E14-19S(SR))

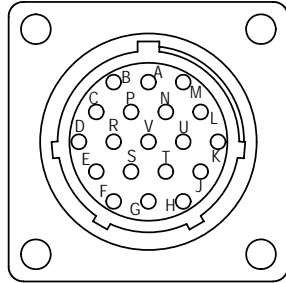

Face View Socket Tool Connector
PN 1510-2413003-19 (PT02E-14-19S)

Mates:
Straight PN 1510-1412009-19 (PT06E14-19P(SR))
90° PN 1510-1412010-19 (PT08E14-19P(SR))

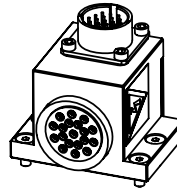

R19-M

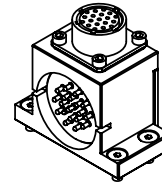

R19-T

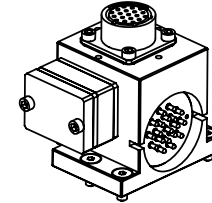

R14-T

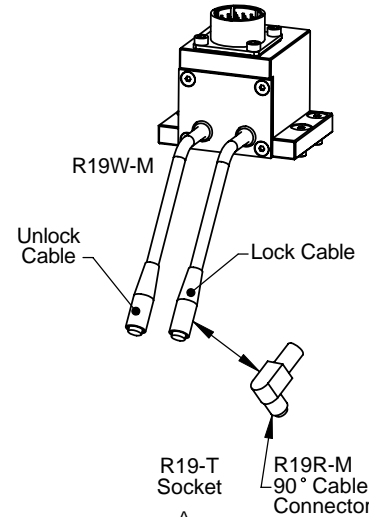

R19-M Pin	R19-T Socket	R19-M Pin	R14-T Socket	R19W-M R19R-M Pin	R14-T Socket	R19W-M R19R-M Pin	R19-T Socket	R19R-M 90° Cable Connector
A -----	A	A -----	A	A -----	A	A -----	A	A -----
B -----	B	B -----	B	B -----	B	B -----	B	B -----
C -----	C	C -----	C	C -----	C No Connect	C -----	C	C No Connect
D -----	D	D -----	D	D -----	D No Connect	D -----	D	D No Connect
E -----	E	E -----	E	E -----		E -----	E	E -----
F -----	F	F -----	F	F -----		F -----	F	F -----
G -----	G	G -----	G	G -----		G -----	G	G -----
H -----	H	H -----	H	H -----	H No Connect	H -----	H	H No Connect
J -----	J	J -----	J	J -----	J	J -----	J	J -----
K -----	K	K -----	K	K -----	K No Connect	K -----	K	K No Connect
L -----	L	L -----	L	L -----	L	L -----	L	L -----
M -----	M	M -----	M	M -----	M	M -----	M	M -----
N -----	N	N -----	N	N -----	N	N -----	N	N -----
P -----	P	P -----	P	P -----	P No Connect	P -----	P	P -----
R -----	R	R -----	R	R -----	R No Connect	R -----	R	R -----
S -----	S	S -----	S	S -----	S No Connect	S -----	S	S -----
T -----	T	T -----	T	T -----	T No Connect	T -----	T	T -----
U -----	U	U -----	U	U -----	U No Connect	U -----	U	U -----
V -----	V	V -----	V	V -----	V	V -----	V	V -----
	Ground		Ground		Ground		Ground	

Signal	Color	Pin	Socket
UnLock signal	black	C	C
10-30 VDC	brown	D	D
0 VDC	blue	H	H
Lock signal	black	K	K

Tool ID
Selector Switch
Truth Table
(10 unique settings)
Common:
50VDC @100ma
Refers to Master

Switch Position	P	S	R	T
0	0	0	0	0
1	0	0	0	1
2	0	0	1	0
3	0	0	1	1
4	0	1	0	0
5	0	1	0	1
6	0	1	1	0
7	0	1	1	1
8	1	0	0	0
9	1	0	0	1

NOTES: UNLESS OTHERWISE SPECIFIED.

DO NOT SCALE DRAWING. ALL DIMENSIONS ARE IN MILLIMETERS.



3rd ANGLE PROJECTION



1031 Goodworth Drive, Apex, NC 27539, USA
Tel: +1.919.772.0115 Email: info@ati-ia.com
Fax: +1.919.772.8259 www.ati-ia.com
ISO 9001 Registered Company

PROPERTY OF ATI INDUSTRIAL AUTOMATION, INC. NOT TO BE REPRODUCED IN ANY MANNER EXCEPT ON ORDER OR WITH PRIOR WRITTEN AUTHORIZATION OF ATI.

DRAWN BY: T. Wojcik 4/24/01		TITLE	
CHECKED BY: JHS 4/30/01		R19 Tool Module	
PROJECT # -	SHEET 1 of 1	SCALE	REVISION
		1:2	04
		SIZE	
		B	
		DRAWING NUMBER	
		9230-20-1442	