

Rev.	Description	Initiator	Date
01P	Initial Design	MJG	5/14/2009
02	Project Release. Update drawing template.	MJG	8/20/2010
03	Eco 18484; Removed Tooling Notes 1 and 2. Replaced Note 3 callouts with Note 1 callouts. Updated title block	DS	11/7/2019

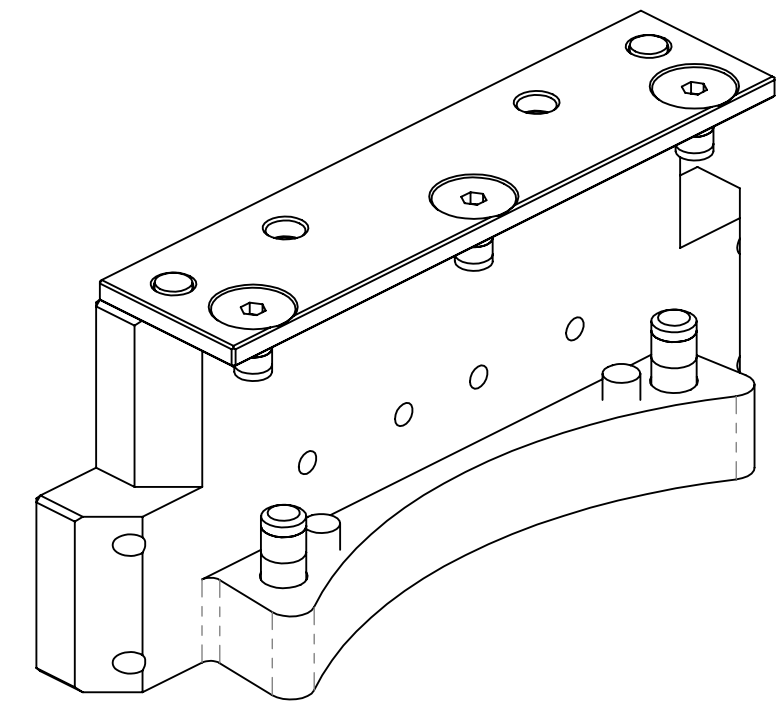
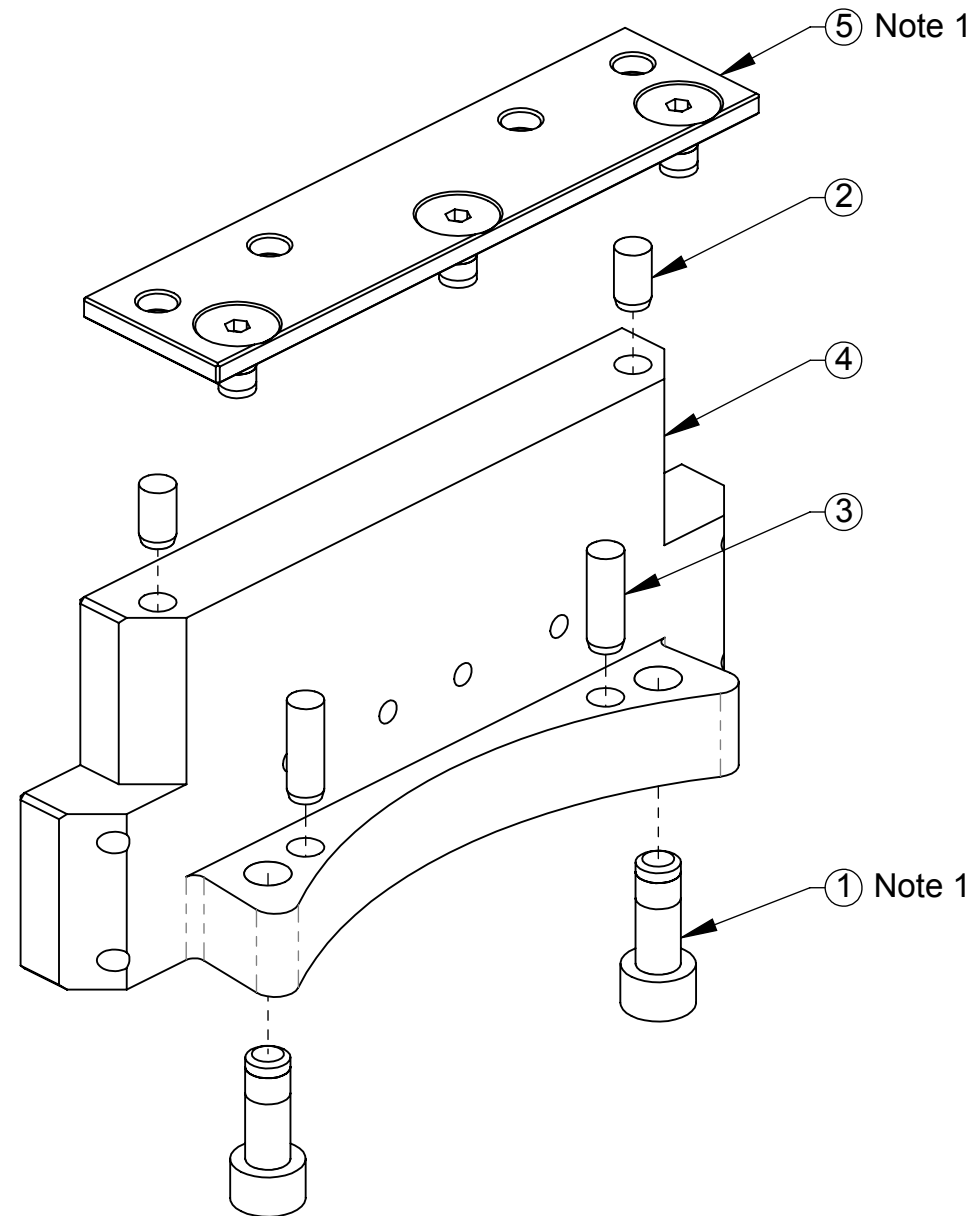

ITEM NO.	QTY	PART NUMBER	DESCRIPTION
1	2	3500-1066016-15A	M6-1 x 16mm SHCS, Blue, Pre-Applied
2	2	3540-0105010-11	5mm x 10mm Dowel Alloy Steel
3	2	3540-0105016-11	5mm x 16mm Dowel Alloy Steel
4	1	3700-20-5983	Adapter Plate, J16 (Single/Dual) to Ledge Mount, Master
5	1	9005-20-1198	Master Cleat Sub-Assembly

NOTES: UNLESS OTHERWISE SPECIFIED.

DO NOT SCALE DRAWING. ALL DIMENSIONS ARE IN INCHES.



1031 Goodworth Drive, Apex, NC 27539, USA
 Tel: +1.919.772.0115 www.ati-ia.com
 Fax: +1.919.772.8259 ISO 9001 Registered Company

PROPERTY OF ATI INDUSTRIAL AUTOMATION, INC. NOT TO BE REPRODUCED IN ANY MANNER EXCEPT ON ORDER OR WITH PRIOR WRITTEN AUTHORIZATION OF ATI.

Notes:

1. If not installing on a QC, bag all loose parts and keep with assembly.

DRAWN BY: M. Gala 5/14/09		TITLE	
CHECKED BY: D. Norton 5/15/09		JJ3 Master Adapter Assembly	
PROJECT #	080612-1	SHEET	1 OF 1
SCALE	1:1	SIZE	B
DRAWING NUMBER	9121-JJ3-M	REVISION	03