

Rev.	Description	Initiator	Date
02P	Added 9005-20-1198	KLP	12/29/2005
03	Released	BKD	6/22/2007
04	Eco 7130; Changed fastener 3500-1066020-15 to 3500-1066016-15A. Updated Notes and corrected Dowel Pin Tool part number. Show Cleat in Assembly View.	CF	5/21/2009
05	ECO 15250; Removed Tooling Notes, updated remaining Note to standard, and updated Title Block.	SZJ	3/7/2017
06	Eco 17917; Removed Master Cleat Assembly 9005-20-1198 and Dowels 3540-0105010-11 (Qty.2). Updated Note 1 "Bag Fastener Note".	CF	5/24/2019

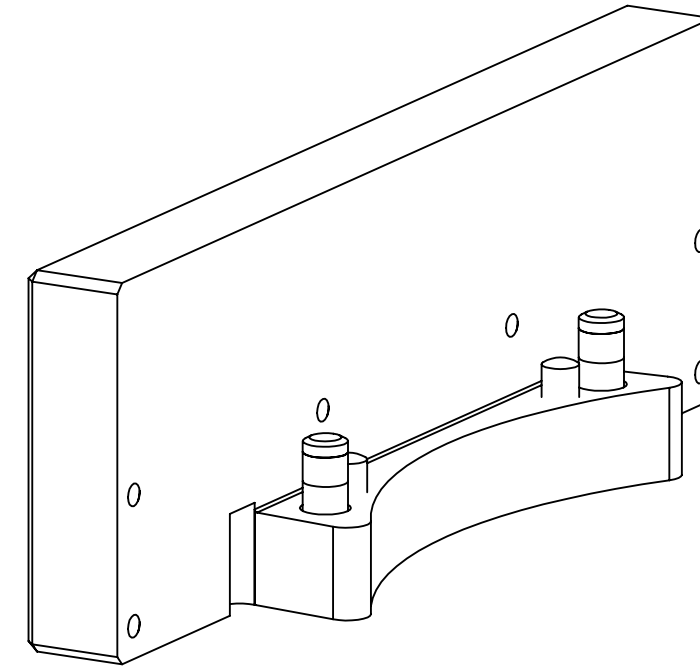
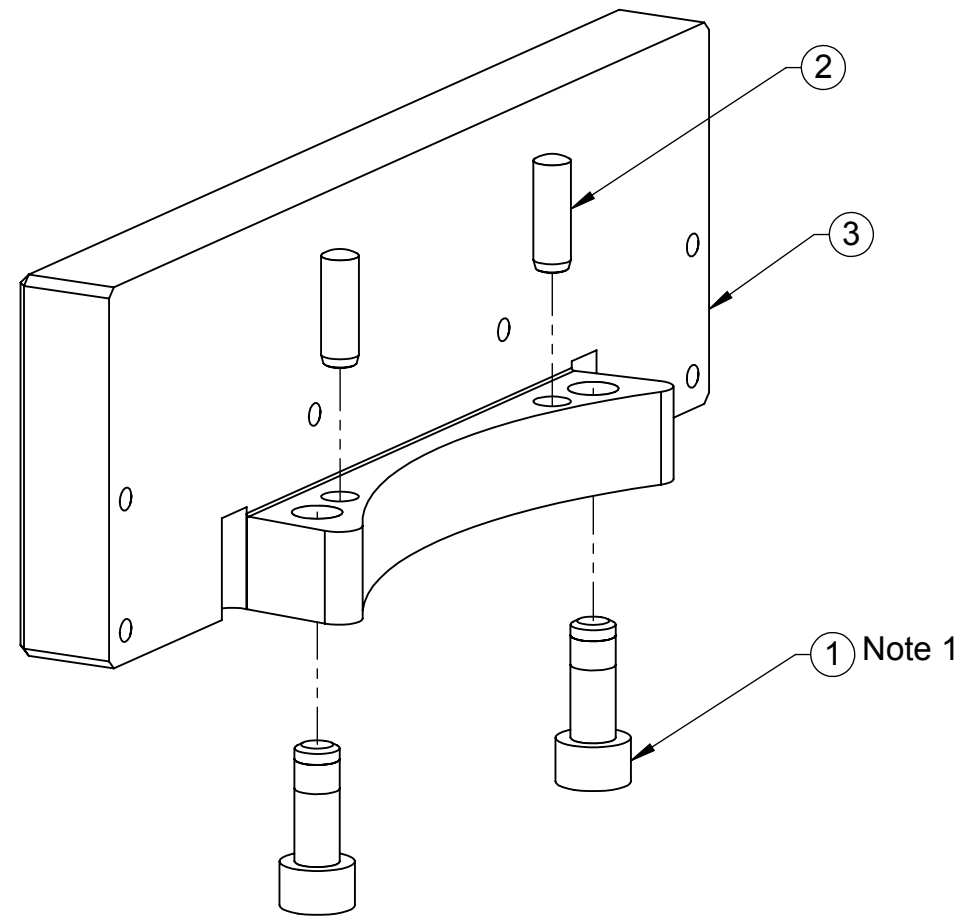

ITEM NO.	QTY	PART NUMBER	DESCRIPTION
1	2	3500-1066016-15A	M6-1 x 16mm SHCS, Blue, Pre-Applied
2	2	3540-0105016-11	5mm x 16mm Dowel Alloy Steel
3	1	3700-20-4023	Master Adapter Plate Common Ledge Mtg to J16

NOTES: UNLESS OTHERWISE SPECIFIED.

DO NOT SCALE DRAWING. ALL DIMENSIONS ARE IN INCHES.

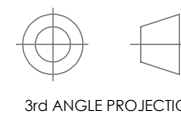

3rd ANGLE PROJECTION



1031 Goodworth Drive, Apex, NC 27539, USA
 Tel: +1.919.772.0115 www.ati-ia.com
 Fax: +1.919.772.8259 ISO 9001 Registered Company

PROPERTY OF ATI INDUSTRIAL AUTOMATION, INC. NOT TO BE REPRODUCED IN ANY MANNER EXCEPT ON ORDER OR WITH PRIOR WRITTEN AUTHORIZATION OF ATI.

DRAWN BY: R. Heavner, 3/31/05		TITLE	
CHECKED BY: B. Digeso, 4/1/05		JJ2 Master Adapter Assembly	
PROJECT #	040227-1	SHEET	1 OF 1
SCALE	1:1	SIZE	B
DRAWING NUMBER	9121-JJ2-M		REVISION
			06

Notes:
 1. If installing on QC, refer to work instructions. If placing into inventory, bag dry loose fasteners.